

REV.	DATE	DCN #	DRAWING TREE #
B	21/DEC/07	E060260-B	
C	22/JULY/08	E080372	

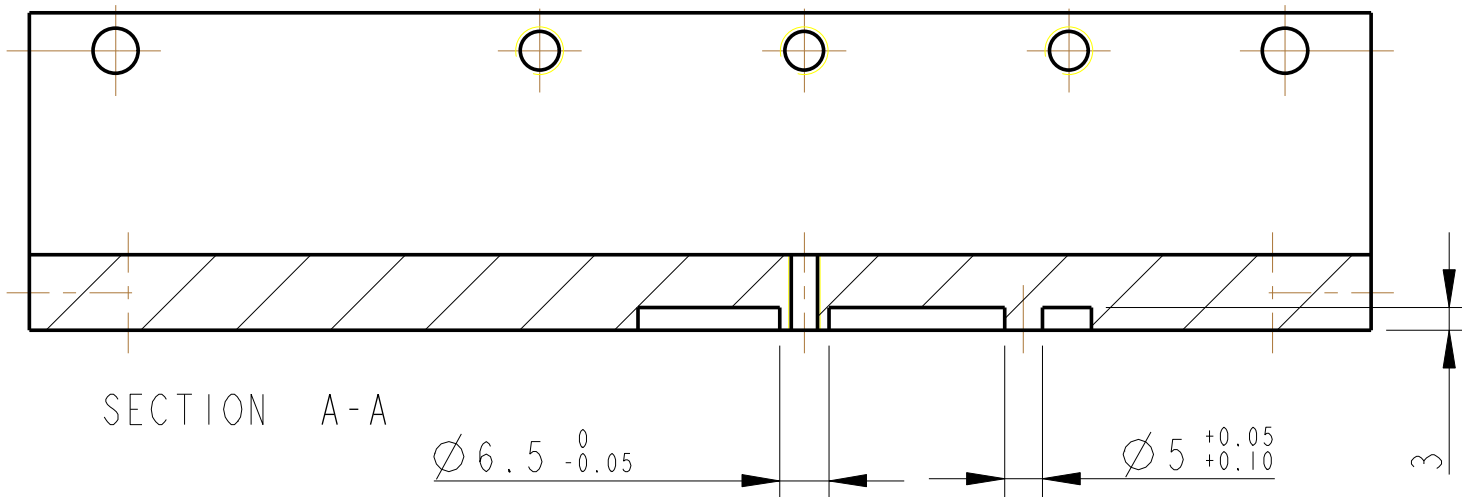

2 HOLE FOR HELICOIL 8-32 UNC THRU'.
HELICOIL NOT TO BE FITTED.

3 HOLES 8-32 UNC THRO TO
VENT HOLE, TAP 0.005" OVERSIZE

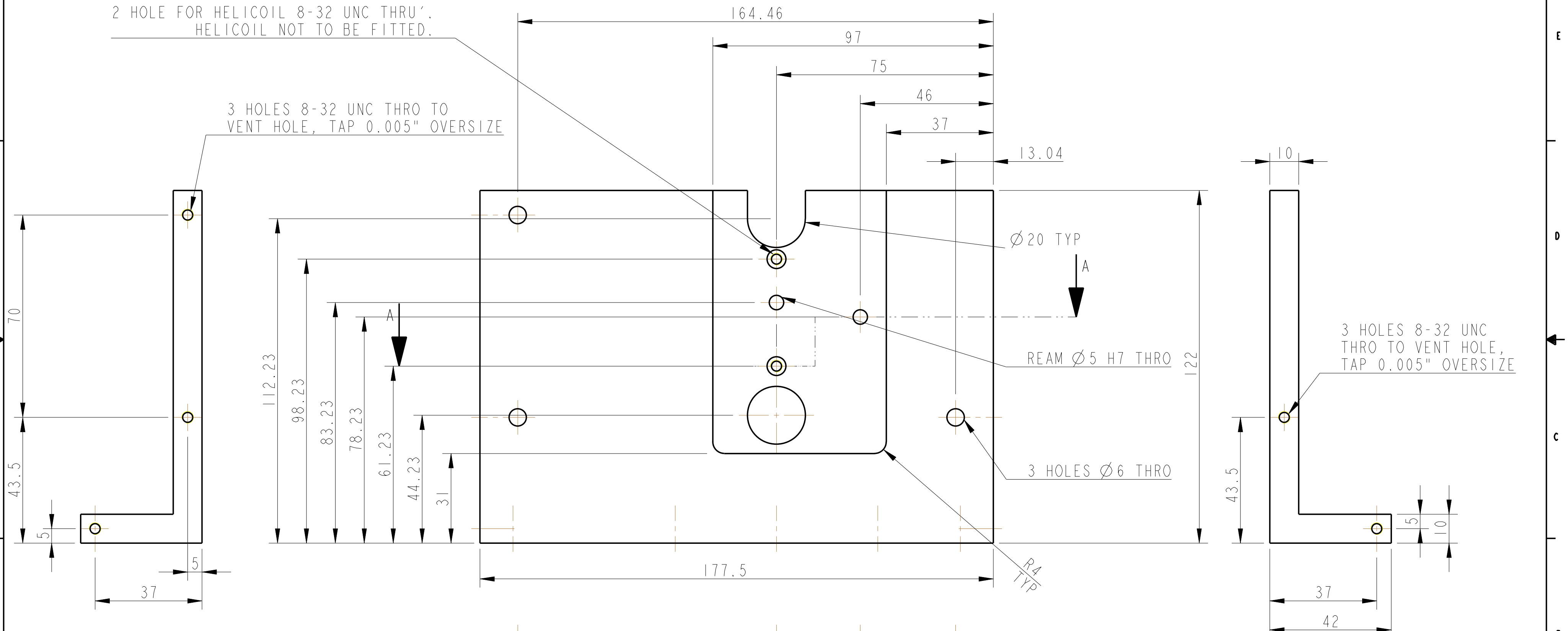

3 HOLES 8-32 UNC
THRO TO VENT HOLE,
TAP 0.005" OVERSIZE

2 HOLES Ø6 THRO

3 HOLES TAPPED
THRO FOR 1/4-20
UNC HELICOIL,
HELICOIL NOT TO
BE FITTED

NOTES: (UNLESS OTHERWISE SPECIFIED)

- REMOVE ALL SHARP EDGES, R.02 MIN.
- DO NOT SCALE FROM DRAWING.
- ALL MACHINING FLUIDS SHALL BE WATER SOLUBLE AND FREE OF SULFUR, CHLORINE AND SILICONE, SUCH AS CINCINNATI MILACRON'S CIMTECH 410 (STAINLESS STEEL)
- SCRIBE, ENGRAVE OR STAMP DRAWING PART NUMBER ON NOTED SURFACE OF PART AND A THREE DIGIT SERIAL NUMBER. SERIAL NUMBERS START AT 001 FOR THE FIRST PART AND PROCEED CONSECUTIVELY. USE .07" HIGH CHARACTERS. EXAMPLE: D020188-001. A VIBRATORY TOOL MAY BE USED.

DIMENSIONS ARE IN mm (INCHES)
ANGULAR ±0.25°
X.XX ± mm (INCHES)
FINISH: CLEAN AND DEGREASED
√μm (μin) Ra = 1.6

MATERIAL: AL ALLOY 6061

SCALE 1:1 PROJECTION: SHEET 1 OF 1

DRWN	I WILMUT	29/NOV/07
CHECKED	AJB	19MAY08
APPROVED	AJB	22/JULY/08

CALIFORNIA INSTITUTE OF TECHNOLOGY
MASSACHUSETTS INSTITUTE OF TECHNOLOGY
1GR, GLASGOW UNIVERSITY GEO 600 GROUP
RUTHERFORD APPLETON LABORATORIES

SYSTEM: **ADVANCED LIGO**
SUB-SYSTEM: **SUS**
NEXT ASSY: **D060454**
PART NAME: **TEST CHAIN UIM STOP**
RIGHT HAND

DRG. NO. **D070544**