

REV.	DATE	DCN #	DRAWING TREE #

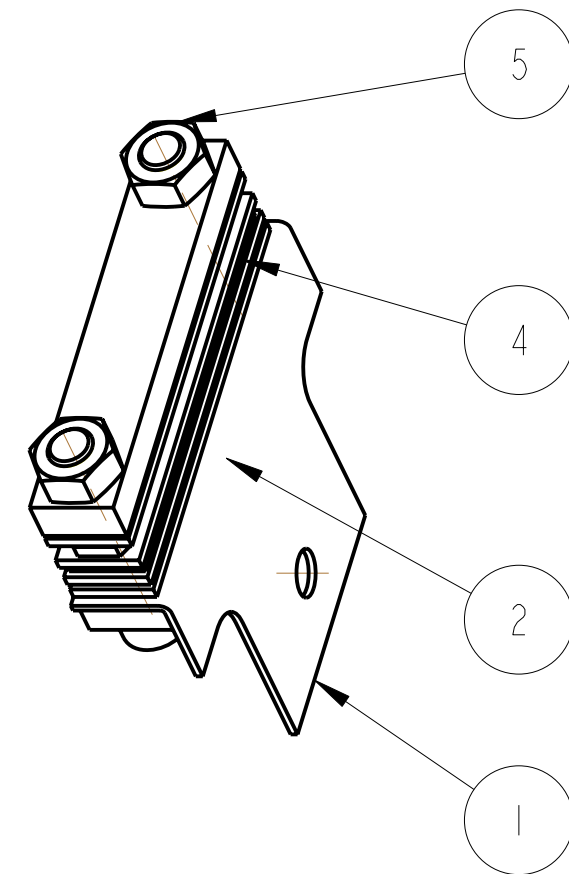
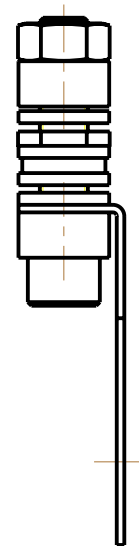
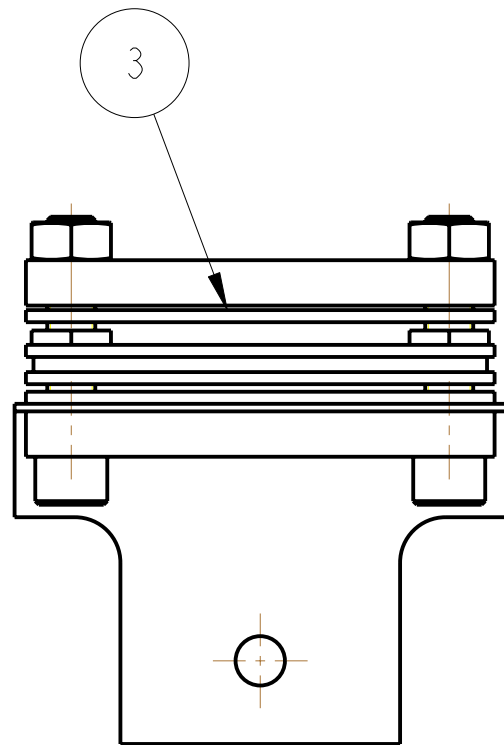
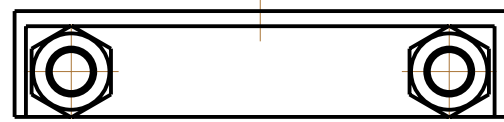

ITEM	QTY	SPARE	TOTAL	PART NUMBER	DESCRIPTION	MATERIALS
1	1			D070223	PEN RE MASS WIRE CLAMP; .	AL ALLOY: 5083 OR SIMILAR
2	2			D070226	CABLE CLAMP JAW; .	AL ALLOY: 5083 OR SIMILAR
3	1			D1001512	FLOUREL CABLE CLAMP PADS; .	-----: AS DRW
4	2				1/4" 20 UNC X 1.25" CAP HEAD; .	
5	2				1/4 20 UNC NUT; .	

PARTS LIST

NOTES: (UNLESS OTHERWISE SPECIFIED)

- REMOVE ALL SHARP EDGES, R.02 MIN.
- DO NOT SCALE FROM DRAWING.
- ALL MACHINING FLUIDS SHALL BE WATER SOLUBLE AND FREE OF SULFUR, CHLORINE AND SILICONE, SUCH AS CINCINNATI MILACRON'S CIMTECH 410 (STAINLESS STEEL)
- SCRIBE, ENGRAVE OR STAMP DRAWING PARTNUMBER ON NOTED SURFACE OF PART AND A THREE DIGIT SERIAL NUMBER. SERIAL NUMBERS START AT 001 FOR THE FIRST PART AND PROCEED CONSECUTIVELY. USE .07" HIGH CHARACTERS. EXAMPLE: D020188- 001. A VIBRATORY TOOL MAY BE USED.

DIMENSIONS ARE IN mm [INCHES]  
TOLERANCES:  
X.XX ±N/A mm  
ANGULAR ±N/A °

MATERIAL: AS DRW  
FINISH: -----  
√μm [μin] Ra = -----

NAME	DATE
DRAWN	14/Jun/07
CHECKED	15/MAR/10
APPROVED	15/MAR/10

CALIFORNIA INSTITUTE OF TECHNOLOGY  
MASSACHUSETTS INSTITUTE OF TECHNOLOGY  
1GR, GLASGOW UNIVERSITY GEO 600 GROUP  
RUTHERFORD APPLETON LABORATORIES

SYSTEM **aLIGO**  
SUB-SYSTEM **SUS**  
NEXT ASSY **QUAD WIRING HARNESS**  
PART NAME **PEN RE MASS CABLE CLAMP**

SIZE **B** DRG. NO. **D070222** REV **C.**  
SCALE 1:1 PROJECTION: SHEET 1 OF 1