

FIRST ANGLE PROJECTION

REV.	DATE	DCN #	DRAWING TREE #

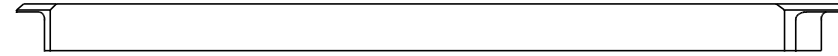

5mm x 4mm CHAMFER TYP

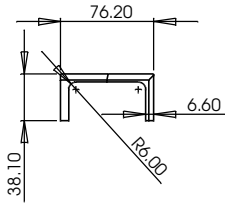
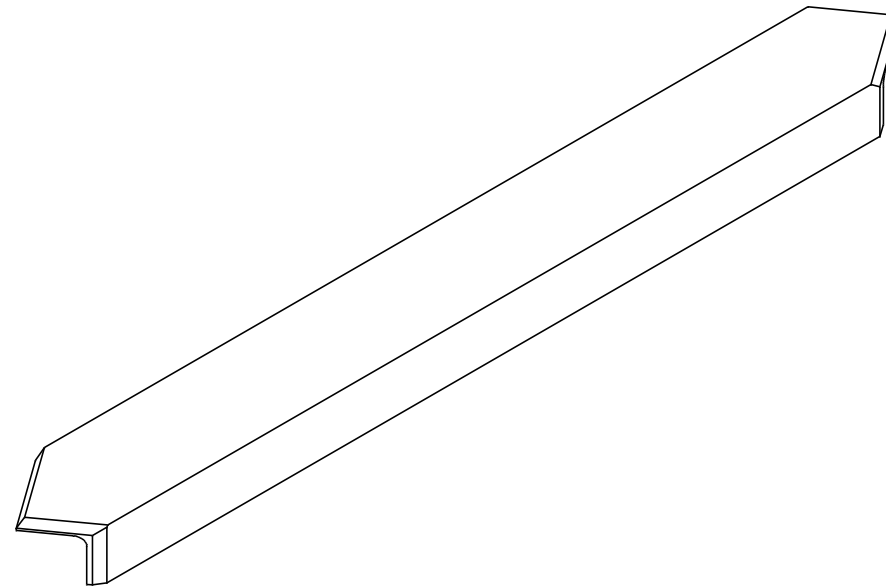
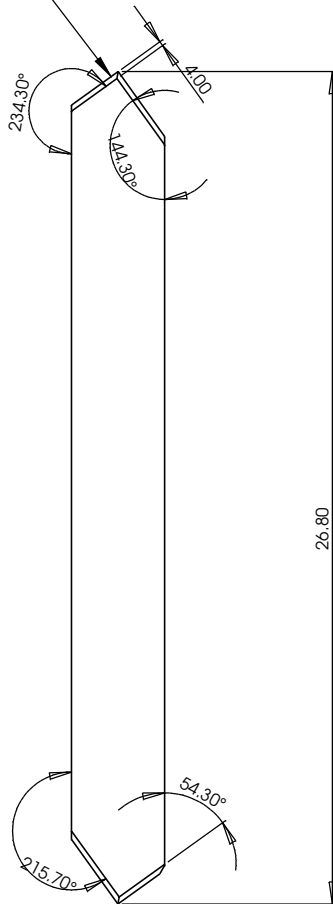

ITEM No 5

NOTES: (UNLESS OTHERWISE SPECIFIED)		PARTS LIST	
1. DO NOT SCALE FROM DRAWING.	2. REMOVE ALL SHARP EDGES, R.02 MAX.	3. ALL MACHINING FLUIDS SHALL BE WATER SOLUBLE AND FREE OF SULFUR, CHLORINE AND SILICONE.	4. DIMENSIONS ARE IN INCHES
5. SCRIBE, ENGRAVE OR MECHANICALLY STAMP DRAWING (NO INKS OR DYES) PART NUMBER, REVISION, OR NOTED SURFACE OF PART FOLLOWED ON THE NEXT LINE WITH A THREE DOT SERIAL NUMBER. SERIAL NUMBERS START AT 001 FOR THE FIRST ARTICLE AND PROCEED CONSECUTIVELY. USE 12" HIGH CHARACTERS, UNLESS THE SIZE OF THE PART DICTATES SMALL CHARACTERS. A VIBRATORY TOOL MAY BE USED. EXAMPLE: 0 5 0 2 4 7 -A S/N 001	6. TOLERANCES: .XX ± 0.01 .XXX ± 0.005 ANGULAR ± 0.1°	7. MATERIAL: ALUMINIUM ALLOY 6082	8. FINISH: CLEAN
9. CALIFORNIA INSTITUTE OF TECHNOLOGY LIGO MASSACHUSETTS INSTITUTE OF TECHNOLOGY IGR, GLASGOW UNIVERSITY GEO 605 GROUP		10. PART NAME: ANGLE RSJ	
11. DRAWN: AXB	12. DATE: 27-10-06	13. SIZE: C	14. DWG. NO: NTE UPPER 005
15. CHECKED:	16. APPROVED:	17. SCALE: 1:2	18. PROJECTION: FIRST ANGLE
19. SHEET 01		20. REV:	