

REV.	DATE	DCN #	DRAWING TREE #
A	30-OCT-06	E060260-00	.
B	21/DEC/07	E060260-B	.
C	22/JULY/08	E080372	

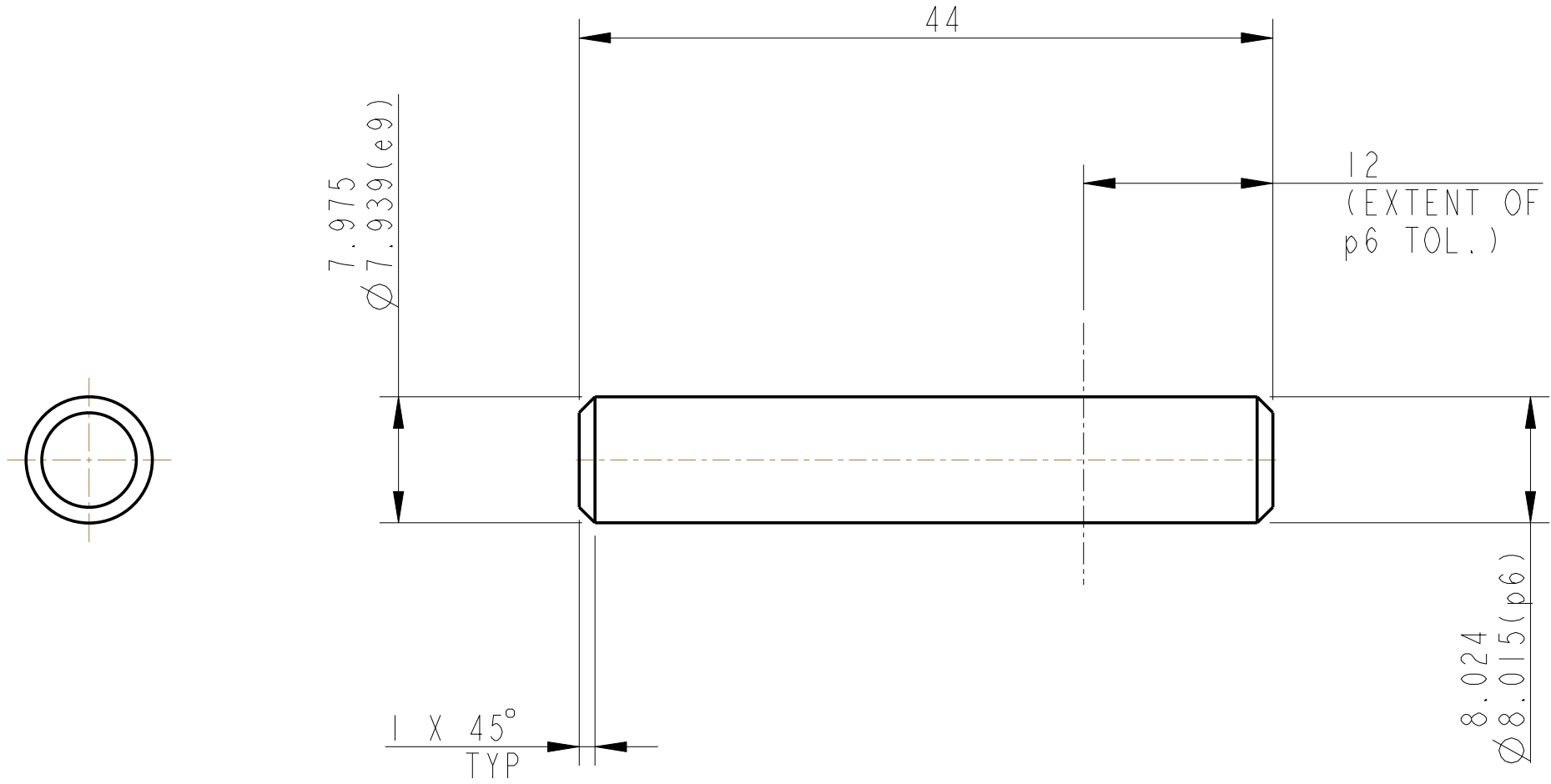

NOTES: (UNLESS OTHERWISE SPECIFIED)		
1. REMOVE ALL SHARP EDGES, R.02 MIN. 2. DO NOT SCALE FROM DRAWING. 3. ALL MACHINING FLUIDS SHALL BE WATER SOLUBLE AND FREE OF SULFUR, CHLORINE AND SILICONE, SUCH AS CINCINNATI MILACRON'S CIMTECH 410 (STAINLESS STEEL) 4. SCRIBE, ENGRAVE OR STAMP DRAWING PARTNUMBER ON NOTED SURFACE OF PART AND A THREE DIGIT SERIAL NUMBER. SERIAL NUMBERS START AT 001 FOR THE FIRST PART AND PROCEED CONSECUTIVELY. USE .07" HIGH CHARACTERS. EXAMPLE: D020188- 001. A VIBRATORY TOOL MAY BE USED.		
DIMENSIONS ARE IN mm [INCHES]		
TOLERANCES:		
X.XX $\pm 0.2$ mm		
ANGULAR $\pm 0.25^\circ$		
MATERIAL: ST. STEEL 304/316		
FINISH: CLEAN $R_a = 1.6$		
	NAME	DATE
DRAWN	NJS/FEL	21/07/06
CHECKED	AJB	11JUNE08
APPROVED	AJB	22/JULY/08

CALIFORNIA INSTITUTE OF TECHNOLOGY MASSACHUSETTS INSTITUTE OF TECHNOLOGY 1GR, GLASGOW UNIVERSITY GEO 600 GROUP RUTHERFORD APPLETON LABORATORIES	
SYSTEM	<b>ADVANCED LIGO</b>
SUB-SYSTEM	<b>SUS</b>
NEXT ASSY	<b>QUAD N-PTYPE LOWER STRUCTURE</b>
PART NAME	<b>PIN (ADJUSTABLE PAD ASSYS)</b>
SIZE	<b>A</b>
DRG. NO.	<b>D060448</b>
SCALE	5:2
PROJECTION:	
SHEET	1 OF 1

REV  
**C.**