

REV.	DATE	DCN #	DRAWING TREE #
A	30-OCT-06	E060260-00	

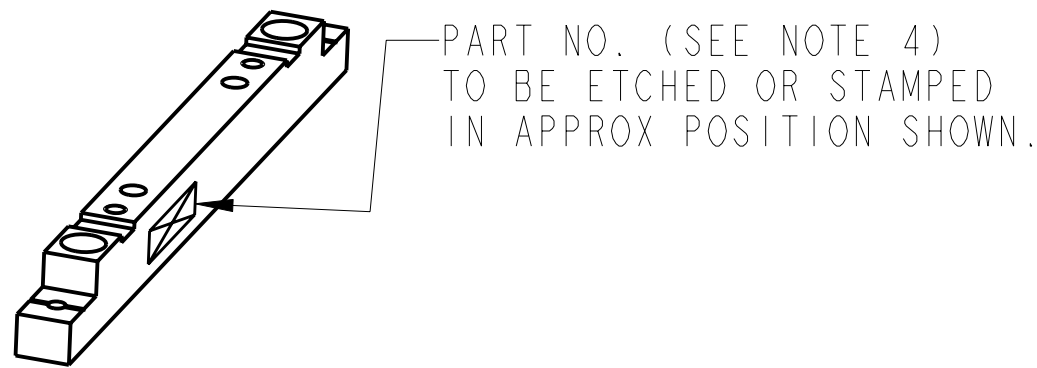
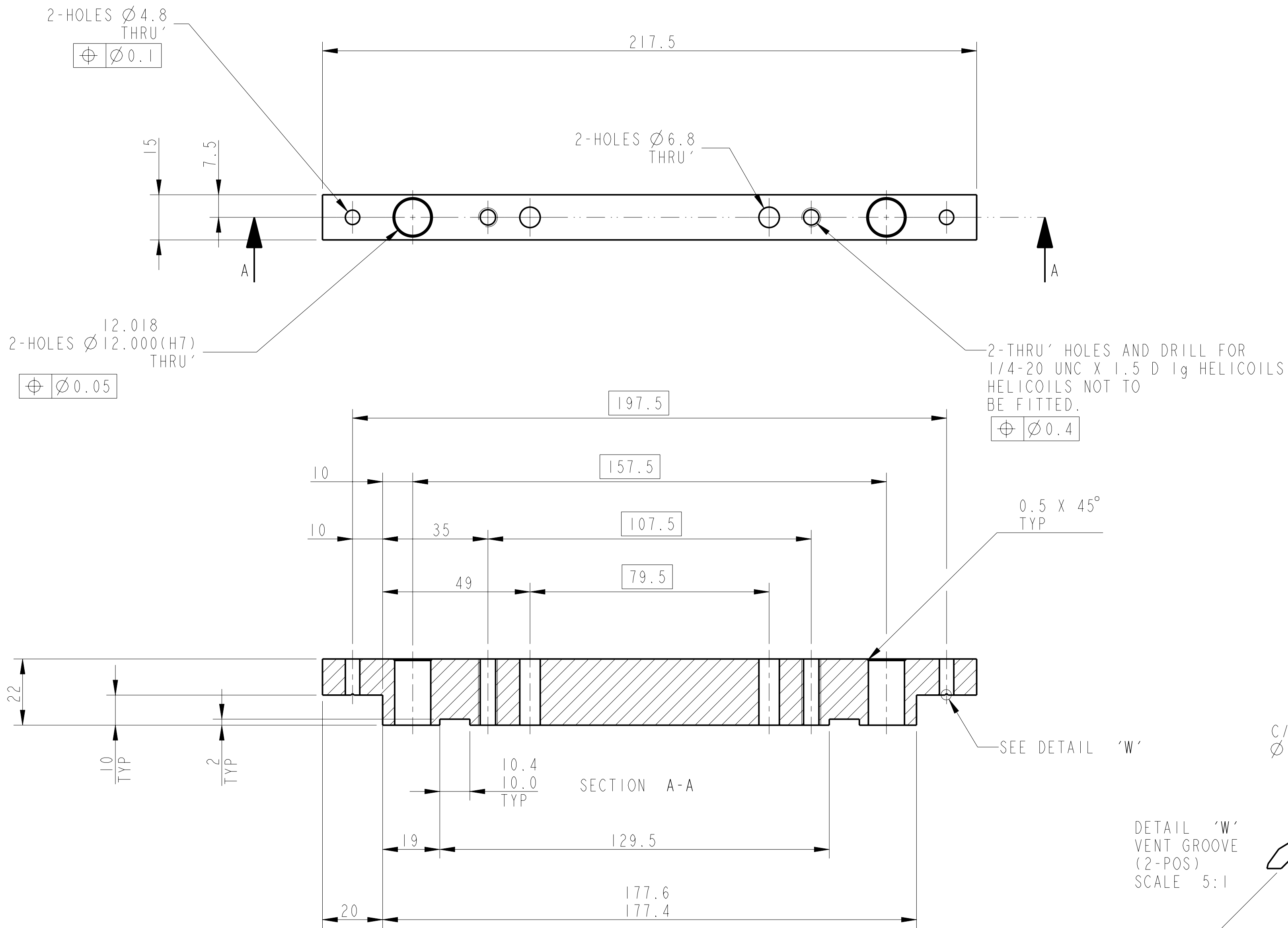

NOTES: (UNLESS OTHERWISE SPECIFIED)

- REMOVE ALL SHARP EDGES, R.02 MIN.
- DO NOT SCALE FROM DRAWING.
- ALL MACHINING FLUIDS SHALL BE WATER SOLUBLE AND FREE OF SULFUR, CHLORINE AND SILICONE, SUCH AS CINCINNATI MILACRON'S CIMTECH 410 (STAINLESS STEEL).
- SCRIBE, ENGRAVE OR STAMP DRAWING PART NUMBER ON NOTED SURFACE OF PART AND A THREE DIGIT SERIAL NUMBER. SERIAL NUMBERS START AT 001 FOR THE FIRST PART AND PROCEED CONSECUTIVELY. USE .07" HIGH CHARACTERS. EXAMPLE: D020188-001. A VIBRATORY TOOL MAY BE USED.

DIMENSIONS ARE IN mm [INCHES]		TOLERANCES:	
X.XX ± mm [INCHES]		ANGULAR ±0.25°	
MATERIAL:	AL. ALLOY	5083 H4 or 6061	
FINISH:	CLEAN	Ra = 1.6	
DRAWN	NJS/FEL	DATE	15/AUG/06
CHECKED	J'OD	DATE	--/--/--
APPROVED	IW	DATE	--/--/--

CALIFORNIA INSTITUTE OF TECHNOLOGY MASSACHUSETTS INSTITUTE OF TECHNOLOGY GLASGOW UNIVERSITY GEO 600 GROUP RUTHERFORD APPLETON LABORATORIES	
SYSTEM	ADVANCED LIGO
SUB-SYSTEM	SUS
NEXT ASSY	QUAD N-PTYPE LOWER STRUCTURE
PART NAME	BASE BAR - LONG
DRG. NO.	(ADJUSTABLE STOP MECHANISM)
DRG. NO.	D060444
SCALE	1:1 PROJECTION
SHEET	1 OF 1