

REV.	DATE	DCN #	DRAWING TREE #
A	18/OCT/06	E060247	.
B	19/DEC/07	E060247-B	.
H	21/JULY/08	E080371	.

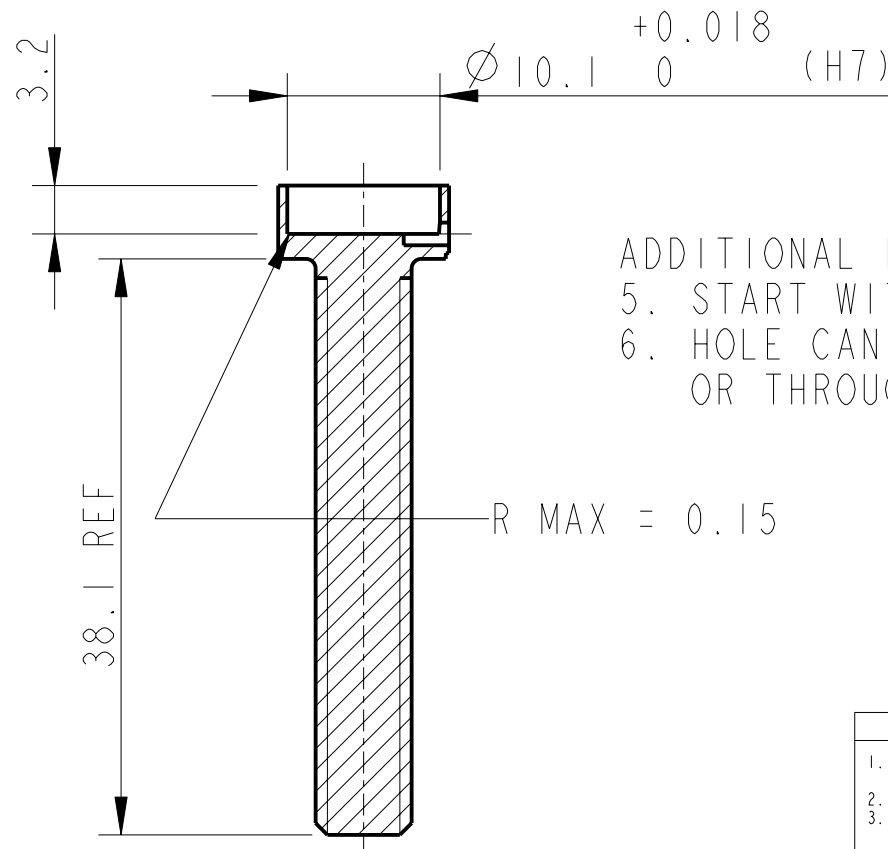
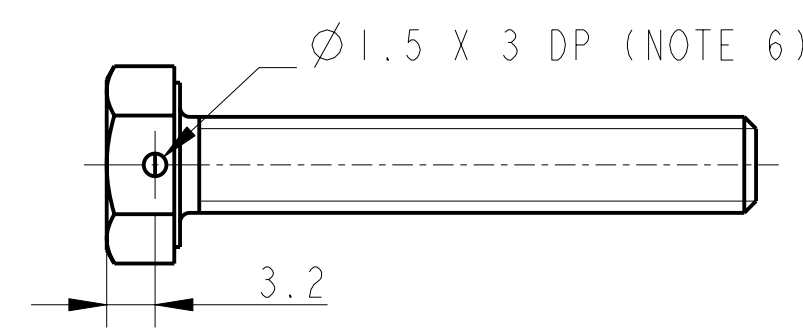
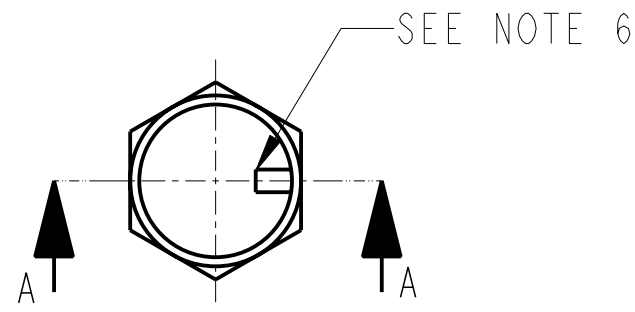

ADDITIONAL NOTES:  
 5. START WITH A 1/4-20 UNC X 1.5" HEX HEAD BOLT  
 6. HOLE CAN BE EITHER FLAT BOTTOMED OR TO DRILL POINT OR THROUGH BOLT AXIS Ø 1.5

SECTION A-A

NOTES: (UNLESS OTHERWISE SPECIFIED)		CALIFORNIA INSTITUTE OF TECHNOLOGY MASSACHUSETTS INSTITUTE OF TECHNOLOGY IGR, GLASGOW UNIVERSITY GEO 600 GROUP RUTHERFORD APPLETON LABORATORIES	
1. REMOVE ALL SHARP EDGES, R.02 MIN. 2. DO NOT SCALE FROM DRAWING. 3. ALL MACHINING FLUIDS SHALL BE WATER SOLUBLE AND FREE OF SULFUR, CHLORINE AND SILICONE, SUCH AS CINCINNATI MILACRON'S CIMTECH 410 (STAINLESS STEEL) 4. SCRIBE, ENGRAVE OR STAMP DRAWING PARTNUMBER ON NOTED SURFACE OF PART AND A THREE DIGIT SERIAL NUMBER. SERIAL NUMBERS START AT 001 FOR THE FIRST PART AND PROCEED CONSECUTIVELY. USE .07" HIGH CHARACTERS. EXAMPLE: D020188- 001. A VIBRATORY TOOL MAY BE USED.	DIMENSIONS ARE IN mm [INCHES]		SYSTEM <b>ADVANCED LIGO</b> SUB-SYSTEM <b>SUS</b> NEXT ASSY <b>QUAD N-PTYPE UI MASS</b> PART NAME <b>MAGNET RETAINER</b> (MODIFIED 1/4-20 HEX HEAD SCREW 15" LONG)
	TOLERANCES:		
	X.XX ±0.2 mm ANGULAR ±0.25°		
	MATERIAL: STAINLESS STEEL 316		
	FINISH: CLEAN AND DEGREASED √μm [μin] Ra = 1.6		
	NAME	DATE	SIZE
	DRAWN I WILMUT	10/AUG/06	A
	CHECKED AJB	11JUNE08	DRG. NO.
	APPROVED AJB	21/JULY/08	D060392
		SCALE 2:1	PROJECTION:
		SHEET 1 OF 1	