

REV.	DATE	DCN #	DRAWING TREE #
A	18/OCT/06	E060247	
B	19/DEC/07	E060247-B	
H	21/JULY/08	E060371	

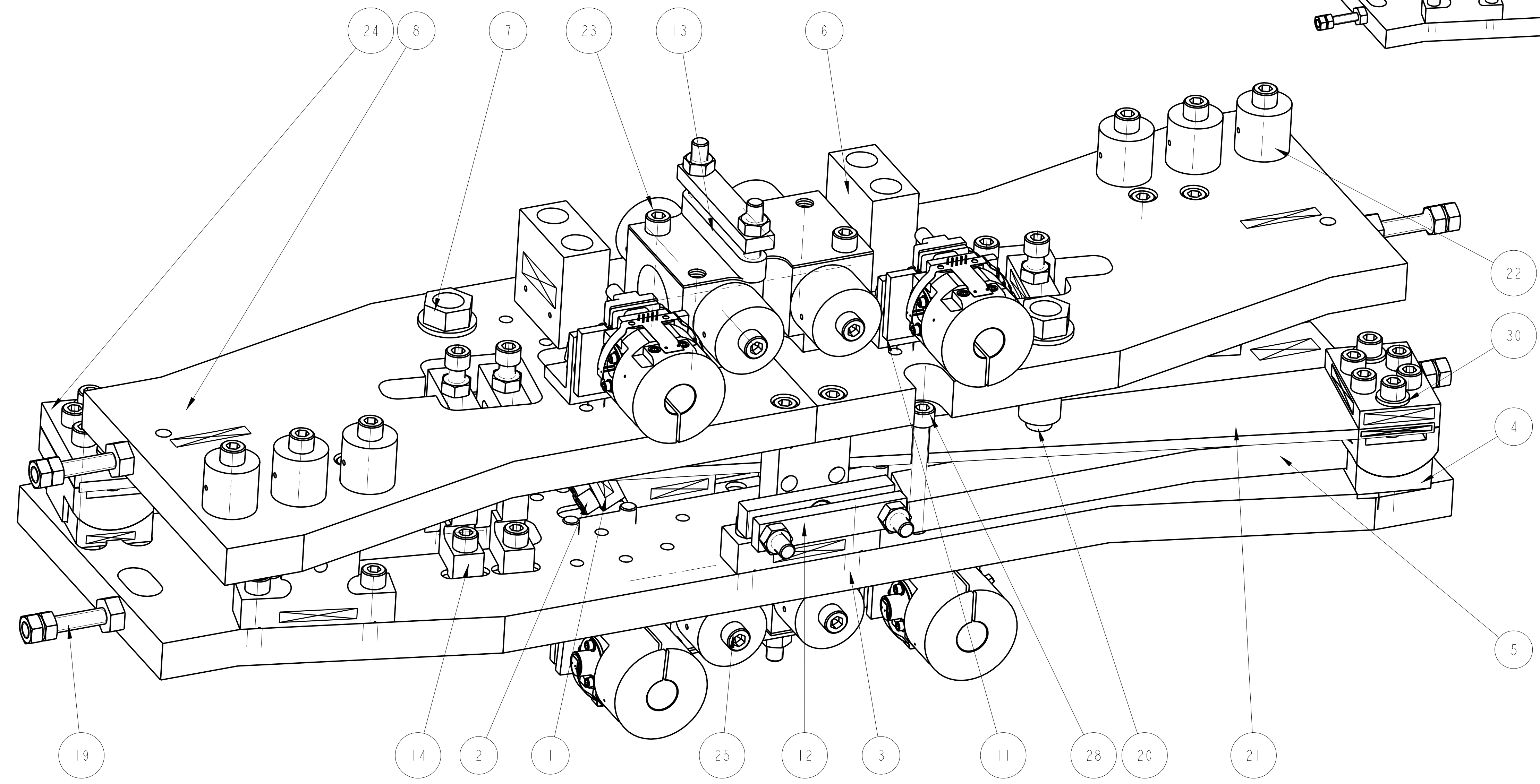
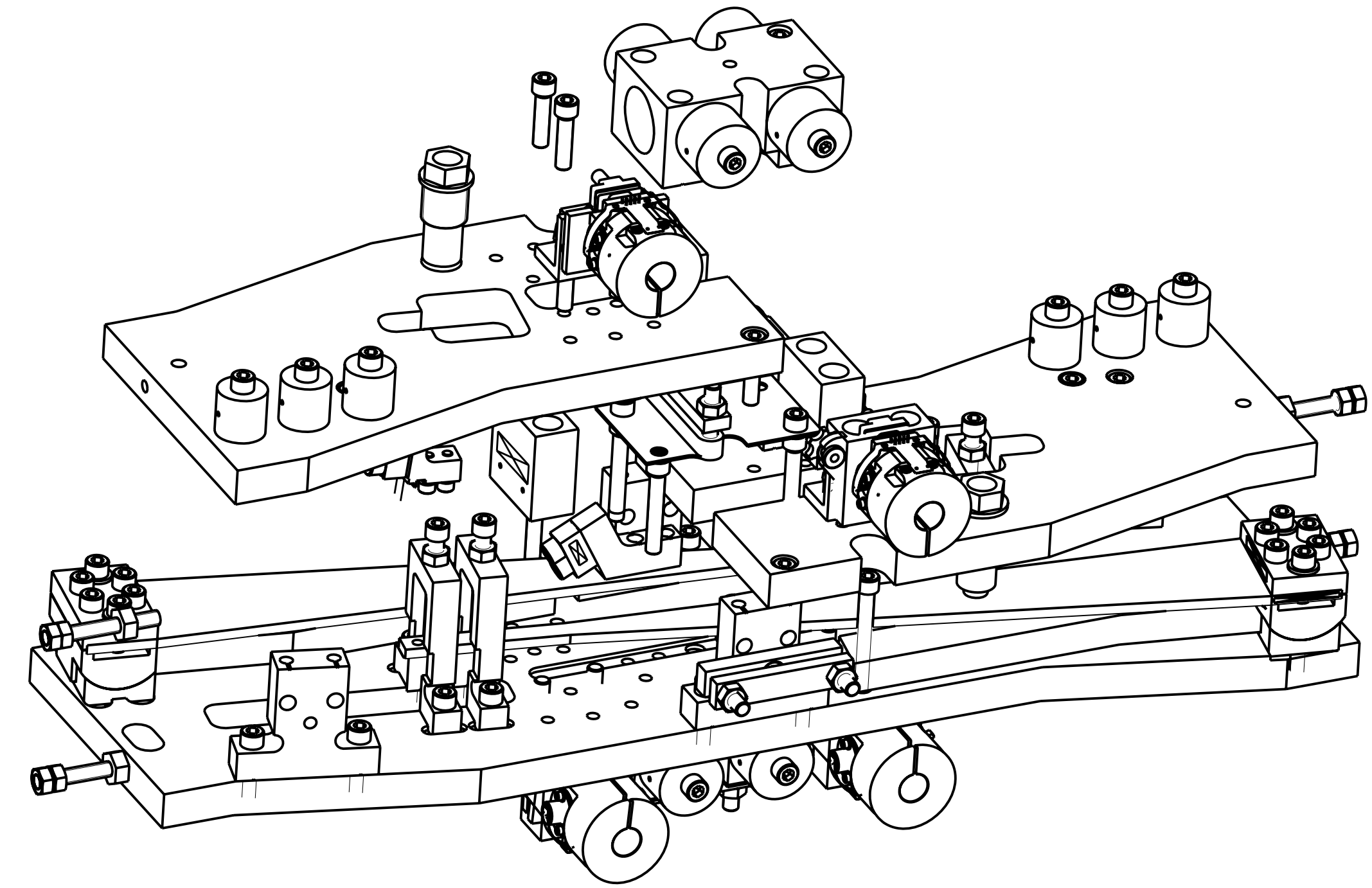
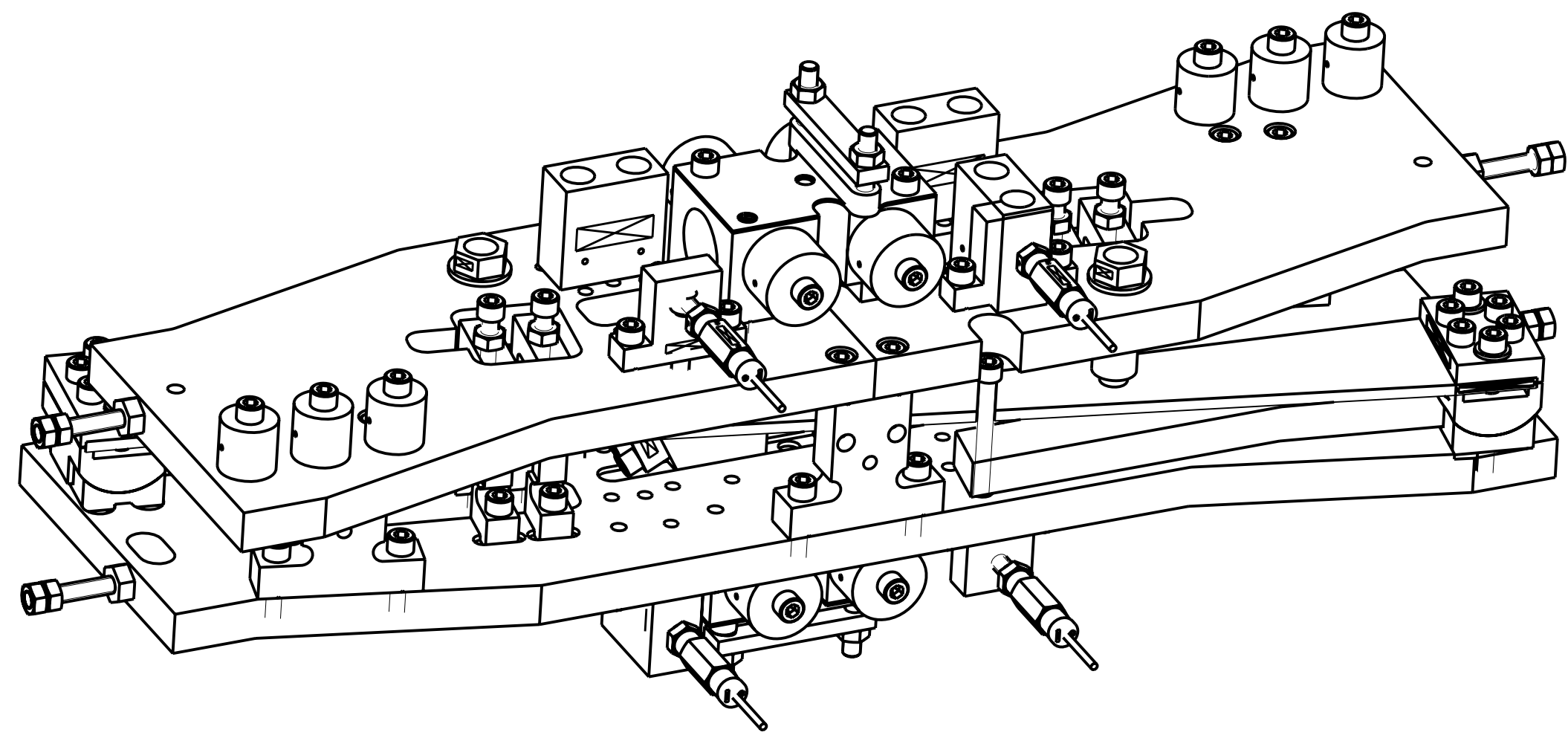

SCALE 1:1

ITEM	QTY	SPARE	TOTAL	PART NUMBER	DESCRIPTION	MATERIALS
1	2			000034	WIRE CLAMP JAW, ALL MASSES	ST STEEL: 304/316
2	4			000030	RECESSED 1/4" 20 UNC. X 0.75" CAP HEAD	ST STEEL: 304/316
3	1			000037A	MASS BASE PLATE:	ST STEEL: 304/316
4	2			000077	BLADE TIP 2 POSITION ADJ.: (8TW HALF PART 2)	AL ALLOY: 5083 OR 6061
5	2			000078	BLADE TIP 2 POSITION ADJ.: (8TW HALF)	ST STEEL: 304/316
6	8			000079	COEM AND FLAG COUNTERWEIGHT: (8TW MASS)	ST STEEL: 304/316
7	2			000080	(S1) MASS BLADE ECO:	OFHC COPPER:
8	2			000082	(S1) MASS TOP PLATE:	ST STEEL: 304/316
9	2			000083	(S1) MASS COEM WIRE CLAMP: CLAMP BODY	ST STEEL: 304/316
10	4			000085	(S1) MASS FLAG MOUNT:	SEE ITEMS LIST:
11	4			000087	(S1) MASS COEM MOUNT:	SEE ITEMS LIST:
12	4			000097	TOP MASS SPACER:	ST STEEL: 304
13	2			000098	PITCH ADJUSTER & MASS: ADJUSTER TURNET	AL ALLOY: 5083
14	4			000099	STOP BRIDGE:	AL ALLOY: 5083
15	2			000402	(S1) MASS WIRE CLAMP:	AS DRW: SEE DRAWINGS
16	1			001018	MASS WIRE CLAMP #1:	AS DRW:
17	1			001021	SLIM MASS TOP WIRE CLAMP:	AS DRW:
18	1			001023	MASS WIRE CLAMP:	AS DRW:
19	4			001058	SLIM C-CHANNEL STOP:	ST STEEL: 304/316
20	2			000134	(10MM DIA X 10MM MAGNET):	AS PAR SPEC:
21	2			000027-PL147	BOTTOM BLADE SPRINGS:	MARAGING STEEL 250:
22	6			000039-05A-L	ADDITIONAL MASS:	ST STEEL: 316
23	8			000039-10A-L	ADDITIONAL MASS:	ST STEEL: 316
24	2			000030-008	BLADE CLAMP: (1 TOP HALF)	ST STEEL: 304
25	62				1/4" 20 UNC X 1" CAP HEAD:	ST STEEL 316
26	8				1/4" 20 UNC X 1.5" CAP HEAD:	ST STEEL 316
27	8				1/4" 20 UNC X 2" CAP HEAD:	ST STEEL 316
28	6				1/4" 20 UNC X 2" CAP HEAD, SPHERICAL TYP:	ST STEEL 316
29	12				1/4" 20 UNC NUT:	ST STEEL 316
30	4				1/4" SPHERICAL WASHER:	ST STEEL 316

NOTES: (UNLESS OTHERWISE SPECIFIED)

- REMOVE ALL SHARP EDGES.
- DO NOT SCALE FROM DRAWING.
- ALL MACHINING FLUIDS SHALL BE WATER SOLUBLE AND FREE OF SULFUR, CHLORINE AND SILICONE. SUCH AS CINCINATI MICROFIL'S CMTTECH 410 (STAINLESS STEEL).
- SCORE, ENGRAVE OR STAMP DRAWING PART NUMBER ON NOTED SURFACE OF PART AND A THREE DIGIT SERIAL NUMBER. SERIAL NUMBERS START AT 001 FOR THE FIRST PART AND PROCEED CONSECUTIVELY. USE 07* HIGH CHARACTERS. EXAMPLE: 000100-001 - A VIBRATOR TOOL MAY BE USED.

DIMENSIONS ARE IN mm (INCHES) TOLERANCES:
 X .XX ±.01A (1) ANGULAR ±.01A *
 MATERIAL: AS BOM
 FINISH: AS DRW
 NAME: DATE: 2/17/08
 DRAWN: I WILMOT 8/26/05
 CHECKED: AUB 11/JUN/08
 APPROVED: AUB 21/JULY/08

CALIFORNIA INSTITUTE OF TECHNOLOGY
 MASSACHUSETTS INSTITUTE OF TECHNOLOGY
 GLASGOW UNIVERSITY GEO ROSS GROUP
 RUTHERFORD APPLETON LABORATORIES
 SYSTEM: **ADVANCED LIGO**
 SUB-SYSTEM: **SUS**
 NEXT ASSY: **QUAD N-PTYPE**
 PART NAME: **UI MASS**
 DRG. NO.: **D060375**
 SCALE: 1:1 PRODUCTION SHEET 1 OF 1