

REV.	DATE	DCN #	DRAWING TREE #
A	13/OCT/06	E060238	
E	15/JULY/08	E080367	

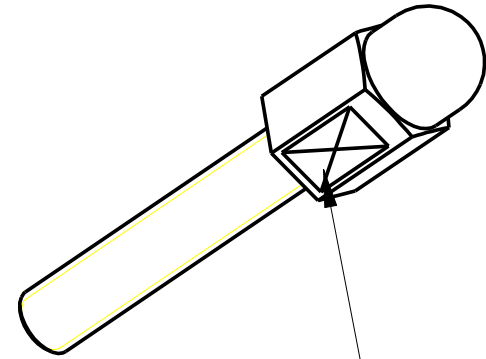
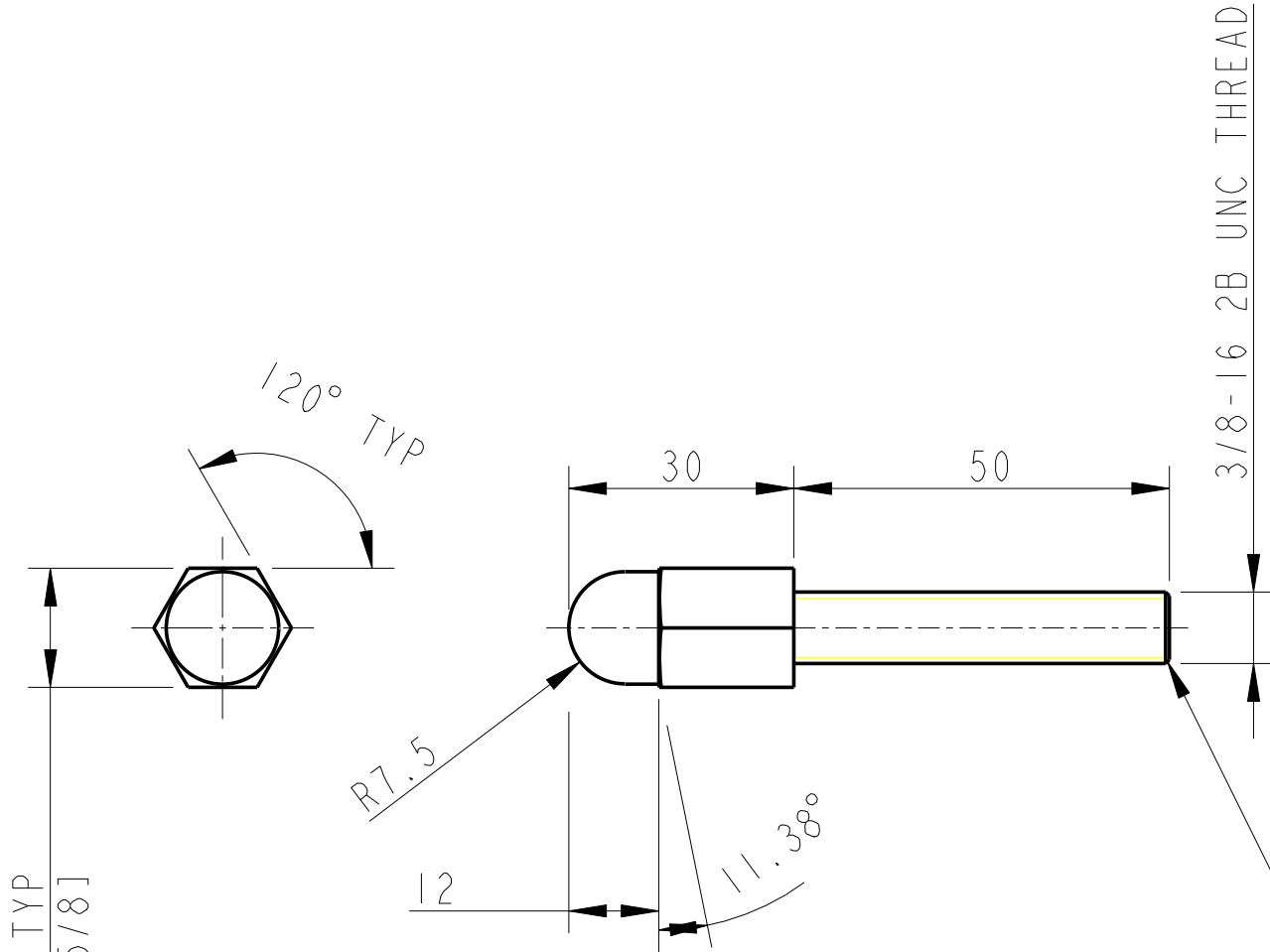

3D VIEW

PART NO. SEE NOTE 4

15.875 TYP
[5/8]

R7.5

12

30

50

3/8-16 2B UNC THREAD

45° X 0.5

11.38°

NOTES: (UNLESS OTHERWISE SPECIFIED)

1. REMOVE ALL SHARP EDGES, R.02 MIN.
2. DO NOT SCALE FROM DRAWING.
3. ALL MACHINING FLUIDS SHALL BE WATER SOLUBLE AND FREE OF SULFUR, CHLORINE AND SILICONE, SUCH AS CINCINNATI MILACRON'S CIMTECH 410 (STAINLESS STEEL)
4. SCRIBE, ENGRAVE OR STAMP DRAWING PARTNUMBER ON NOTED SURFACE OF PART AND A THREE DIGIT SERIAL NUMBER. SERIAL NUMBERS START AT 001 FOR THE FIRST PART AND PROCEED CONSECUTIVELY. USE .07" HIGH CHARACTERS. EXAMPLE: D020188- 001. A VIBRATORY TOOL MAY BE USED.

DIMENSIONS ARE IN mm [INCHES]
TOLERANCES:

X.XX ±0.25 mm
ANGULAR ±0.5°

MATERIAL: ST STEEL
304/316

FINISH: CLEAN
√μm [μin] Ra = 1.6 [63]

	NAME	DATE
DRAWN	I WILMUT	5/OCT/06
CHECKED	AJB	5MAY08
APPROVED	AJB	15/JULY/08

LIGO CALIFORNIA INSTITUTE OF TECHNOLOGY
MASSACHUSETTS INSTITUTE OF TECHNOLOGY
1GR, GLASGOW UNIVERSITY GEO 600 GROUP
RUTHERFORD APPLINGTON LABORATORIES

SYSTEM **ADVANCED LIGO**

SUB-SYSTEM **SUS**

NEXT ASSY **QUAD N-PTYPE TOP STAGE**

PART NAME **JACKING SCREW / EARTHQUAKE STOP**

SIZE A	DRG. NO. D060331	REV. E.
SCALE 1:1	PROJECTION:	SHEET 1 OF 1