

REV.	DATE	DCN #	DRAWING TREE #
A	6 NOV 06	E060262	E060243
B	1 APR 07	E060262	E060243
C	12 DEC 07	E060262	E060243

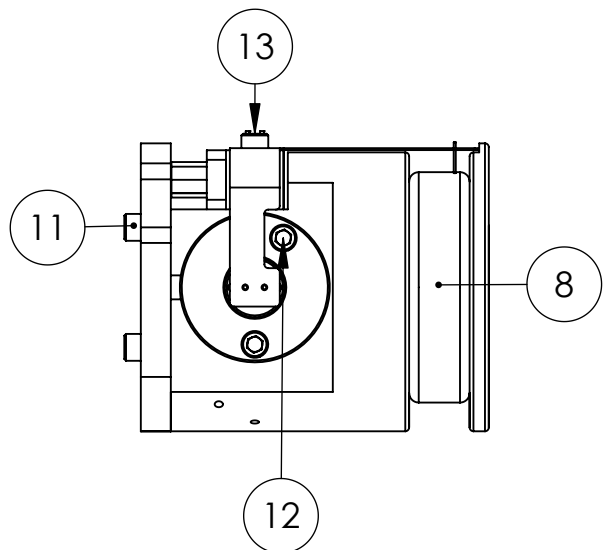
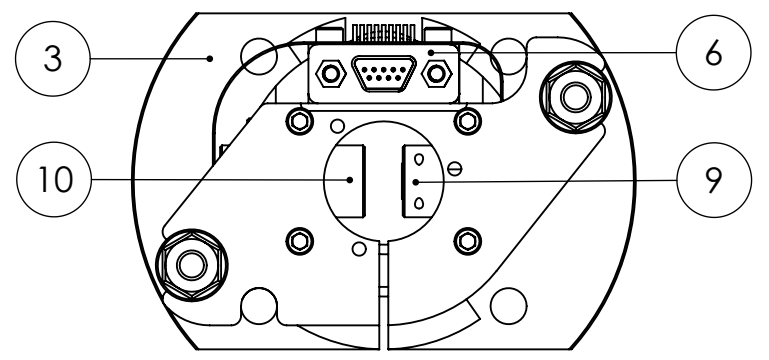
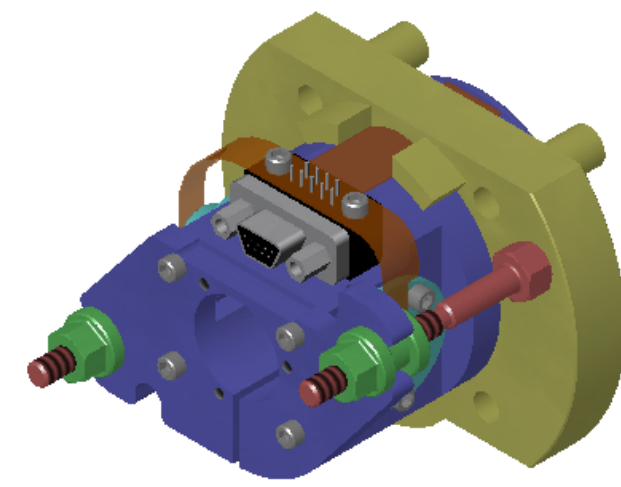
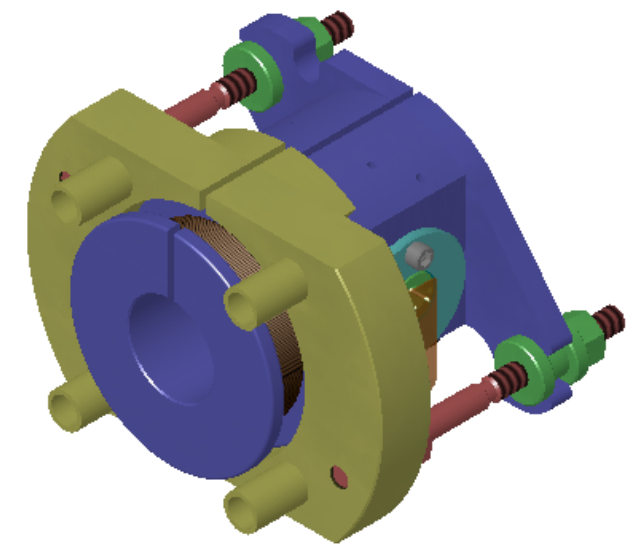
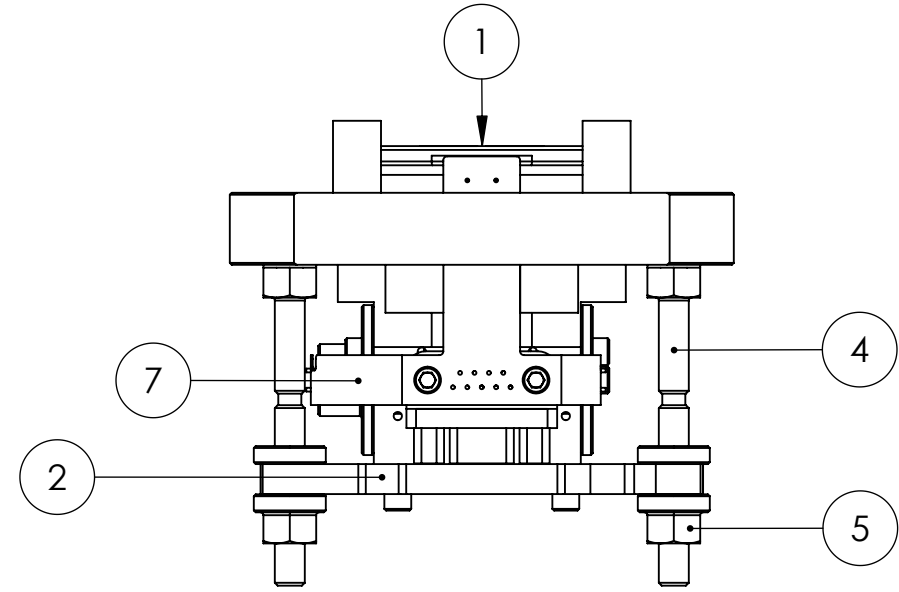

ITEM NO	REQ.	SPARE	TOT.	PART NUMBER	DESCRIPTION
13	2	2	4		No. 2 UNC Caphead x 1/2" long
12	4	4	8		No. 2 UNC Caphead x 1/4" long
11	4	4	8		No. 2 UNC Caphead x 5/16" long
10	1	1	2	D060216	IRLED Assembly
9	1	1	2	D060217	PD Assembly
8	1	1	2		Coil Winding (MWS 32QML)
7	1	1	2	D050435	Flexi-Circuit
6	1	1	2	GlenAir	Connector (GlenAir)
5	2	2	4	D060110	Adjuster Nut
4	2	2	4	D060109	Adjuster Shaft
3	1	1	2	D060108	Coilformer Clamp
2	1	1	2	D060107	Coilformer Backplate
1	1	1	2	D060106	Coilformer

PARTS LIST

NOTES: (UNLESS OTHERWISE SPECIFIED)

- DO NOT SCALE FROM DRAWING.
- REMOVE ALL SHARP EDGES, R.02 MIN.
- ALL MACHINING FLUIDS SHALL BE WATER SOLUBLE AND FREE OF SULFUR, CHLORINE AND SILICONE, SUCH AS CINCINNATI MILACRON'S CIMTECH 410 (STAINLESS STEEL)
- ASSEMBLE ACCORDING TO NOISE PROTOTYPE OSEM ASSEMBLY SPECIFICATION.

DIMENSIONS ARE IN INCHES

TOLERANCES:
 .XX ± 0.01
 .XXX ± 0.005

ANGULAR ± 0.5 °

	NAME	DATE
DRAWN	S.Brookes	26 JUN 06
CHECKED	S.Aston	12 OCT 06
APPROVED	A. Vecchio	31 OCT 06

SYSTEM ADVANCED LIGO
SUB-SYSTEM SUS
NEXT ASSY
PART NAME BOSEM Assembly

SIZE DWG. NO. D060218 **REV.** C
B

SCALE: 1:1 PROJECTION: SHEET 1 OF 1

D
C
B
A

D
C
B
A

8 7 6 5 4 3 2 1