

NOTES CONTINUED:

8
7
6
5
4
3
2
1

H
G
F
E
D
C
B
A

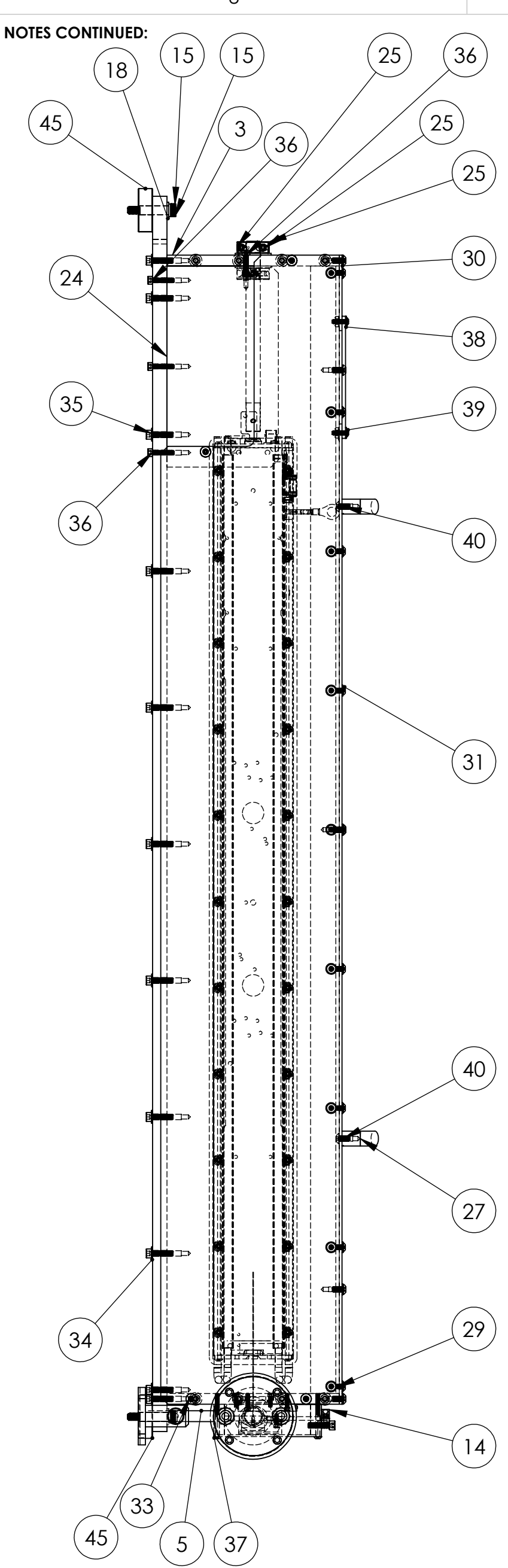

RIGHT SIDE VIEW

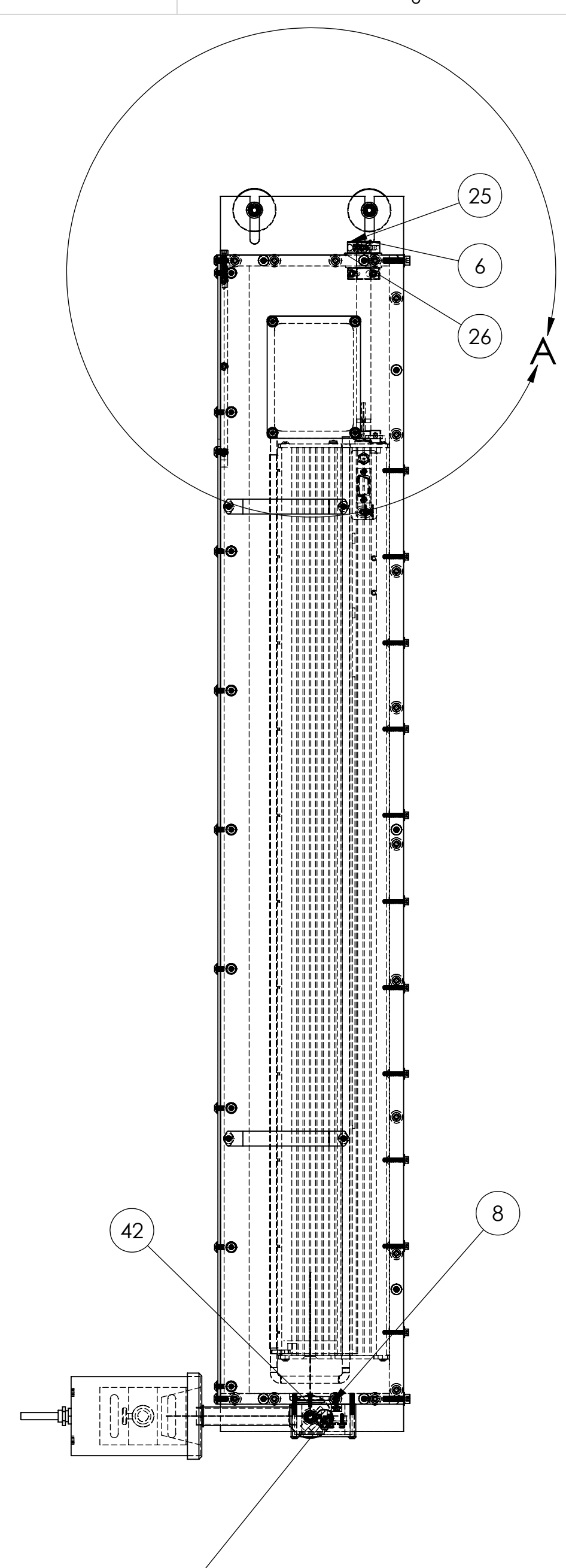

TOP VIEW

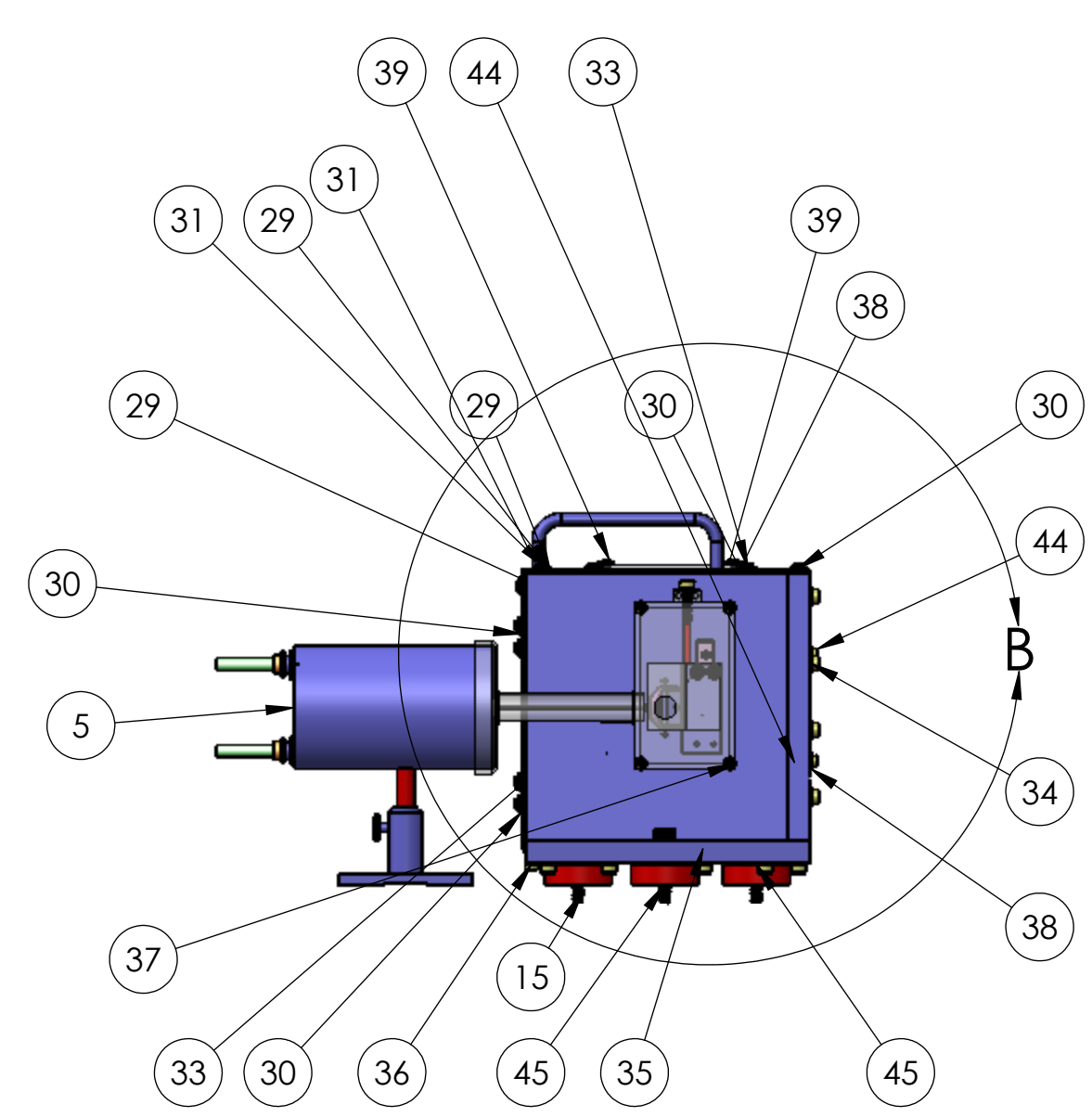

DETAIL B
SCALE 1 : 2

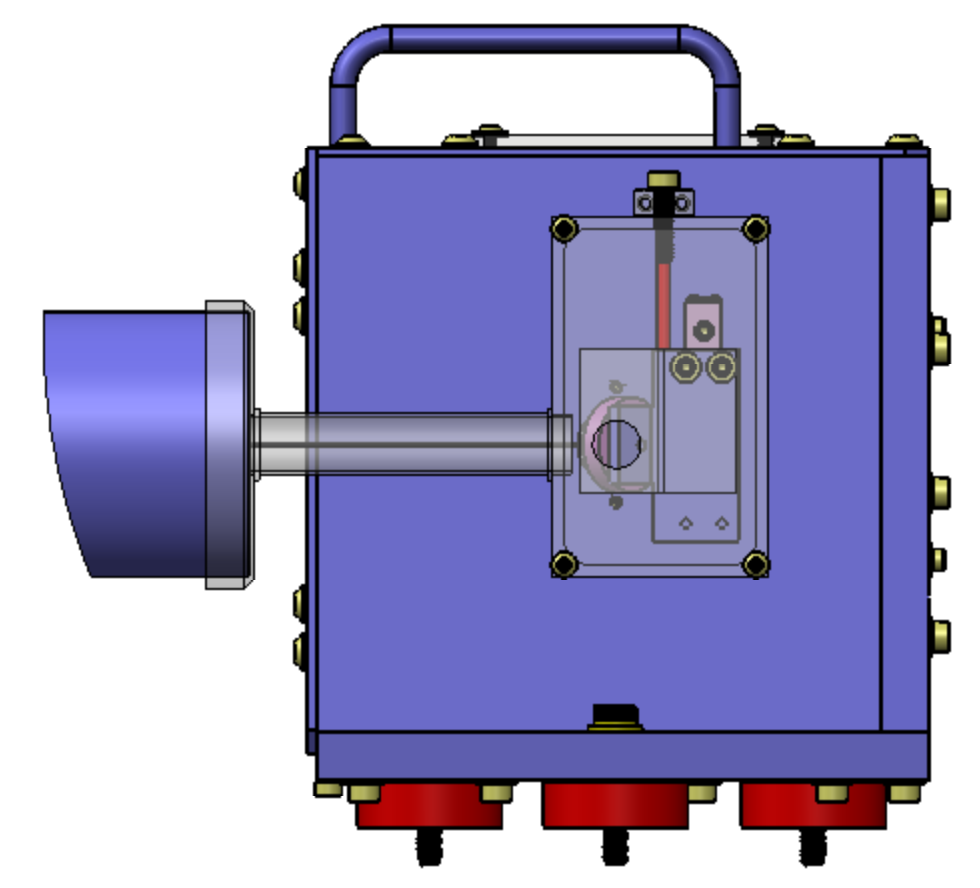
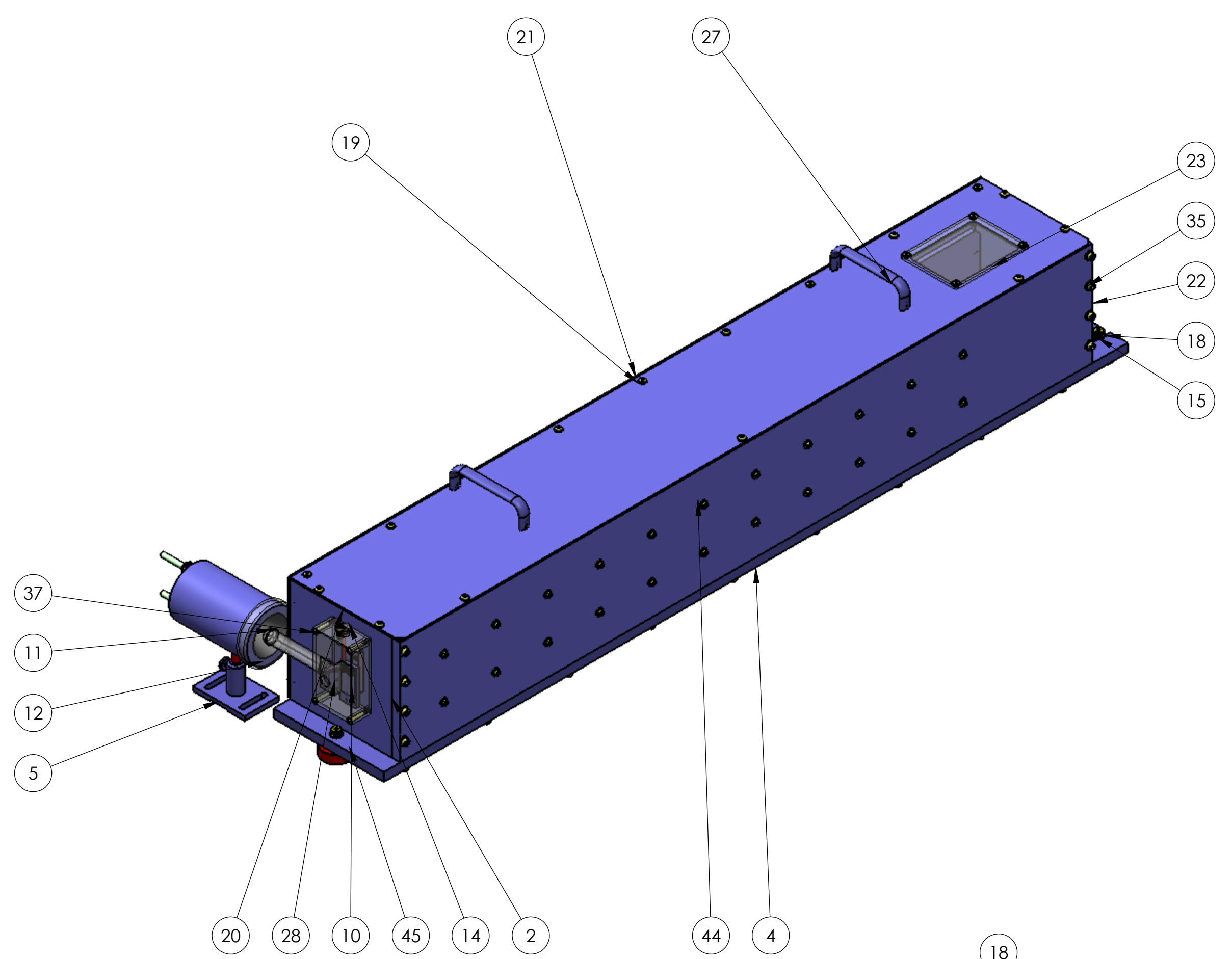

DETAIL A
SCALE 1 : 2

REV.	DATE	DCN #	DRAWING TREE #
-	-	-	-
-	-	-	-
-	-	-	-

ITEM NO.	PART NUMBER	DESCRIPTION	MATERIAL	REQ	SPARE	TOTAL
45	D0901430	ADLIGO_TCS_LASER_ENCLOSURE_SPACER	AISI 304	3		3
44	MCMMASTER	6-32X.75 SHCS BLK SS MCMMASTER 96006A259	AISI 304	22		22
43	MCMMASTER	#4 WASHER BLK SS MCMMASTER 96765A125	AISI 304	4		4
42	MCMMASTER	4-40X.38 SHCS BLK SS MCMMASTER 96006A213.	AISI 304	4		4
41	MCMMASTER	4-40X.5 SHCS BLK SS MCMMASTER 96006A216	AISI 304	2		2
40	MCMMASTER	10-32X.50 BHCS BLK SS MCMMASTER 97763A214	AISI 304	4		4
39	MCMMASTER	6-32X.50 BHCS BLK SS MCMMASTER 97763A143	AISI 304	4		4
38	MCMMASTER	#6 WASHER BLK SS MCMMASTER 96765A115	AISI 304	30		30
37	MCMMASTER	6-32X1.5 BHCS BLK SS MCMMASTER 92949A157	AISI 304	4		4
36	MCMMASTER	8-32X.75 SHCS BLK SS MCMMASTER 96006A619	AISI 304	4		4
35	MCMMASTER	10-24X.75 SHCS BLK SS MCMMASTER 96006A649	AISI 304	27		27
34	MCMMASTER	#10 WASHER BLK SS MCMMASTER 96765A125	AISI 304	31		31
33	MCMMASTER	10-24 X.38 BHCS BLK SS MCMMASTER 97763A214	AISI 304	12		12
32	MCMMASTER	NUT_6-32 BLK SS MCMMASTER 96537A130	AISI 304	4		4
31	MCMMASTER	8-32X.25 BHCS BLK SS MCMMASTER 7763A176	AISI 304	18		18
30	MCMMASTER	#8 WASHER BLK/SS MCMMASTER 96765A120	AISI 304	11		11
29	MCMMASTER	#8 WASHER BLK /SS MCMMASTER 96765A120	AISI 304	18		18
28	D0901447	ADLIGO_TCS_LASER_ENCLOSURE_SHUTTER	6061-T6	1		1
27	D0901482	ADLIGO_TCS_LASER_ENCLOSURE_HANDLE	6061-T6	2		2
26	MCMMASTER	SHAFT WASHER .50 BLK-SS MCMMASTER 96765A160	AISI 304	2		2
25	D0901452	KEY SHAFT KNOB MCMMASTER 6436K34	AISI 304	2		2
24	D0901427	ADLIGO_TCS_LASER_ENCLOSURE_BULKHEAD_PL	6061-T6	1		1
23	D0901426	ADLIGO_TCS_LASER_ENCLOSURE_WINDOW	ACRYLIC	1		1
22	D0901431	ADLIGO_TCS_LASER_ENCLOSURE_LASER_MOUNT_PL	6061-T6	1		1
21	D0901422	ADLIGO_TCS_LASER_ENCLOSURE_COVER_SIDE	6061-T6	1		1
20	D0901423	ADLIGO_TCS_LASER_ENCLOSURE_COVER_TOP	6061-T6	1		1
19	D0901429	ADLIGO_TCS_LASER_ENCLOSURE_COVER_ANGLE	6061-T6	1		1
18	MCMMASTER	.312 WASHER BLK-SS MCMMASTER 98017A690	AISI 304	3		3
17	D0901434	ADLIGO_TCS_LASER_ENCLOSURE_LASER_WINDOW_RING	6061-T6	1		1
16	D0901453	ADLIGO_TCS_LASER_ENCLOSURE_W1008-Z-AR_WINDOW	Zink Selenide (ZnSe)	1		1
15	MCMMASTER	BASE PLATE SCH_SCR_ MCMMASTER 90298A583	AISI 304	3		3
14	D0901437	ADLIGO_TCS_LASER_ENCLOSURE_SHUTTER_LOCK	AISI 304	1		1
13	D0901425	ADLIGO_TCS_LASER_ENCLOSURE_MIRROR_ROD	AISI 304	1		1
12	D0901450	ADLIGO_TCS_LASER_ENCLOSURE_DUMP_CAP	6061-T6	1		1
11	D0901449	ADLIGO_TCS_LASER_ENCLOSURE_DUMP_TUBE	6061-T6	1		1
10	D0901432	ADLIGO_TCS_LASER_ENCLOSURE_LASER_MIRROR_COVER	6061-T6	1		1
9	D0901418	ADLIGO_TCS_LASER_MIRROR_MT	6061-T6	1		1
8	D0901484	ADLIGO_TCS_LASER_ENCLOSURE_SLIDE	N/A	1		1
7	D0901451	ADLIGO_TCS_LASER_ENCLOSURE_DUMP_MIRROR	Copper	1		1
6	D0901421	ADLIGO_TCS_LASER_ENCLOSURE_KEY_SHAFT	6061-T6	1		1
5	D0901448	ADLIGO_TCS_LASER_ENCLOSURE_BM_DMP_ASEM.	N/A	1		1
4	D0901420	ADLIGO_TCS_LASER_BASE_PLATE	6061-T6	1		1
3	D0901424	ADLIGO_TCS_LASER_ENCLOSURE_OPP_APERTURE	6061-T6	1		1
2	D0901428	ADLIGO_TCS_LASER_ENCLOSURE_APERTURE_PL	6061-T6	1		1
1	D0901230	ADLIGO_48-2KW_LASER_ASSEM_SLDPR		1		1

NOTES AND TOLERANCES: (UNLESS OTHERWISE SPECIFIED)

1. INTERPRET DRAWING PER ASME Y14.5-1994.
2. REMOVE ALL SHARP EDGES, R.02 MIN.
3. DO NOT SCALE FROM DRAWING.
4. ALL MACHINING FLUIDS SHALL BE WATER SOLUBLE AND FREE OF SULFUR, CHLORINE AND SILICONE, SUCH AS CINCINNATI MILACRON'S CIMTECH 410.

DIMENSIONS ARE IN
TOLERANCES:
.XX ±
.XXX ±
ANGULAR ± °

MATERIAL N/A FINISH N/A

LIGO CALIFORNIA INSTITUTE OF TECHNOLOGY
MASSACHUSETTS INSTITUTE OF TECHNOLOGY

SYSTEM ADVANCED LIGO SUB-SYSTEM AOS

NEXT ASSY

PART NAME
ADLIGO_TCS_LASER_ENCLOSURE_ASSEM.

DESIGNER KMAILAND 07-15-2009 SIZE DWG. NO. REV.
DRAFTER
CHECKER
APPROVAL

D0901417 v1

SCALE: 1:8 PROJECTION: SHEET 1 OF 1

D0901417_ADLIGO_TCS_LASER_ENCLOSURE_ASSEM_PART_PDM_REV_X:001_DRAWING_PDM_REV_X:004