

NOTES CONTINUED:

⑤ SCRIBE, ENGRAVE, OR MECHANICALLY STAMP (NO INKS OR DYES) DRAWING PART NUMBER AND REVISION ON NOTED SURFACE FOLLOWED ON THE NEXT LINE BY A THREE DIGIT SERIAL NUMBER. SERIAL NUMBERS START AT 001 FOR THE FIRST ARTICLE AND PROCEED CONSECUTIVELY. USE .07" HIGH CHARACTERS. EXAMPLE: DXXXXXXX-VY, S/N 001. A VIBRATORY TOOL MAY BE USED.

⑥ MACHINE ALL SURFACES.

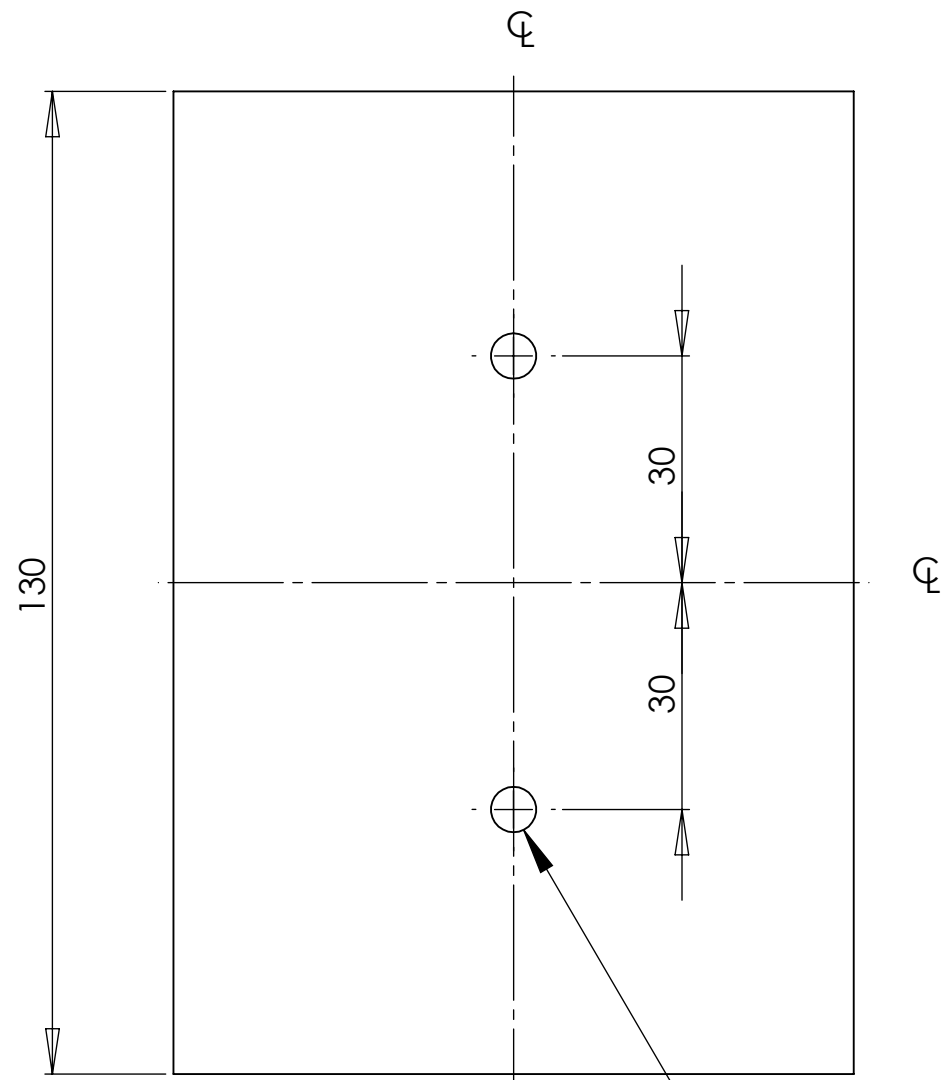
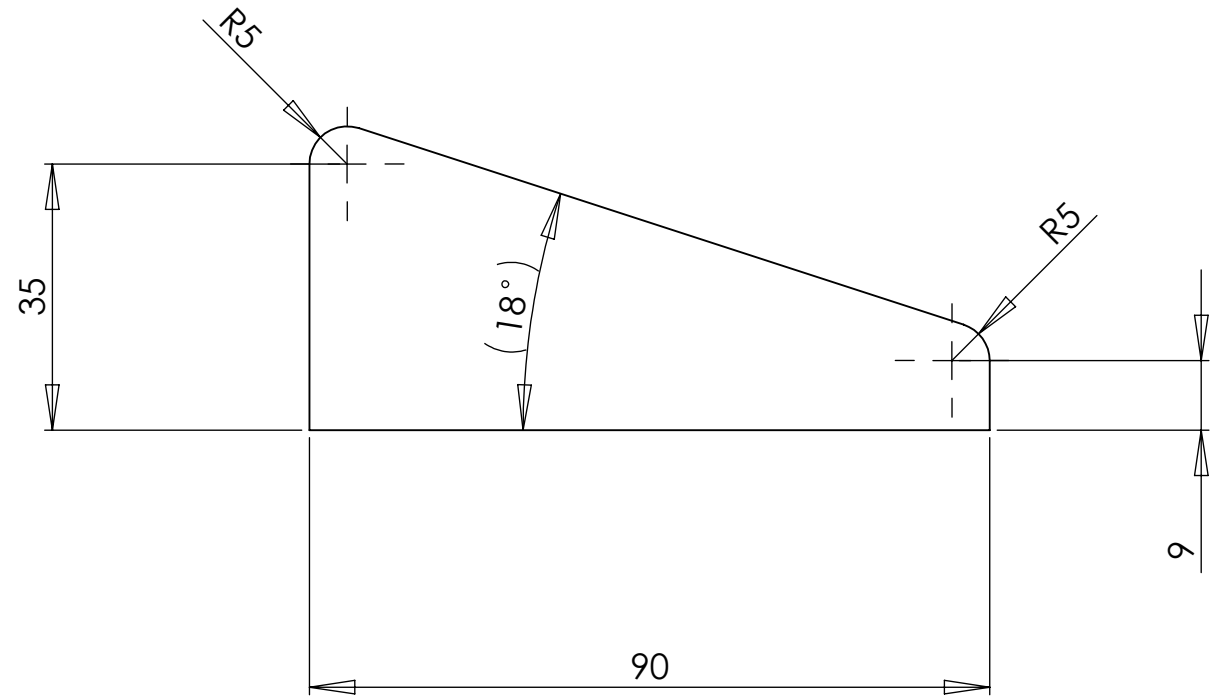

2 X TAP FOR 1/4-20 HELICOIL 2X Ø

REV.	DATE	DCN #	DRAWING TREE #

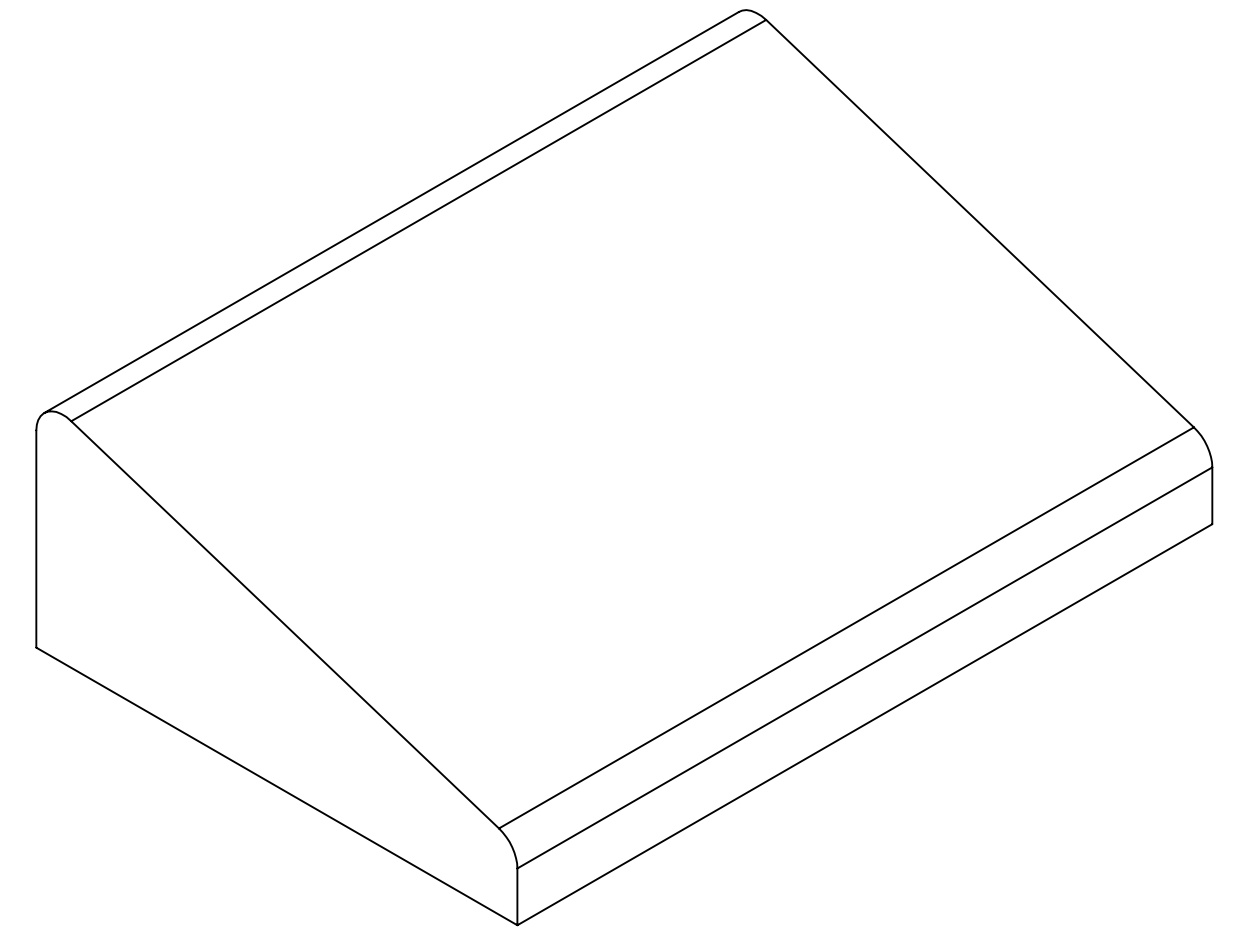

ISOMETRIC VIEW

NOTES AND TOLERANCES: (UNLESS OTHERWISE SPECIFIED)

1. INTERPRET DRAWING PER ASME Y14.5-1994.
2. REMOVE ALL SHARP EDGES, R.02 MIN.
3. DO NOT SCALE FROM DRAWING.
4. ALL MACHINING FLUIDS MUST BE FULLY SYNTHETIC, FULLY WATER SOLUBLE AND FREE OF SULFUR, SILICONE, AND CHLORINE.

MATERIAL PTFE (general)

FINISH 1.6 µm



SYSTEM ADVANCED LIGO SUB-SYSTEM SUS

NEXT ASSY

PART NAME

OPTIC SUPPORT PAD

DESIGNER L.CUNNINGHAM 16/06/2009
 DRAFTER L.CUNNINGHAM
 CHECKER
 APPROVAL

SIZE DWG. NO. REV.
 c D0901306 v1
 SCALE: 1:1 PROJECTION: SHEET 1 OF 1

DIMENSIONS ARE IN MILLIMETERS

TOLERANCES:
 .XX ± .10
 .XXX ± .010

ANGULAR ± 0.2°