

4

3

2

1

NOTES CONTINUED:

Ⓢ BAG ALL ITEMS INDIVIDUALLY AND MARK OR TAG EACH BAG WITH DRAWING NUMBER, REVISION, AND QUANTITY. EXAMPLE: DXXXXXX-VY, QTY: 1

REV.	DATE	DCN #	DRAWING TREE #
v1	28 JUL 2009	E0900197	-
-	-	-	-
-	-	-	-

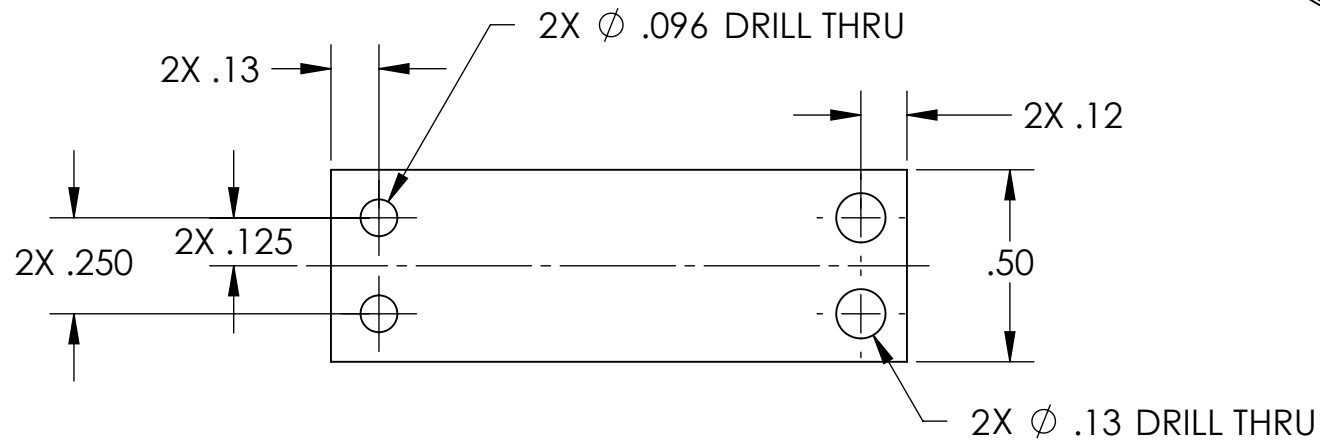
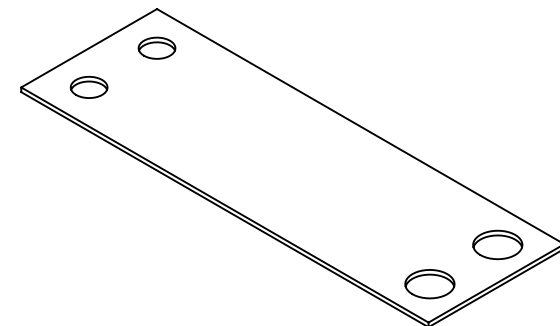

NOTES AND TOLERANCES: (UNLESS OTHERWISE SPECIFIED)

DIMENSIONS ARE IN INCHES

TOLERANCES:  
.XX ± .01  
.XXX ± .005

ANGULAR ± 0.5°

1. INTERPRET DRAWING PER ASME Y14.5-1994.
2. REMOVE ALL SHARP EDGES, R.02 MIN.
3. DO NOT SCALE FROM DRAWING.
4. ALL MACHINING FLUIDS SHALL BE WATER SOLUBLE AND FREE OF SULFUR, CHLORINE AND SILICONE, SUCH AS CINCINNATI MILACRON'S CIMTECH 410.

MATERIAL 304, 316 OR 302 SSSL

FINISH 32 μinch

**LIGO** CALIFORNIA INSTITUTE OF TECHNOLOGY  
 MASSACHUSETTS INSTITUTE OF TECHNOLOGY

SYSTEM ADVANCED LIGO

SUB-SYSTEM SUS

NEXT ASSY TIP-TILT STRUCTURE ASSEMBLY

PART NAME

TIP-TILT BLADE SPRING

DESIGNER	M. MEYER	08 JUN 2009
DRAFTER	M. MEYER	08 JUN 2009
CHECKER	D. BRIDGES	08 JUN 2009
APPROVAL		

SIZE DWG. NO. **A D0901164**

REV. v1

SCALE: 2:1 PROJECTION: SHEET 1 OF 1

4

3

2

1