

5. REFER TO DOCUMENT D1101271 FOR OPTICAL TABLE HOLE TABULATION CONVENTION.
6. REFER TO G1000125 FOR ISI NAMING AND ORIENTATION CONVENTION.
7. REFER TO T1100292 FOR VIEWPORT DEFINITIONN
8. REFEER TO E1200625 FOR LOCAL COORDINATES OF SUPPORT TUBES ENDS

REV.	DATE	DCN #	DRAWING TREE #
------	------	-------	----------------

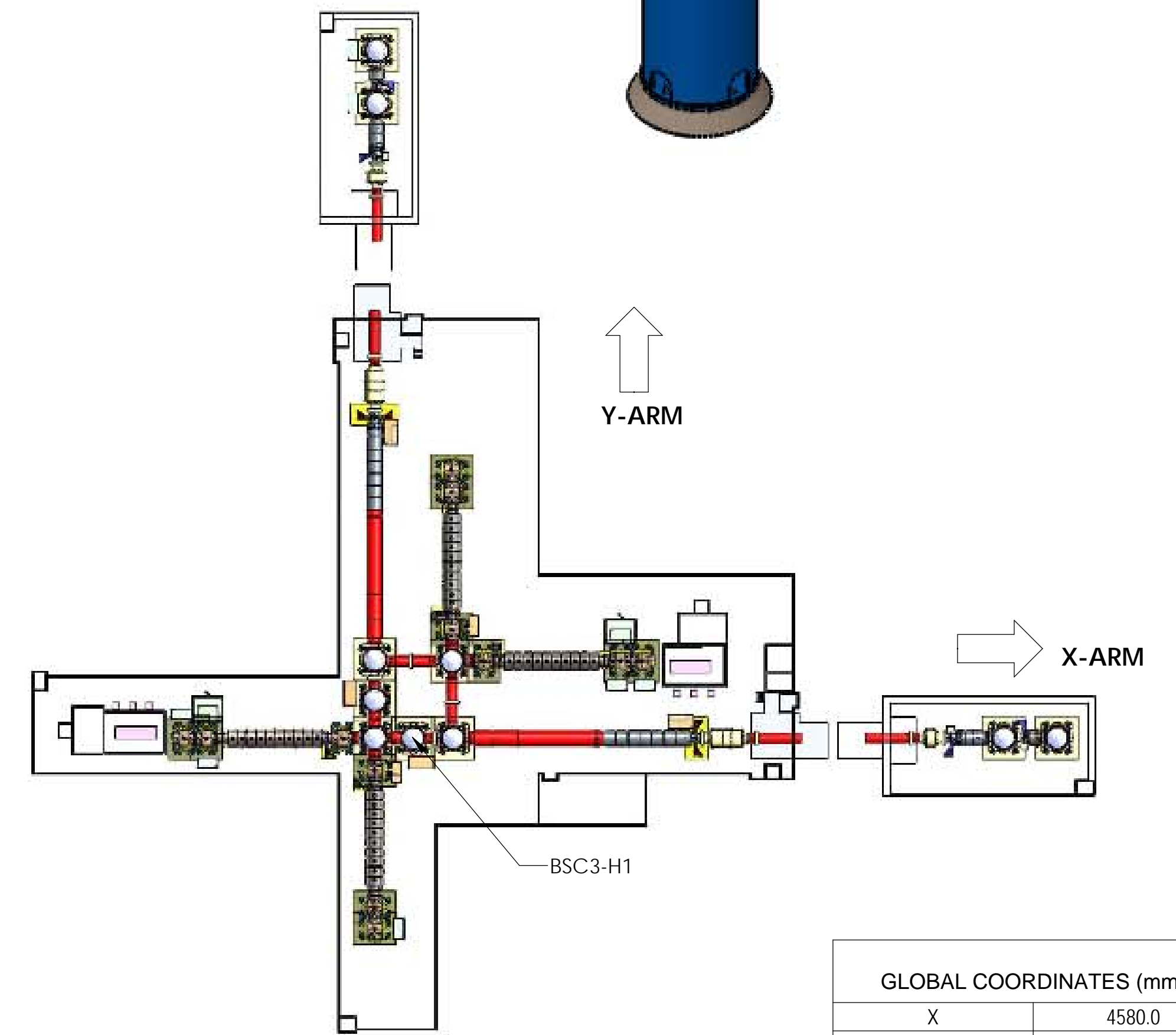
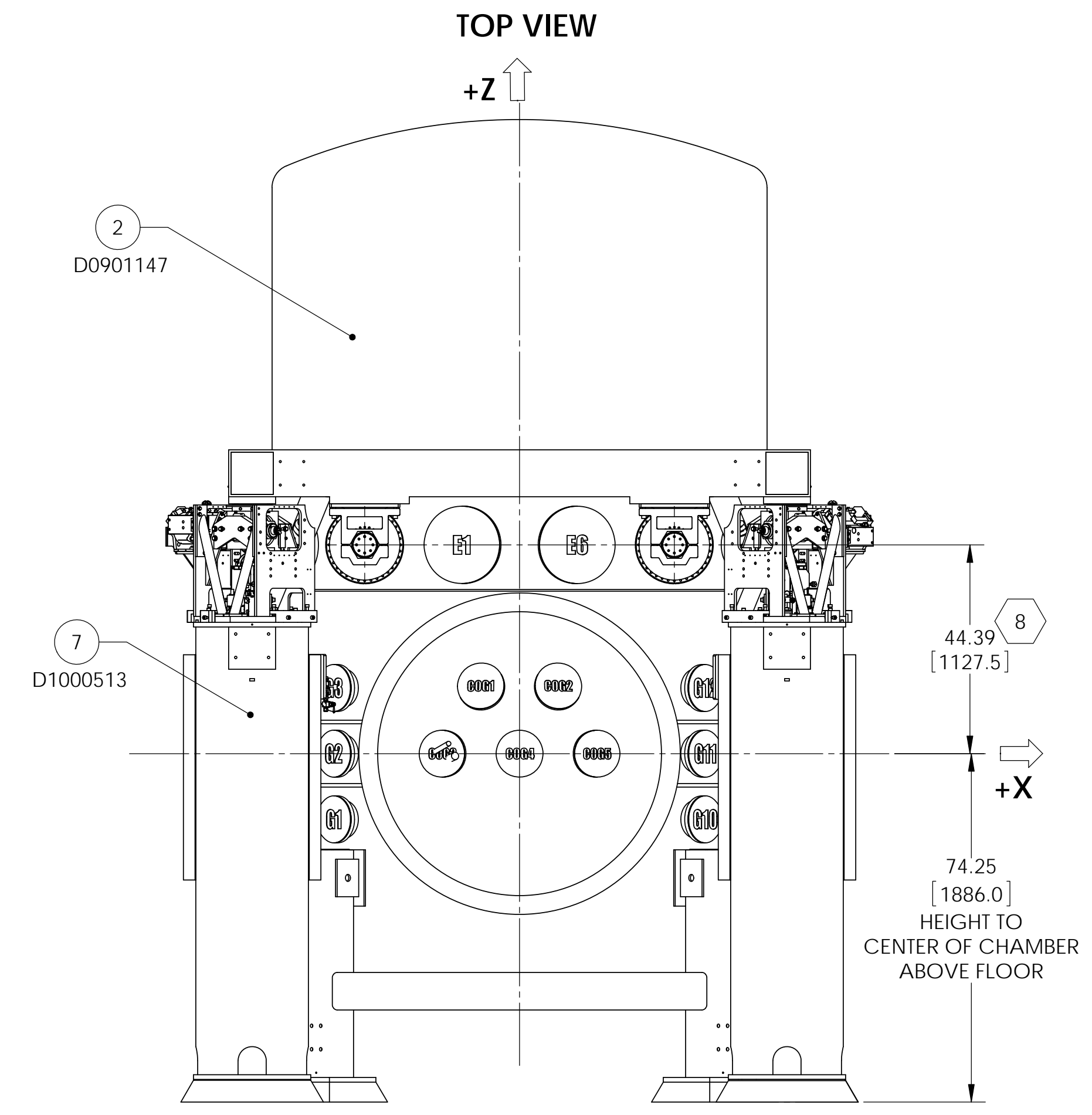
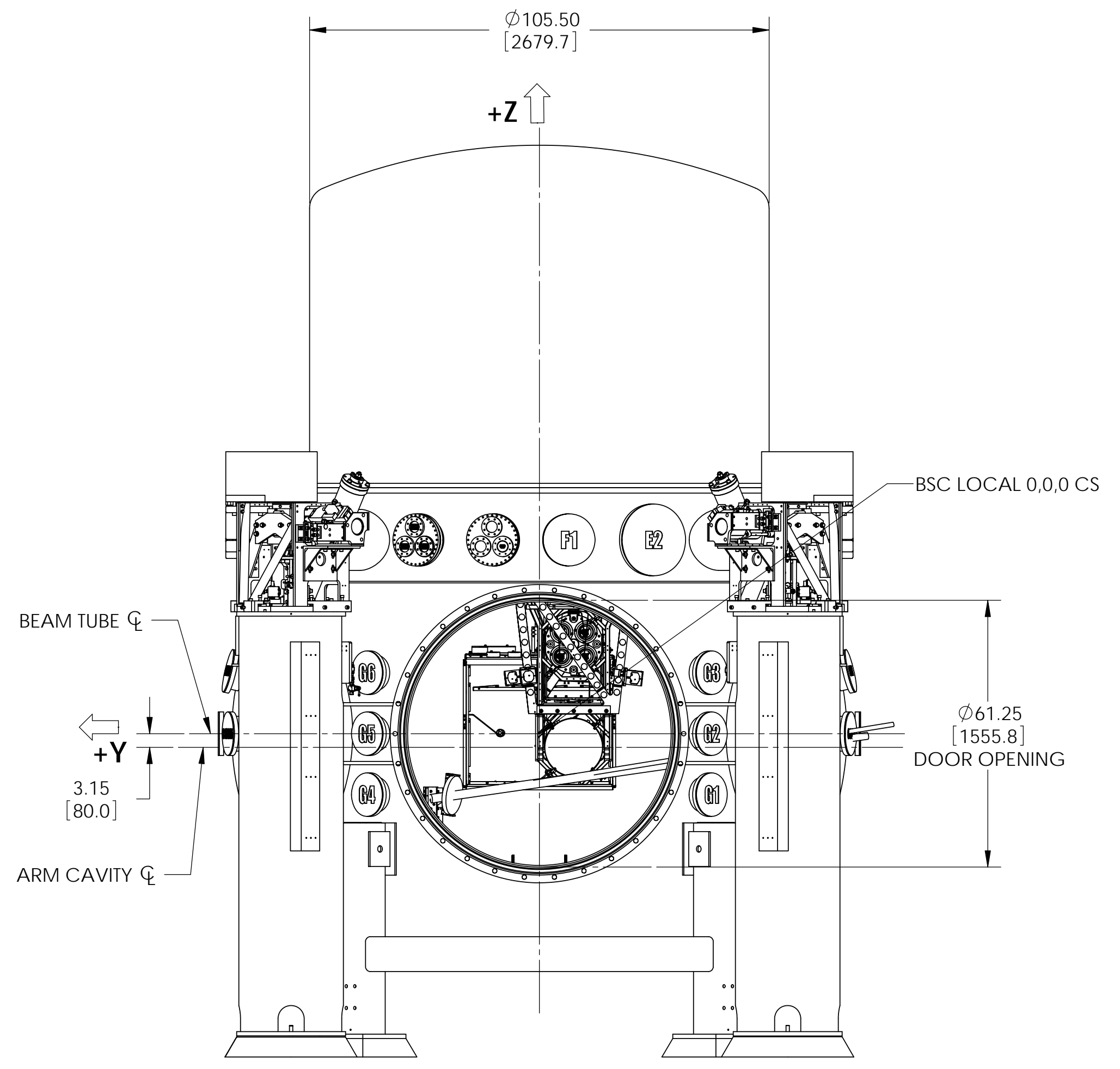
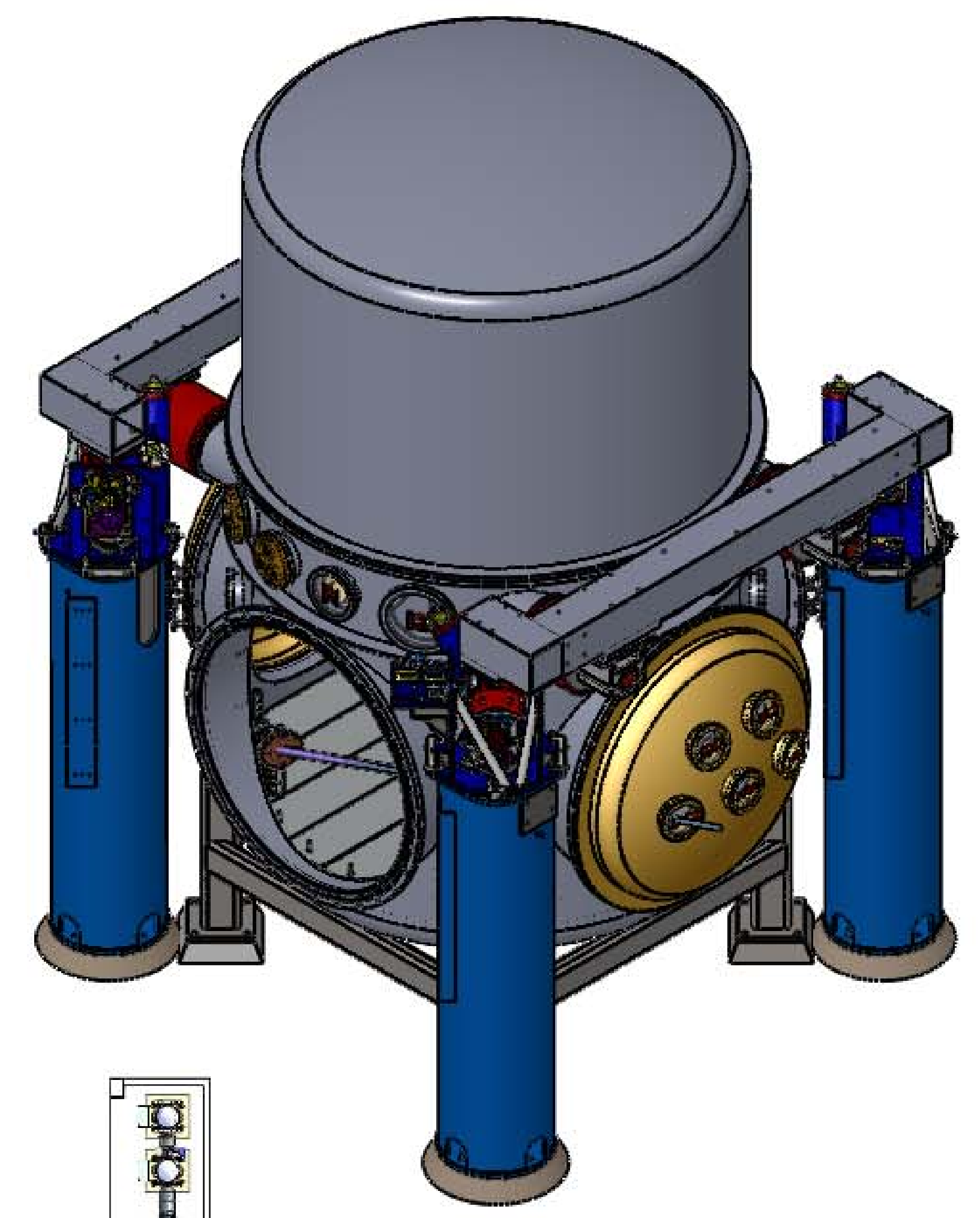
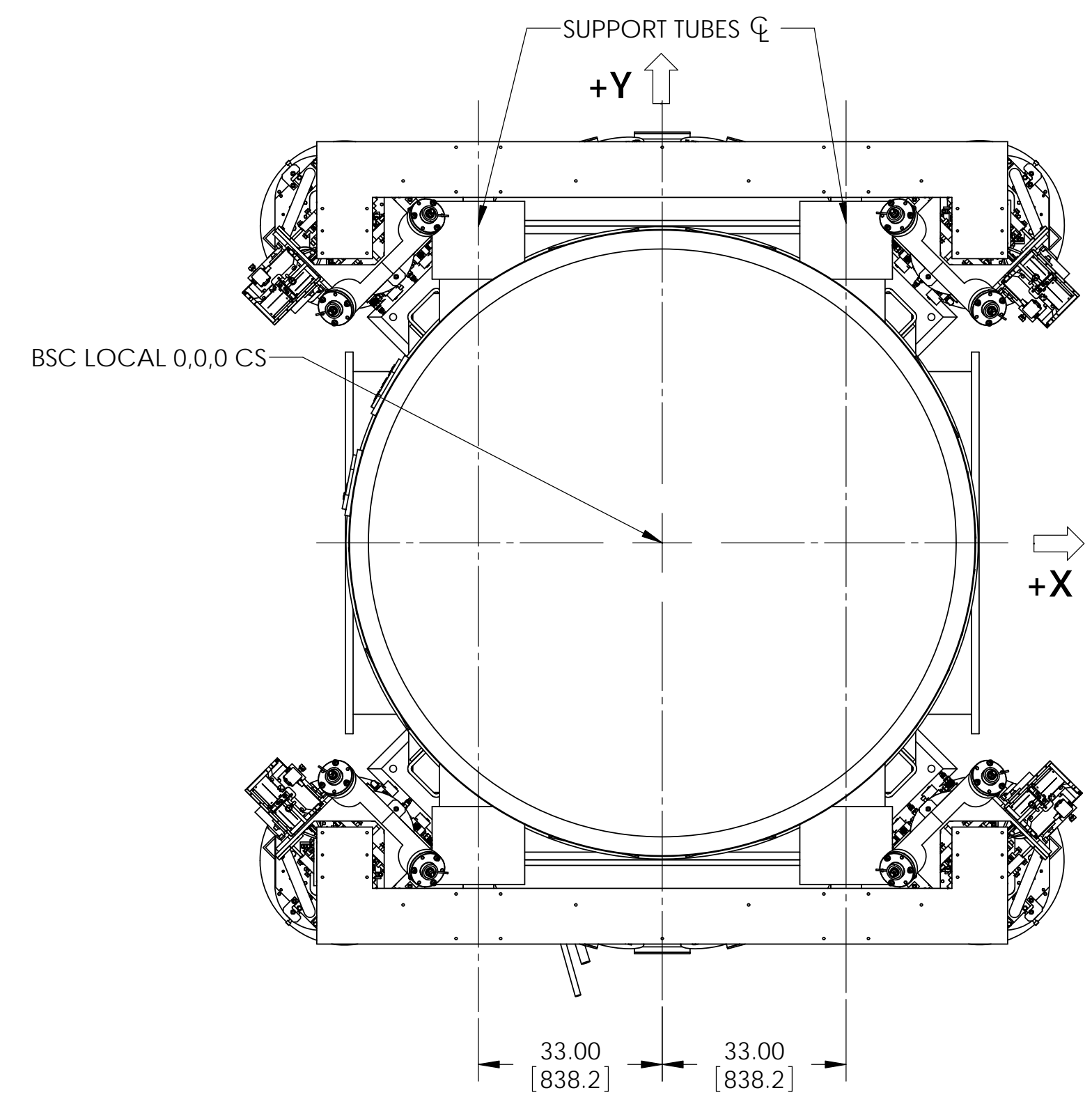

GLOBAL COORDINATES (mm)	
X	4580.0
Y	0.0
Z	0.0

NOTES AND TOLERANCES: (UNLESS OTHERWISE SPECIFIED)	
1. INTERPRET DRAWING PER ASME Y14.5-1994.	
2. REMOVE ALL SHARP EDGES, .005-.015, FOR MACHINED PARTS. ROUND ALL EDGES APPROXIMATELY R.02 FOR SHEET METAL PARTS.	
3. DO NOT SCALE FROM DRAWING.	
4. ALL MACHINING FLUIDS MUST BE FULLY SYNTHETIC, FULLY WATER SOLUBLE AND FREE OF SULFUR, SILICONE, AND CHLORINE.	
MATERIAL	FINISH
--	-- μ inch

LIGO CALIFORNIA INSTITUTE OF TECHNOLOGY MASSACHUSETTS INSTITUTE OF TECHNOLOGY		PART NAME	
ADVANCED LIGO		BSC3-H1 Top Level Chamber Assembly, Fully Defined	
DESIGNER	ED CHAVEZ	DATE	05 DEC 2012
DRAFTER		SIZE	D
CHECKER		DWG. NO.	D0901146
APPROVAL		REV.	v5
SCALE: 1:24		PROJECTION:	
		SHEET 1 OF 3	

D0901146-ADM-LIGO Systems: BSC3-H1 Top Level Chamber Assembly, ALL PART PDM REV. X-04B, DRAWING PDM REV. X-000

8 7 6 5 4 3 2 1

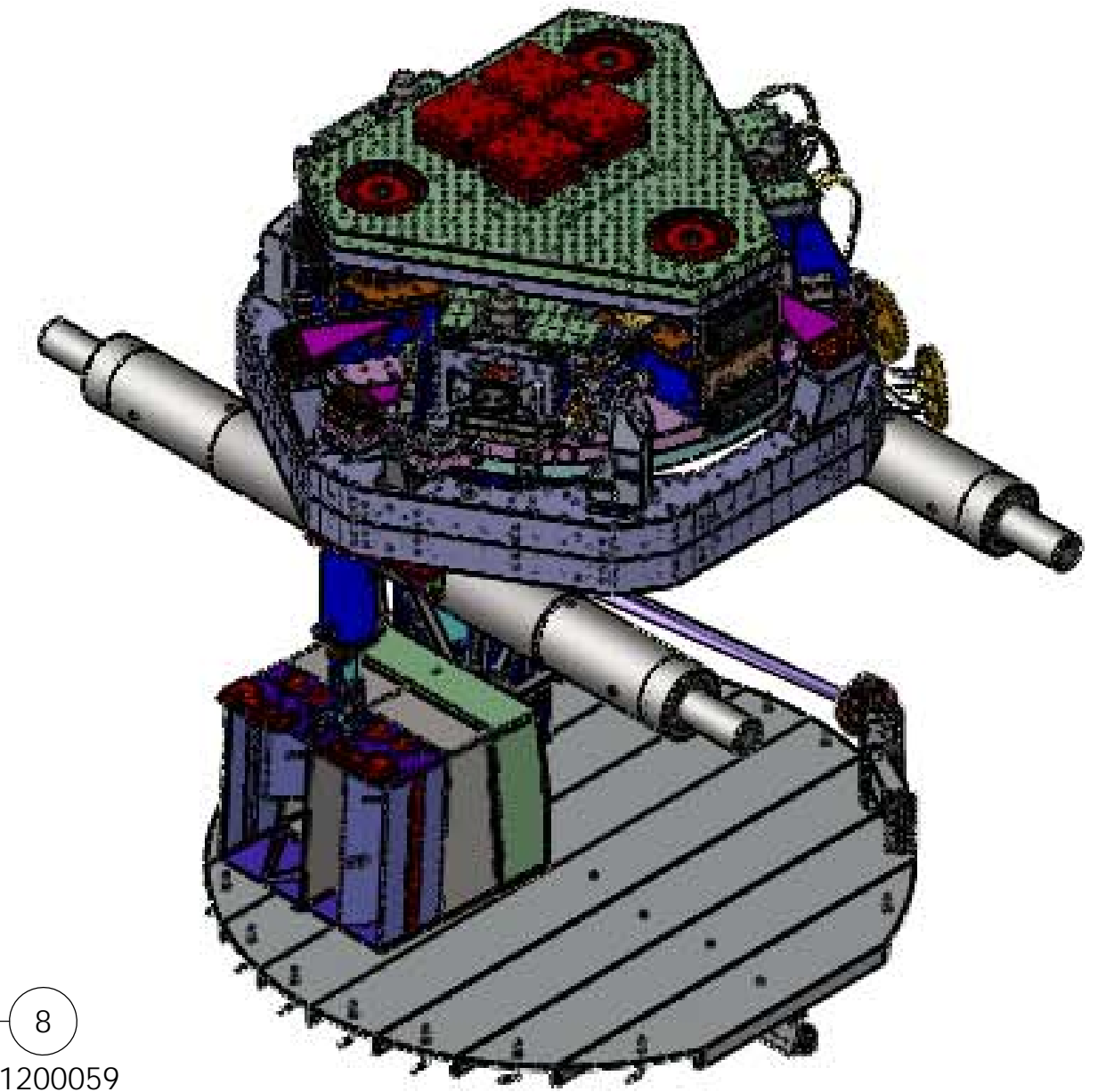
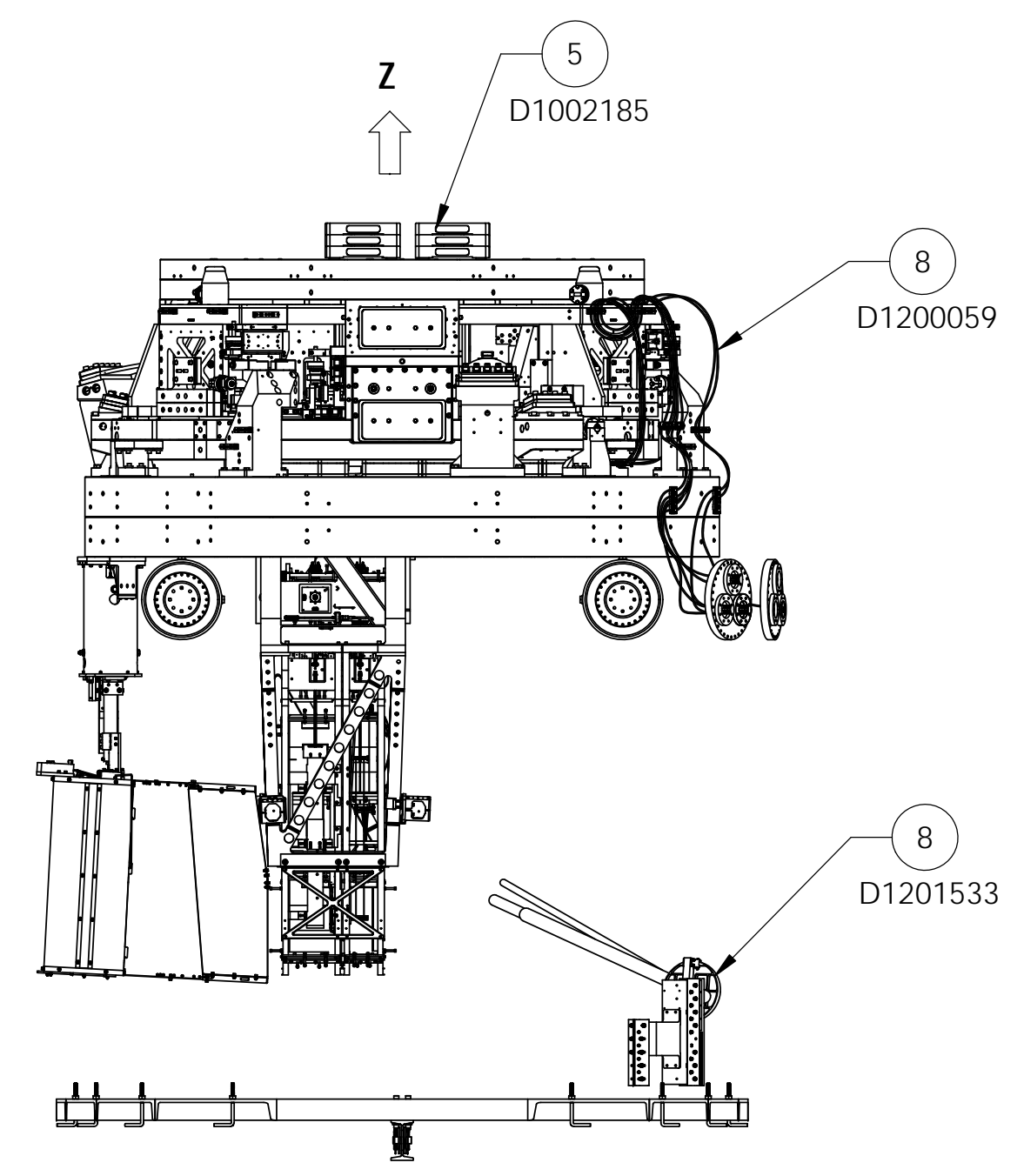
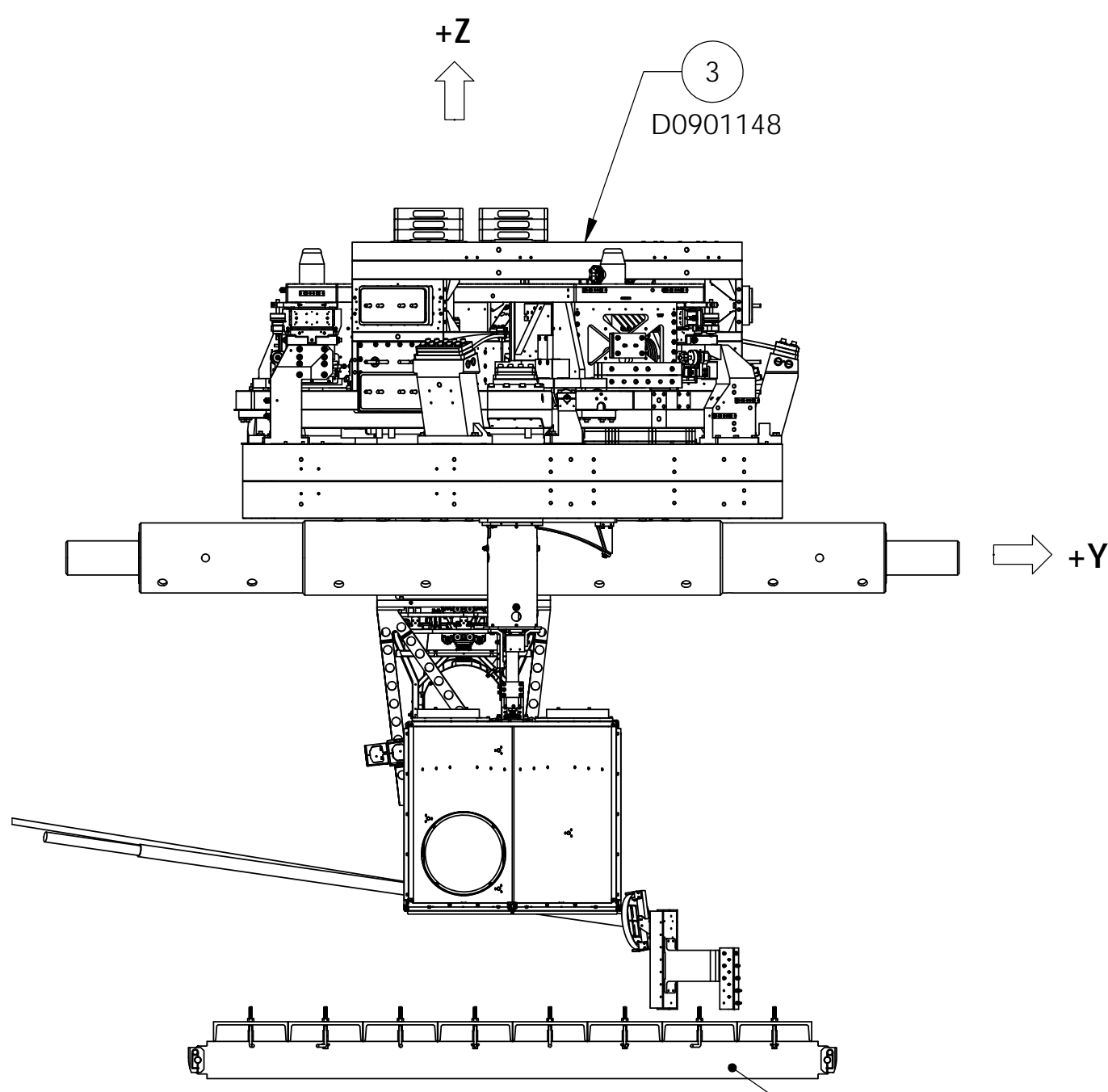
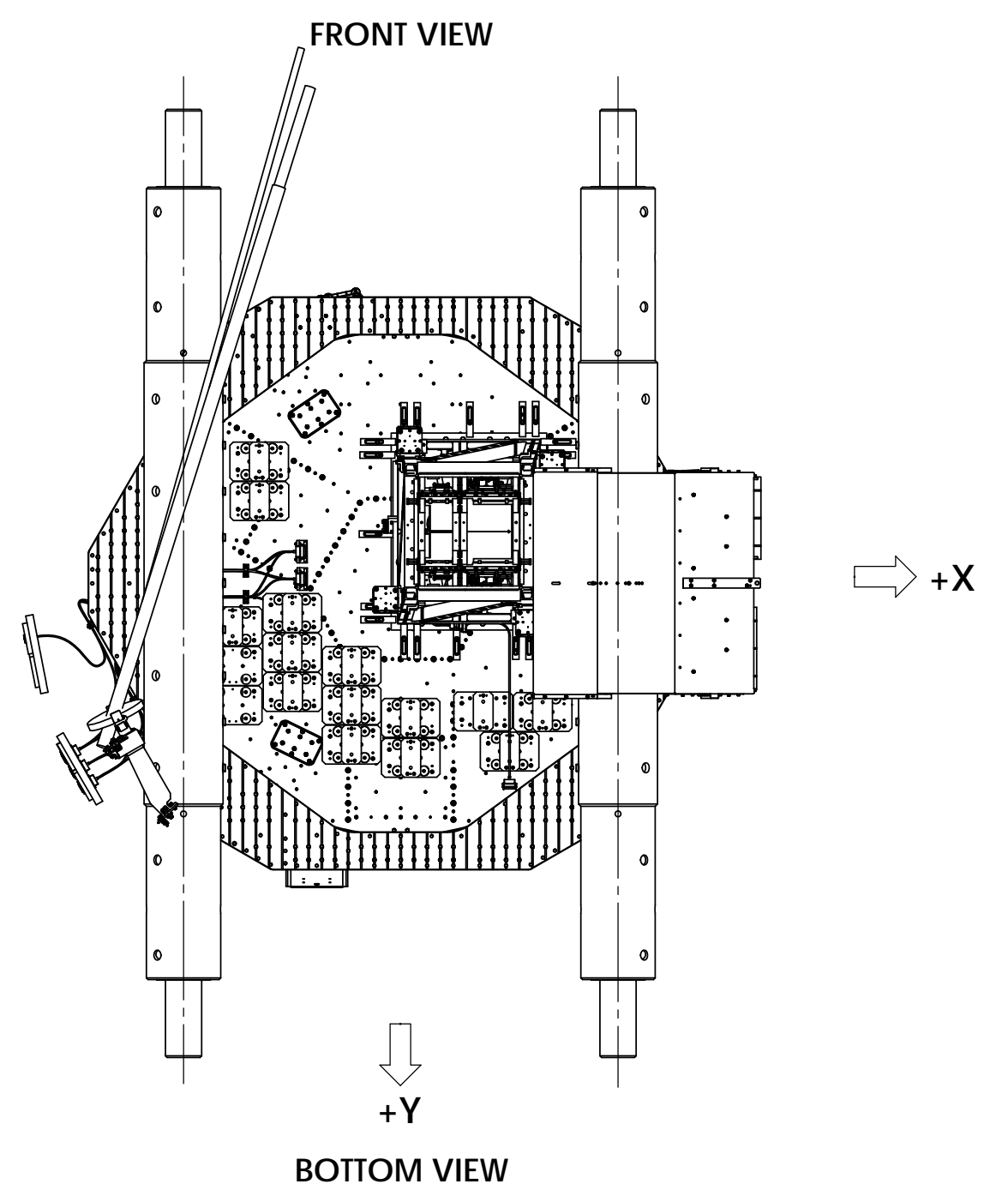
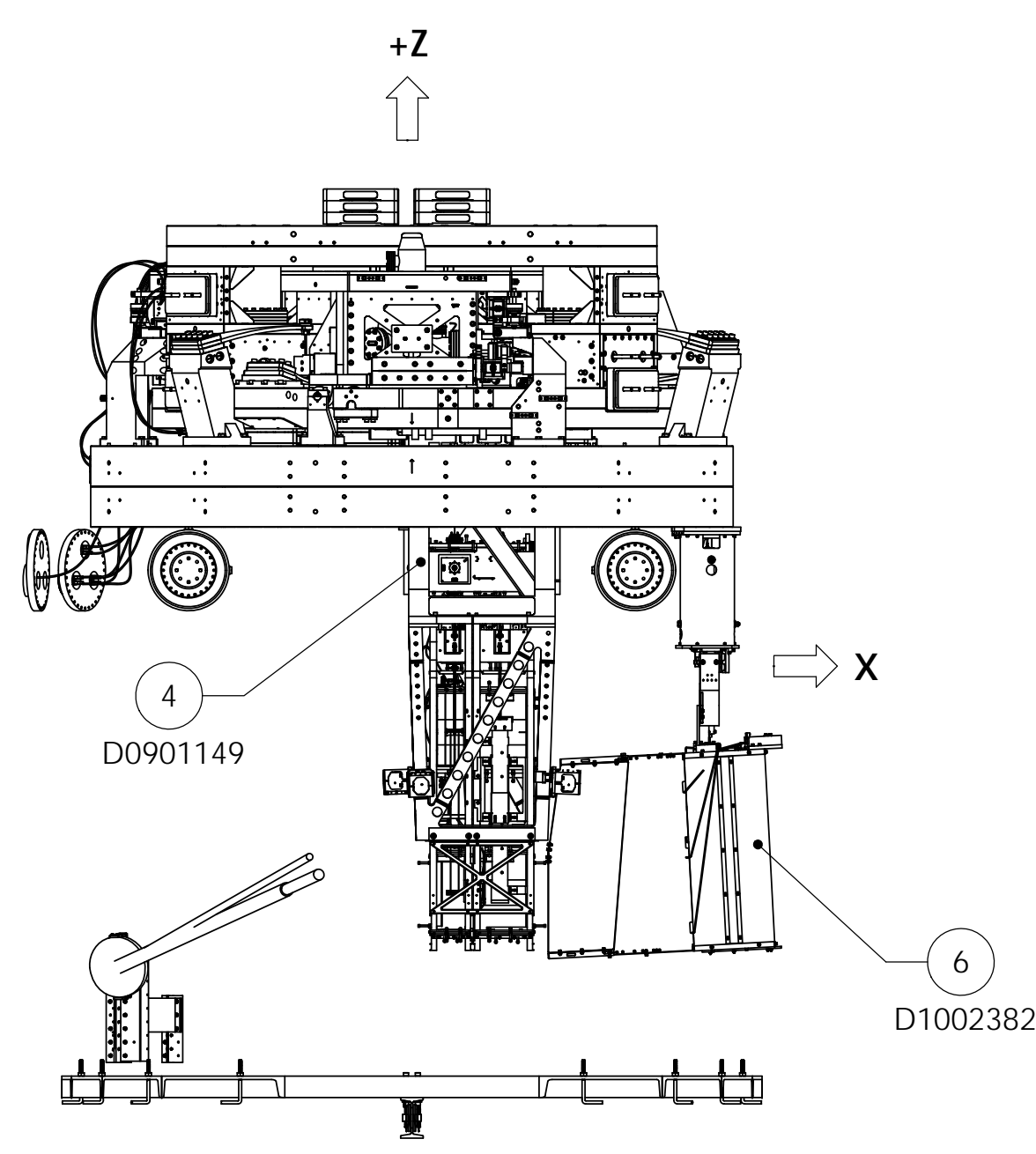
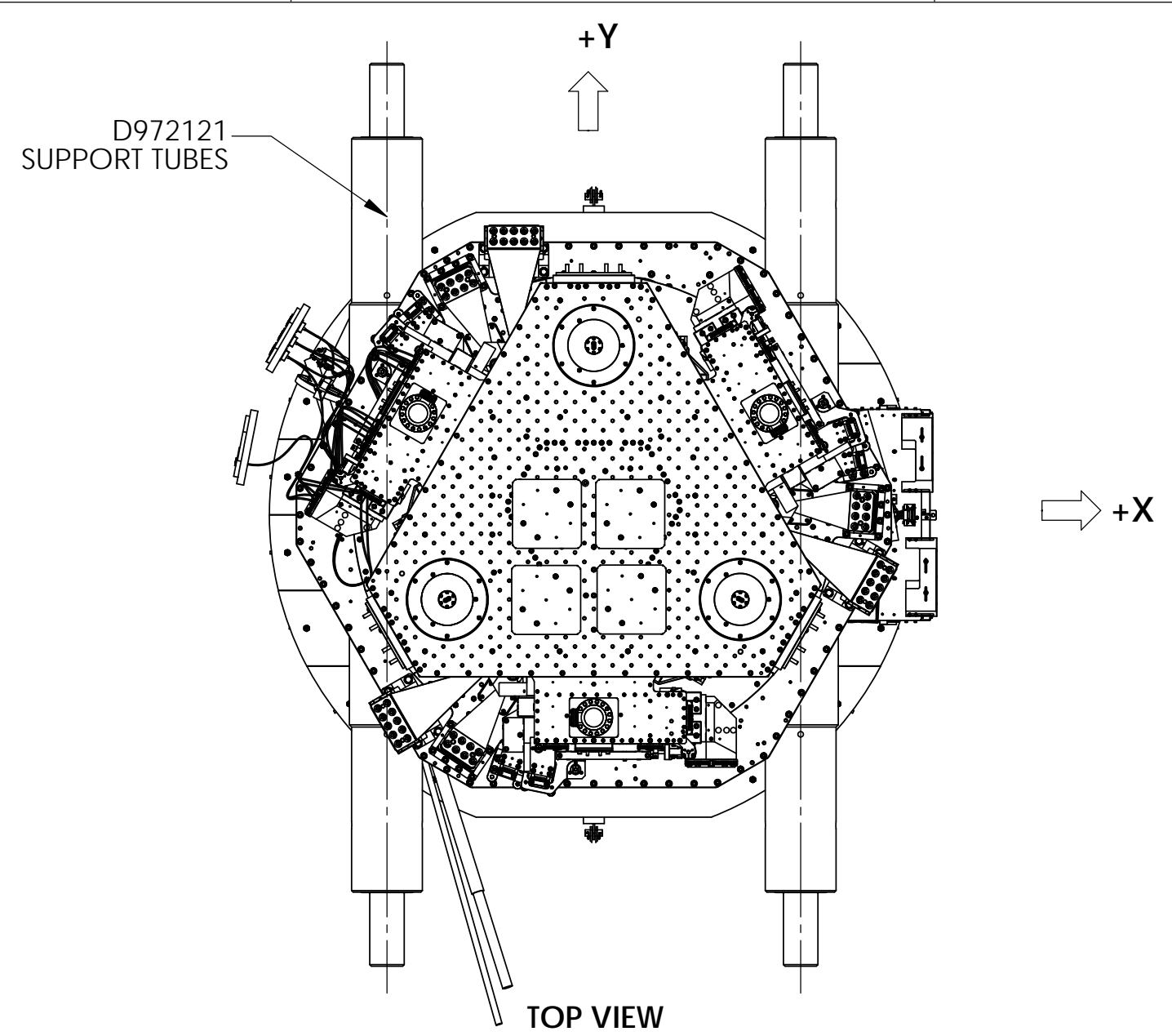

ITEM NO.	PART NUMBER	DESCRIPTION	MATERIAL	Full Complete /QTY.
8	D1201533	AdvLIGO SUS BSC3-H1, XYZ Local CS for TCS CO2P Steering Mirror Assembly	N/A	1
7	D1000513	HEPI ASSEMBLY, BSC aLIGO	SEE BOM	1
6	D1002382	AdvLIGO SUS BSC3-H1, XYZ Local CS for SLC Arm Cavity Baffle	--	1
5	D1002185	AdvLIGO BSC3-H1 ISI Table, Balance, Ballast & Trim Mass Assy	N/A	1
4	D0901149	AdvLIGO SUS BSC3-H1, XYZ Local CS for ITMX	--	1
3	D0901148	AdvLIGO SEI BSC3-H1, XYZ Local CS for ISI Table	N/A	1
2	D0901147	AdvLIGO VE BSC3-H1, Vacuum Equipment Assembly	N/A	1
1	D1200059	ALIGO, CABLE HARNESS ROUTING, BSC-3	N/A	1

LIGO CALIFORNIA INSTITUTE OF TECHNOLOGY
MASSACHUSETTS INSTITUTE OF TECHNOLOGY

SIZE DWG. NO. REV.
D D0901146 v5

SCALE: 1:25 PROJECTION: SHEET 2 OF 3

D0901146 AdvLIGO Systems, BSC3-H1 Top Level Chamber Assembly, ALL PART PDM REV. X-04B, DRAWING PDM REV. X-000

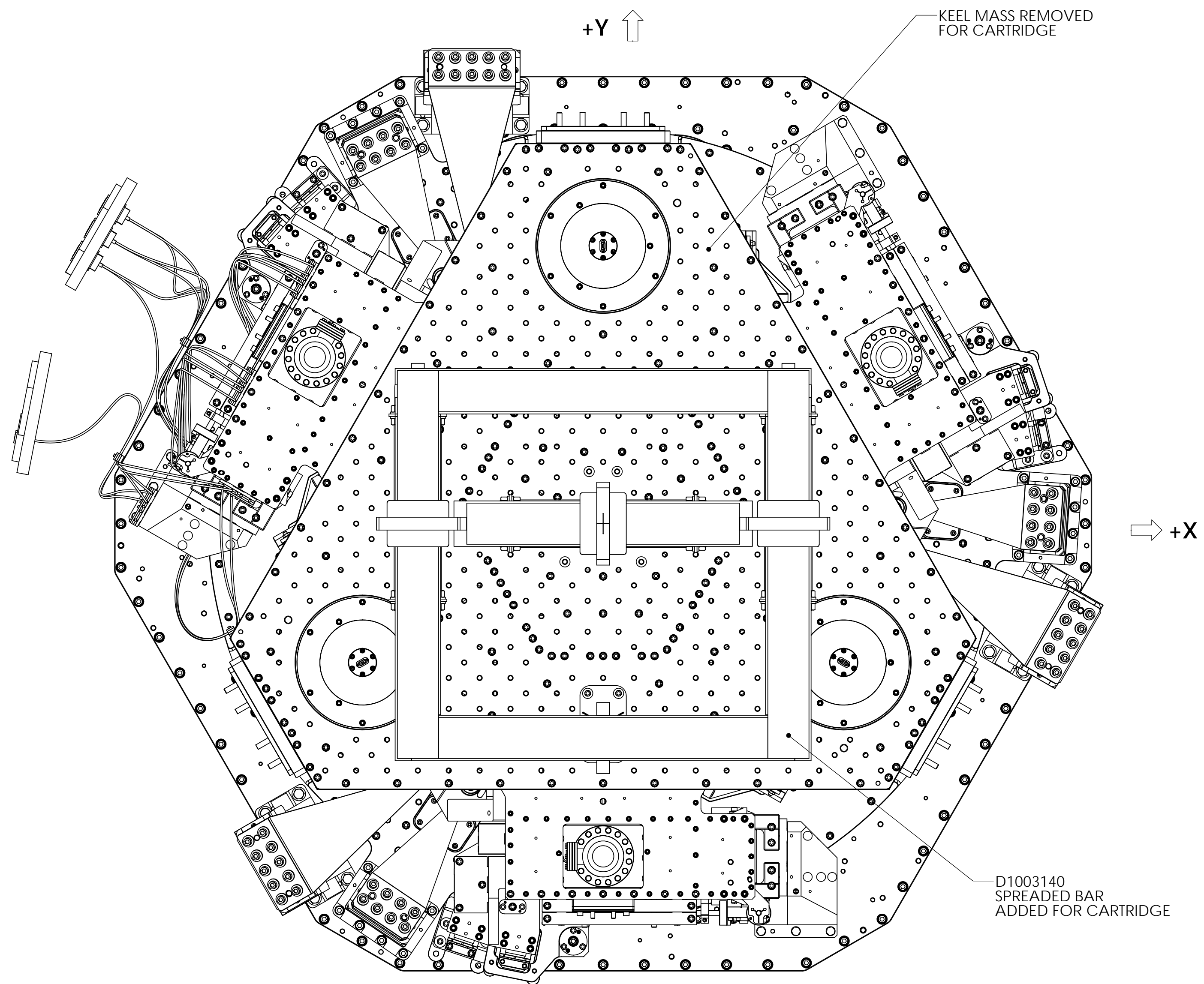

**TOP VIEW
(LOOKING DOWN)
CARTRIDGE ASSEMBLY CONFIGURATION
KEEL MASS REMOVED**

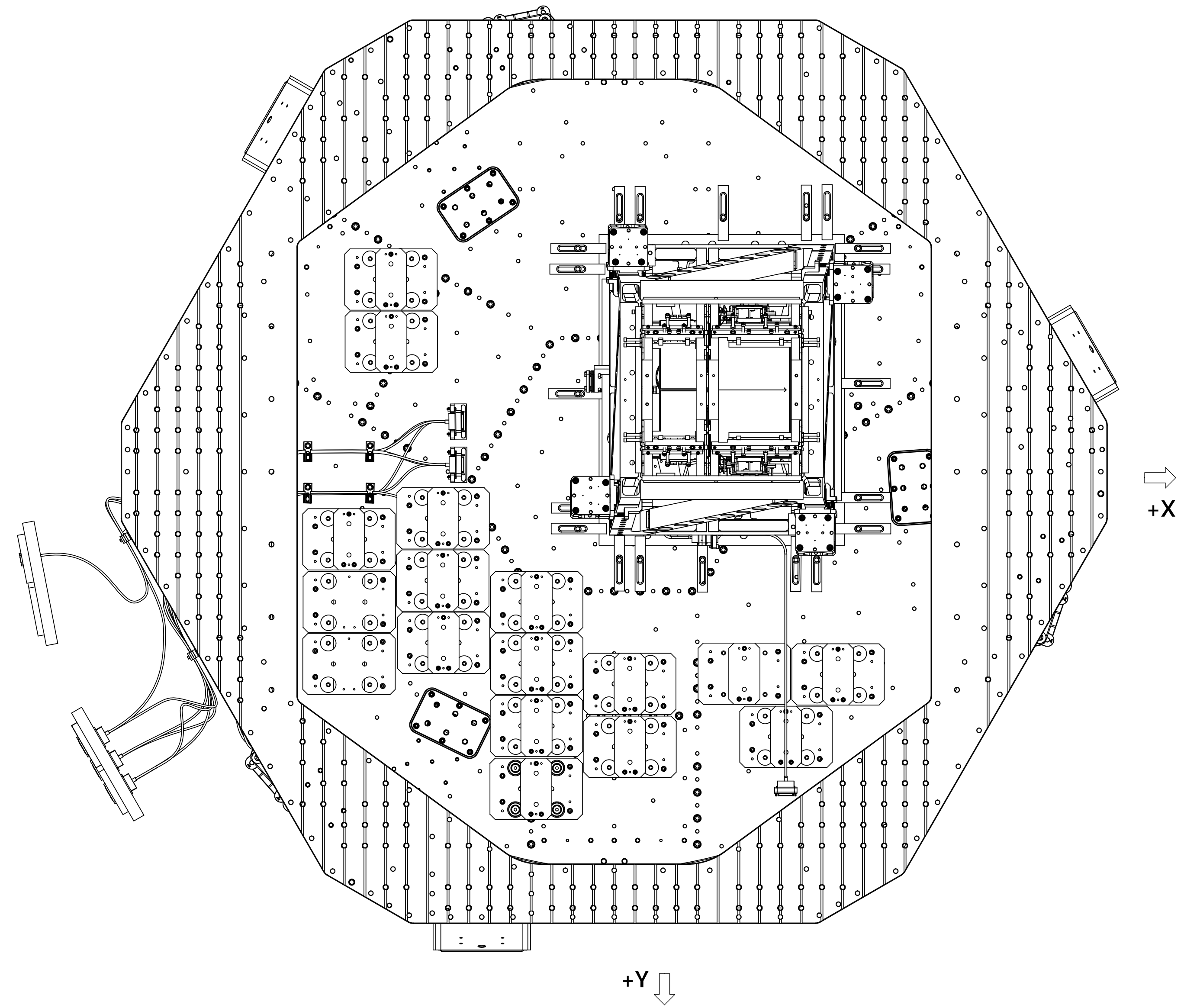

**BOTTOM VIEW
(LOOKING UP)**

D0901146-ADM-LIGO Systems: BCS3-H1 Top Level Chamber Assembly: ALL PART PDM REV. X-04B: DRAWING PDM REV. X-000