

4

3

2

1

NOTES CONTINUED:

- 5. BAG ALL ITEMS INDIVIDUALLY AND MARK OR TAG EACH BAG WITH DRAWING NUMBER, REVISION, AND QUANTITY. EXAMPLE: DXXXXXX-VY, QTY: 1
- 6. PART IS TO BE MADE FROM STOCK SOCKET HEAD CAP SCREW, 1/4-20 UNC-2A, FULLY THREADED.

REV.	DATE	DCN #	DRAWING TREE #
v1	08 MAY 2009	E0900129	-
-	-	-	-
-	-	-	-

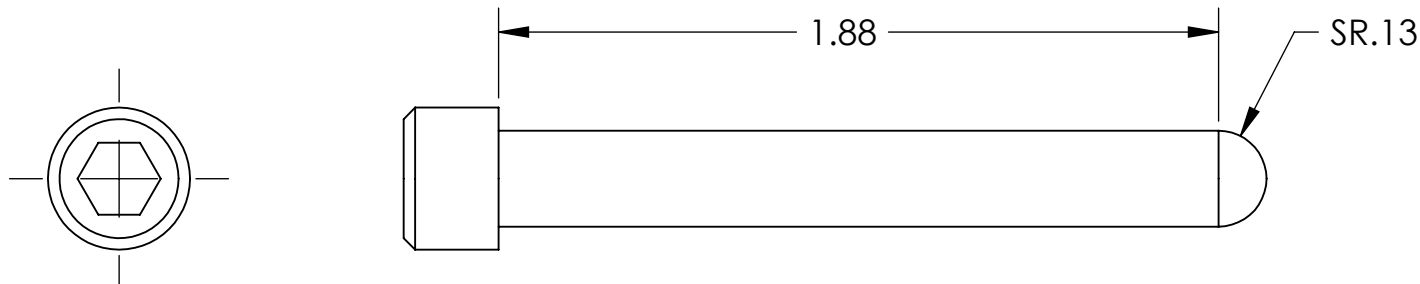

NOTES AND TOLERANCES: (UNLESS OTHERWISE SPECIFIED)

DIMENSIONS ARE IN INCHES

TOLERANCES:

.XX ± .01  
.XXX ± .005

ANGULAR ± 0.5°

1. INTERPRET DRAWING PER ASME Y14.5-1994.
2. REMOVE ALL SHARP EDGES, R.02 MIN.
3. DO NOT SCALE FROM DRAWING.
4. ALL MACHINING FLUIDS SHALL BE WATER SOLUBLE AND FREE OF SULFUR, CHLORINE AND SILICONE, SUCH AS CINCINNATI MILACRON'S CIMTECH 410.

MATERIAL Ag-PLATED 300 SSSL  
FINISH N/A μinch



SYSTEM ADVANCED LIGO  
SUB-SYSTEM  
NEXT ASSY MULTIPLE ASSYS

PART NAME				SCREW, SOCKET HEAD CAP, 1/4-20 UNC-2A X 2 LONG, FULLY THREADED, ROUNDED END			
DESIGNER		SIZE	DWG. NO.	REV.			
DRAFTER	D. BRIDGES	10 JUN 2009	A	D0901020	v1		
CHECKER	J. ROMIE	10 JUN 2009					
APPROVAL			SCALE: 2:1	PROJECTION:	SHEET 1 OF 1		

4

3

2

1