

NOTES CONTINUED:
 ⑤ SCRIBE, ENGRAVE, OR MECHANICALLY STAMP (NO INKS OR DYES) DRAWING PART NUMBER AND REVISION ON NOTED SURFACE FOLLOWED ON THE NEXT LINE BY A THREE DIGIT SERIAL NUMBER. SERIAL NUMBERS START AT 001 FOR THE FIRST ARTICLE AND PROCEED CONSECUTIVELY. USE .07" HIGH CHARACTERS. EXAMPLE: DXXXXXX-VY, S/N 001. A VIBRATORY TOOL MAY BE USED.

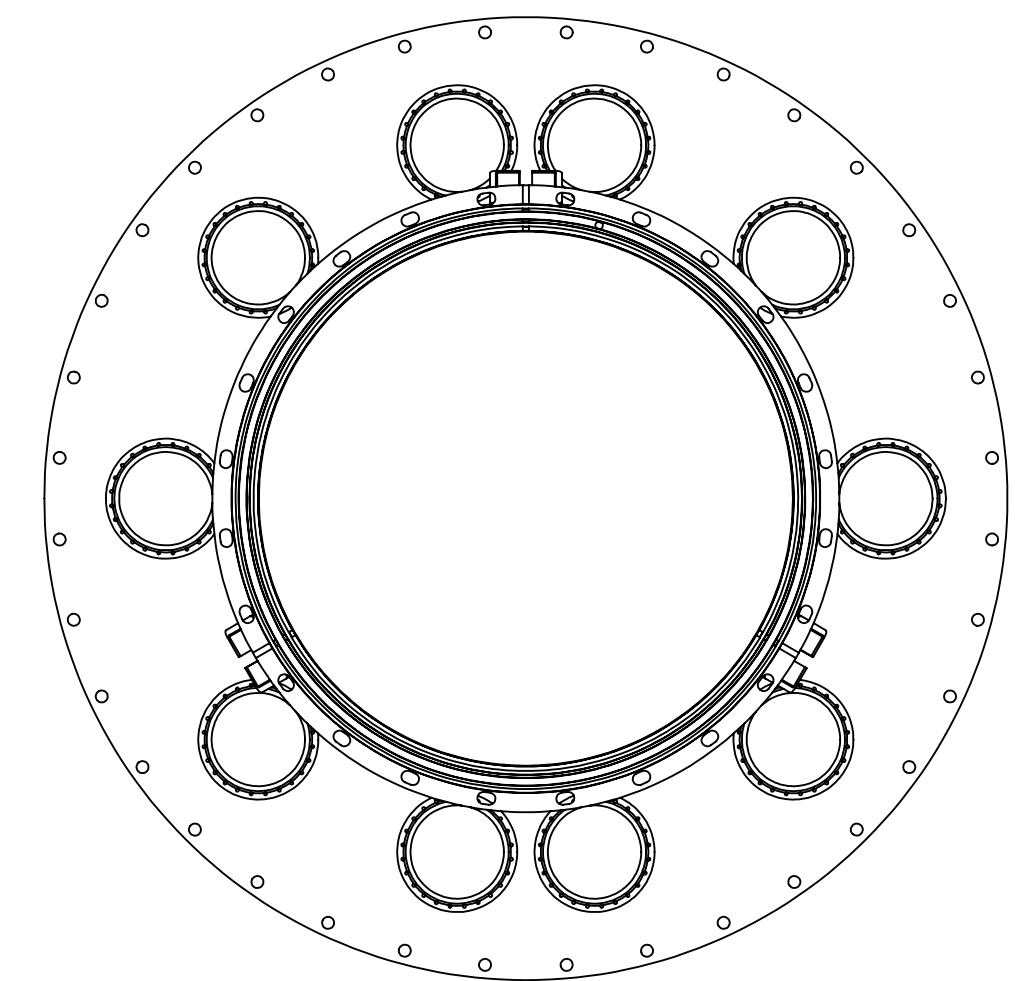

| REV. | DATE | DCN # | DRAWING TREE # |
|------|------|-------|----------------|
| - | - | - | - |
| - | - | - | - |
| - | - | - | - |

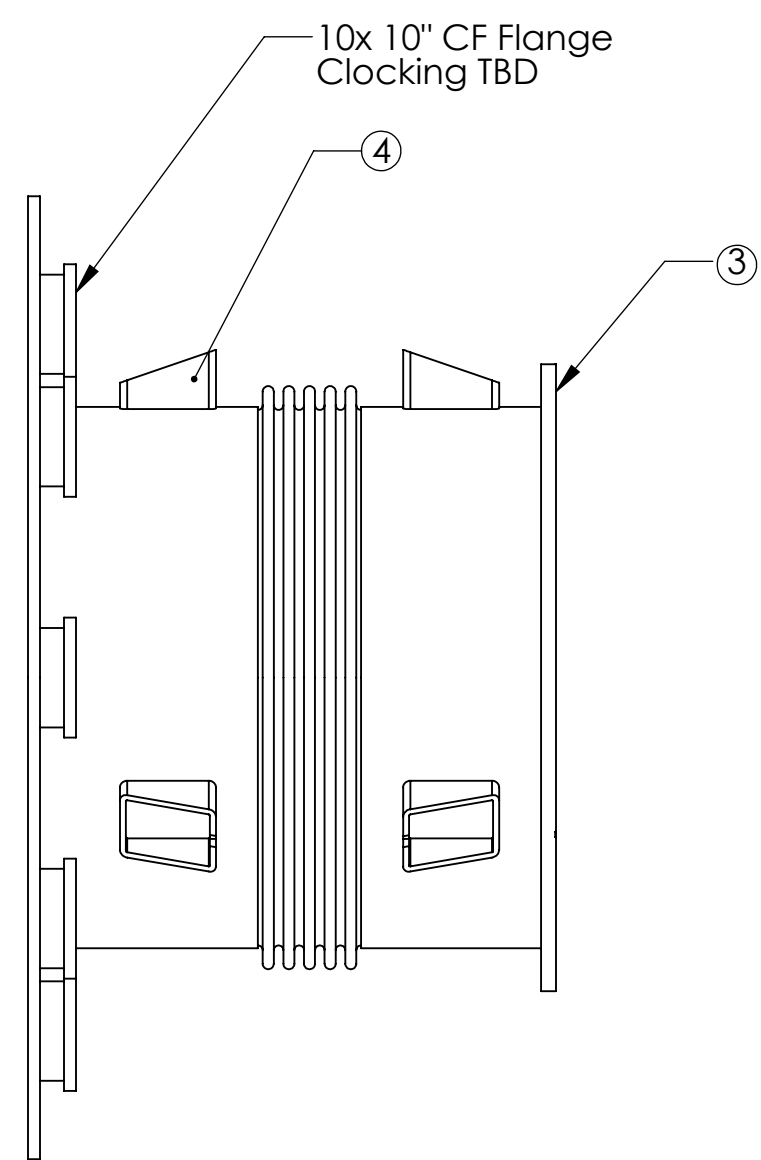
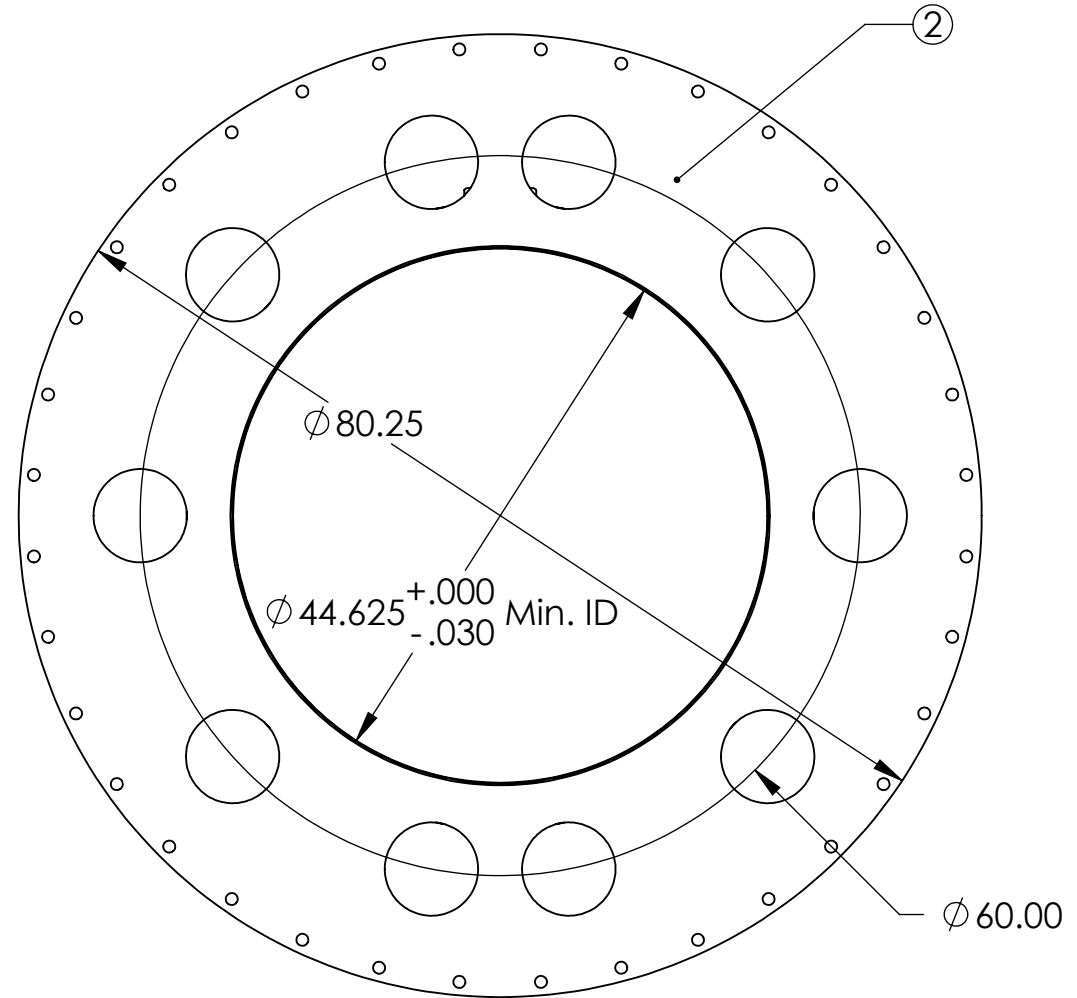
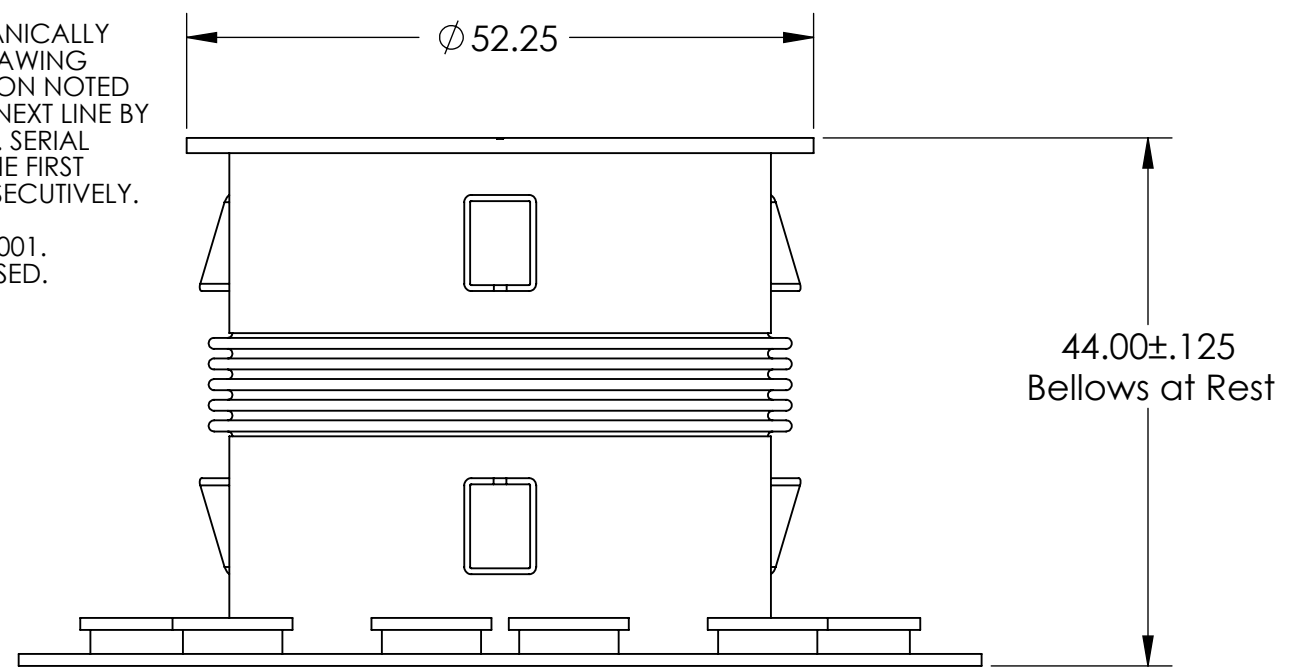
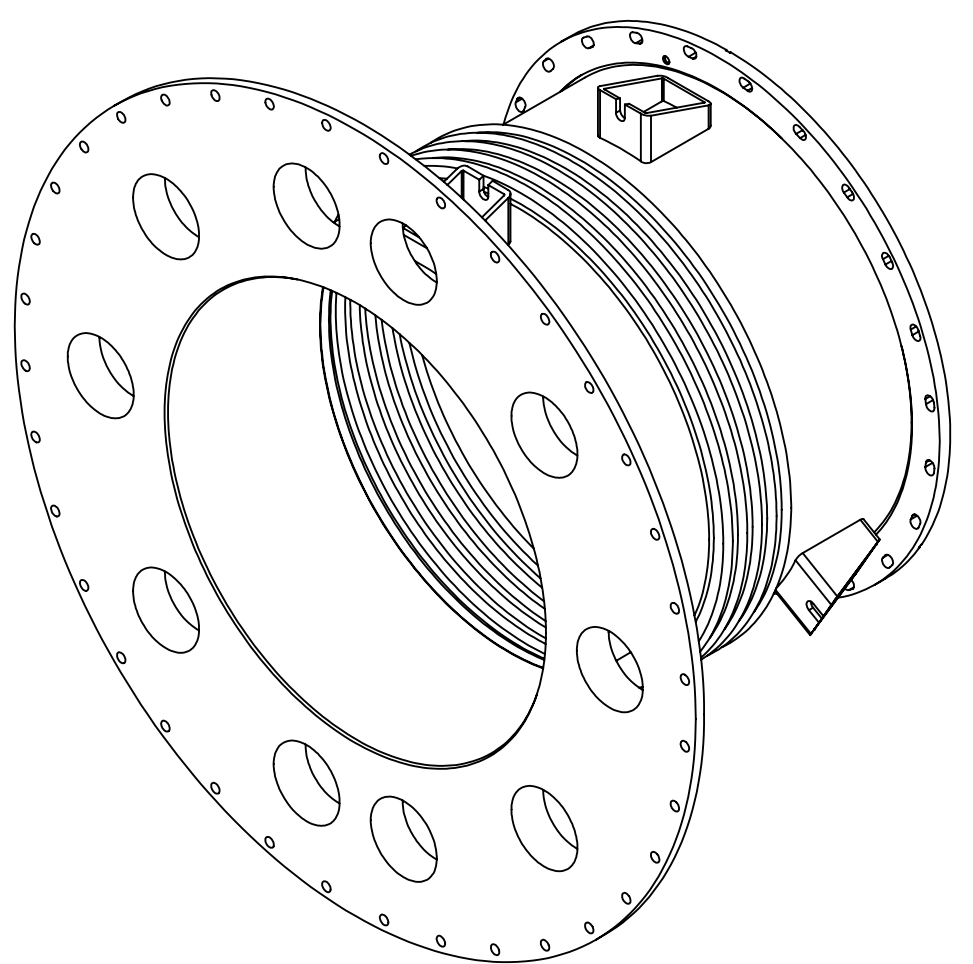

| 1 | D0900955 | Bellow Assembly, Adapter A-17, LIGO VE | AISI 304 | 1 | | 1 |
|--------|----------|---|----------|-----|-------|-------|
| 2 | D0900954 | Flat Faced Flange, 45.19ID x 80OD, LIGO VE, LIGO, PSI V049-4-47 rev 1 Modified to 80.25 OD, with 10 ports | AISI 304 | 1 | | 1 |
| 3 | D1000188 | Grooved and Slotted Flange, 44.625 ID | AISI 304 | 1 | | 1 |
| 4 | D0902727 | Tie Rod Bracket, VE Spools and Adapters, PSI V049-4-124 rev 0 | AISI 304 | 6 | | 6 |
| Item # | Part # | Description | Material | Req | Spare | Total |

NOTES AND TOLERANCES: (UNLESS OTHERWISE SPECIFIED)
 1. REMOVE ALL SHARP EDGES, R.02 MIN.
 2. DO NOT SCALE FROM DRAWING.
 3. DESIGN AND FABRICATE THIS COMPONENT PER LIGO SPECIFICATION E0900411-V1

MATERIAL: N/A
 FINISH: N/A μinch

LIGO CALIFORNIA INSTITUTE OF TECHNOLOGY
 MASSACHUSETTS INSTITUTE OF TECHNOLOGY

PART NAME: Adapter A-17, 44 5/8" I.D. x 72 1/4" I.D., LIGO VE

DESIGNER: [] SIZE DWG. NO.: c D0900947 REV.: 4

DRAFTER: []
 CHECKER: []
 APPROVAL: []

SCALE: 1:16 PROJECTION: [] SHEET 1 OF 1

DIMENSIONS ARE IN
 TOLERANCES:
 .XX ±
 .XXX ±
 ANGULAR ± °