

D080181_Advanced_LIGO_SUS_HLTS_Intermediate_Mass_Changer_Assembly, PART PDM REV: V1-000, DRAWING PDM REV: V1-000

REV.	DATE	DCN #	DRAWING TREE #
v1	24 JUN 2009	E0900176	E080191
v2	09 DEC 2010	E1000849	E080191
-	-	-	-

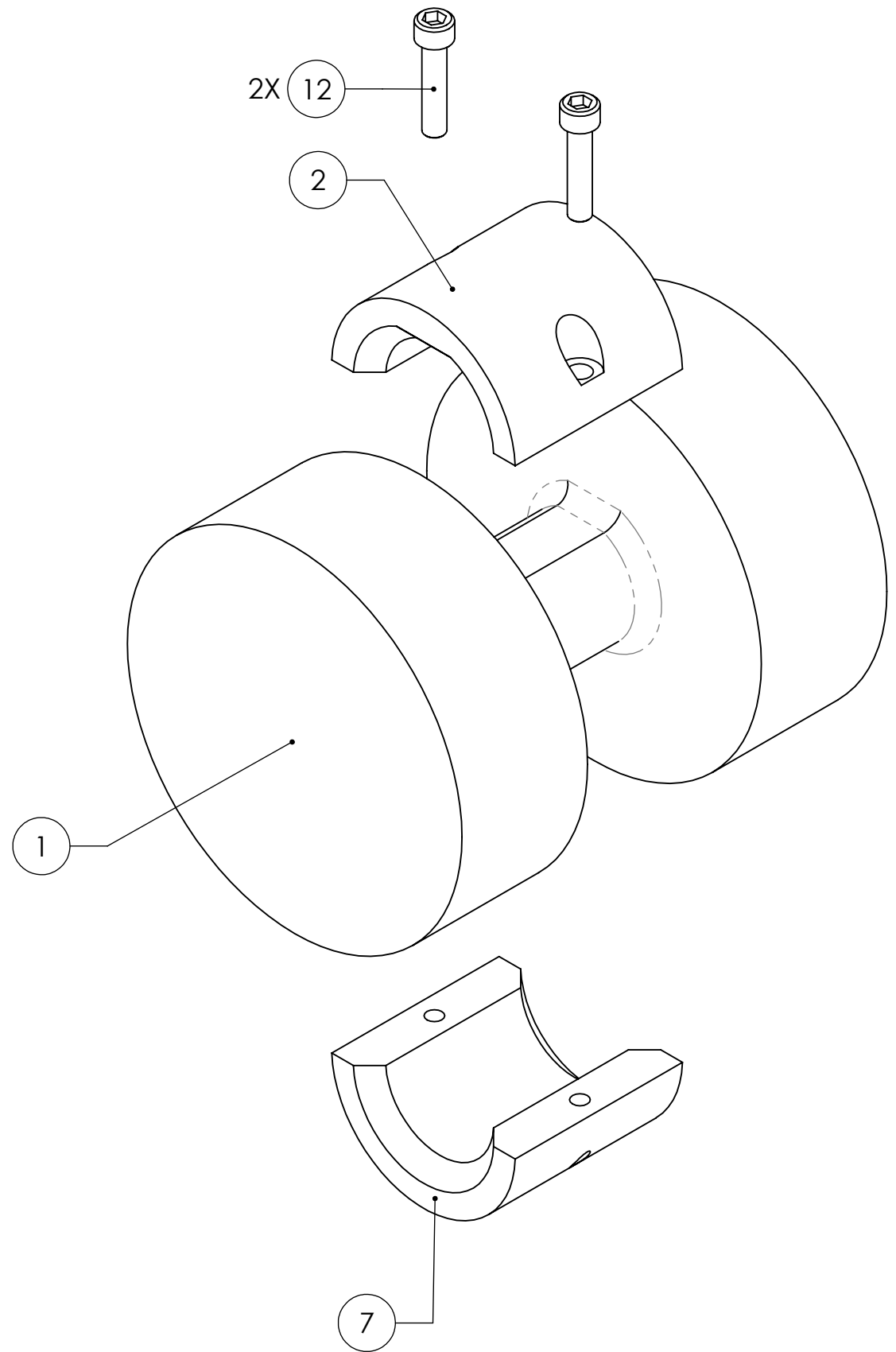

ITEM NO.	PART NUMBER	DESCRIPTION	MATERIAL	REQ	SPARE	TOTAL
13	-	SCREW, SOCKET HEAD CAP, #8-32 UNC-2A X 0.75 LONG	Ag-PLATED 300 SSSL	ALT	0	0
12	-	SCREW, SOCKET HEAD CAP, #8-32 UNC-2A X 0.75 LONG	300 SSSL	2	1	3
11	D080238	COLLAR, LOWER, 900g	304 SSSL	ALT	0	0
10	D080236	COLLAR, LOWER, 700g	304 SSSL	ALT	0	0
9	D080234	COLLAR, LOWER, 500g	304 SSSL	ALT	0	0
8	D080232	COLLAR, LOWER, 300g	6061-T6 Al	ALT	0	0
7	D080183	COLLAR, LOWER, 100g	6061-T6 Al	1	0	1
6	D080229	COLLAR, UPPER, 900g	304 SSSL	ALT	0	0
5	D080227	COLLAR, UPPER, 700g	304 SSSL	ALT	0	0
4	D080225	COLLAR, UPPER, 500g	304 SSSL	ALT	0	0
3	D080223	COLLAR, UPPER, 300g	6061-T6 Al	ALT	0	0
2	D080182	COLLAR, UPPER, 100g	6061-T6 Al	1	0	1
1	D030155	CENTER OFFSET	6061-T6 Al	1	0	1

NOTES AND TOLERANCES: (UNLESS OTHERWISE SPECIFIED)

- PARTS TO BE ASSEMBLED ACCORDING TO E080208 HLTS ASSEMBLY SPECIFICATION.
- 300 SSSL SOCKET HEAD CAP SCREWS ARE TO BE USED FOR ALUMINUM COLLARS. Ag-PLATED 300 SSSL SOCKET HEAD CAP SCREWS ARE TO BE USED FOR SSSL COLLARS.

MATERIAL	N/A	FINISH	N/A μinch
----------	-----	--------	-----------

CALIFORNIA INSTITUTE OF TECHNOLOGY MASSACHUSETTS INSTITUTE OF TECHNOLOGY		PART NAME INT. MASS CHANGER ASSY	
SYSTEM ADVANCED LIGO	SUB-SYSTEM SUS	DESIGNER D. BRIDGES	DATE 10 DEC 2010
NEXT ASSY INTERMEDIATE MASS ASSY	CHECKER B. MOORE	DATE 13 DEC 2010	SIZE DWG. NO. B D080181
		SCALE: 1:1	PROJECTION:
		REV. v2	
		SHEET 1 OF 1	