

D070436_Advanced_LIGO_SUS_HLTS_Lower_Loop_Wire_Assembly, PART PDM REV: V3-002, DRAWING PDM REV: V3-002

REV.	DATE	DCN #	DRAWING TREE #
v1	24 JUN 2009	E0900176	E080191
v2	03 SEP 2009	E0900277	E080191
v3	09 DEC 2010	E1000849	E080191
v4	24 OCT 2011	E1101053	E080191

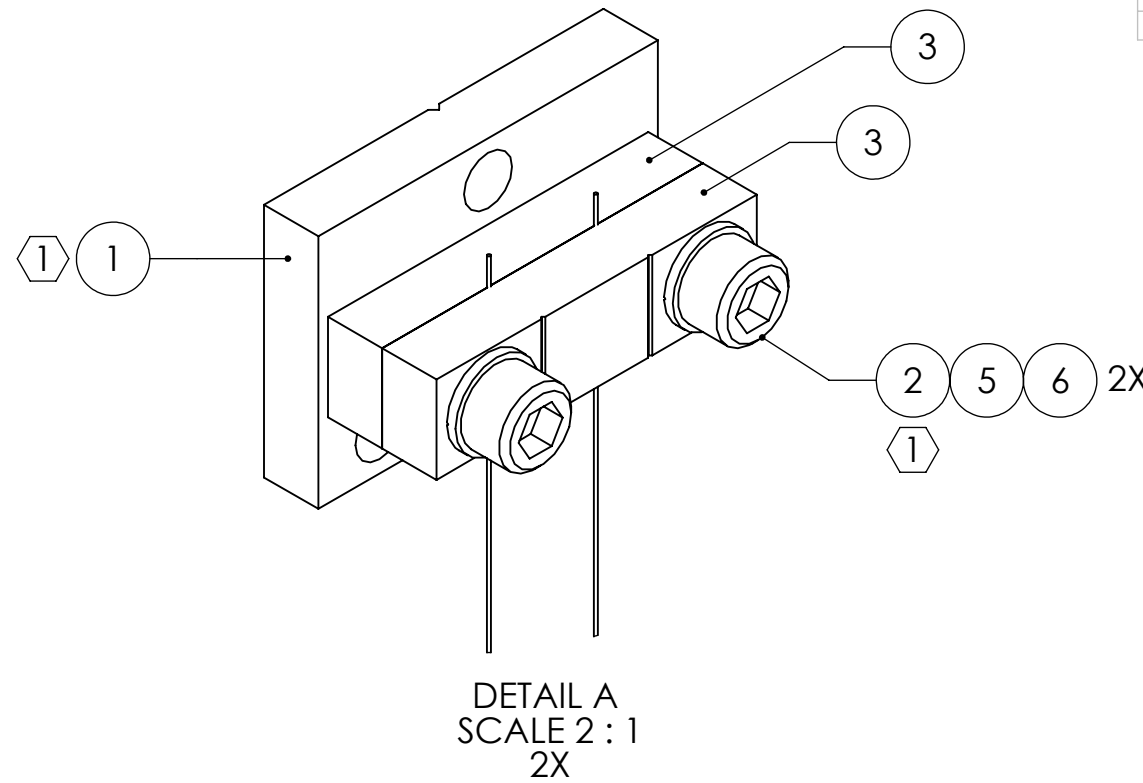
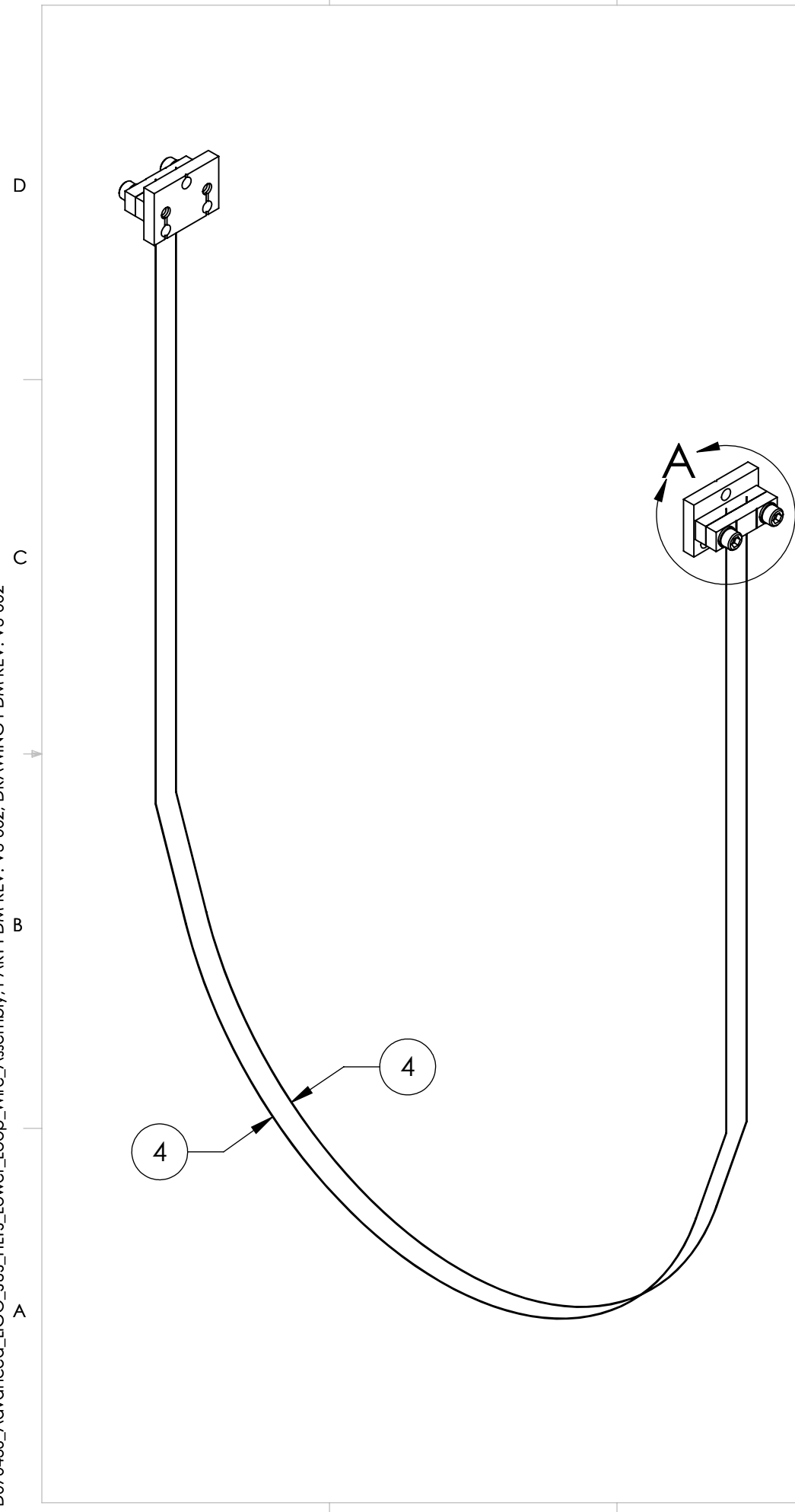

ITEM NO.	PART NUMBER	DESCRIPTION	MATERIAL	REQ	SPARE	TOTAL
6	-	WASHER, FLAT, VENTED, #8 (U-C COMPONENTS P/N WFV-08 OR EQUIVALENT)	300 SSSL	4	1	5
5	-	SCREW, SOCKET HEAD CAP, #8-32 UNC-2A X 0.5625 LONG	300 SSSL	4	1	5
4	-	LOWER LOOP WIRE, (ϕ 0.0106)	STEEL MUSIC WIRE	A/R	0	0
3	D070438	CLAMP, LOWER LOOP WIRE	304, 316 OR 302 SSSL	4	0	4
2	1185-2EN164	HELICOIL, #8-32 X 0.164 LONG $\text{\textcircled{1}}$	NITRONIC 60	4	2	6
1	D030148	BREAKOFF, INT. MASS, LOWER LOOP WIRE $\text{\textcircled{1}}$	6061-T6 AI	2	0	2

PARTS LIST

NOTES AND TOLERANCES: (UNLESS OTHERWISE SPECIFIED)

- ① HELICOILS TO BE INSTALLED INTO ITEM NO. 1 BY LIGO PRIOR TO ASSEMBLY AND AFTER ALL PARTS ARE CLEANED AND BAKED.
- 2. PARTS TO BE ASSEMBLED ACCORDING TO E080208 HLTS ASSEMBLY SPECIFICATION, USING D0901419 HLTS LOWER LOOP WIRE JIG ASSEMBLY.
- 3. MASS TO SUSPEND DURING ASSEMBLY: 6.071 kg FOR EACH OF TWO WIRES.

MATERIAL	N/A	FINISH	N/A μ inch
----------	-----	--------	----------------

CALIFORNIA INSTITUTE OF TECHNOLOGY MASSACHUSETTS INSTITUTE OF TECHNOLOGY		PART NAME		LOWER LOOP WIRE ASSY	
SYSTEM	ADVANCED LIGO	SUB-SYSTEM	SUS	DESIGNER	D. BRIDGES 27 OCT 2011
NEXT ASSY	HLTS SUSPENSION ASSY	CHECKER	B. MOORE 27 OCT 2011	SIZE	DWG. NO. B
			APPROVAL	REV.	v4
			SCALE: 1:2	PROJECTION:	SHEET 1 OF 1