

REV.	DATE	DCN #	DRAWING TREE #
v1	24 JUN 2009	E0900176	E080191
v2	03 SEP 2009	E0900277	E080191
v3	18 MAY 2010	E1000166	E080191
v4	12 FEB 2012	E1200212	E080191

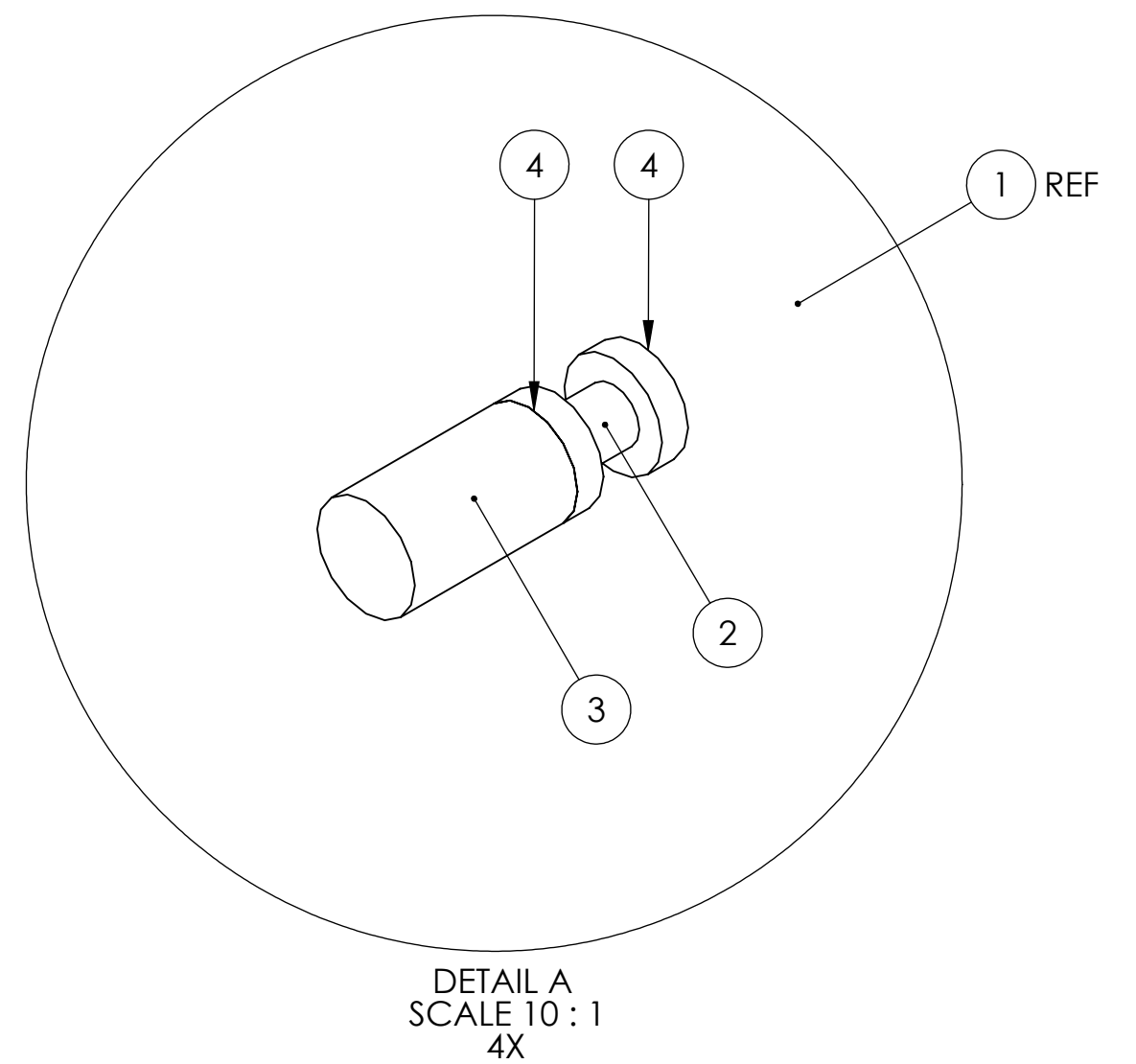
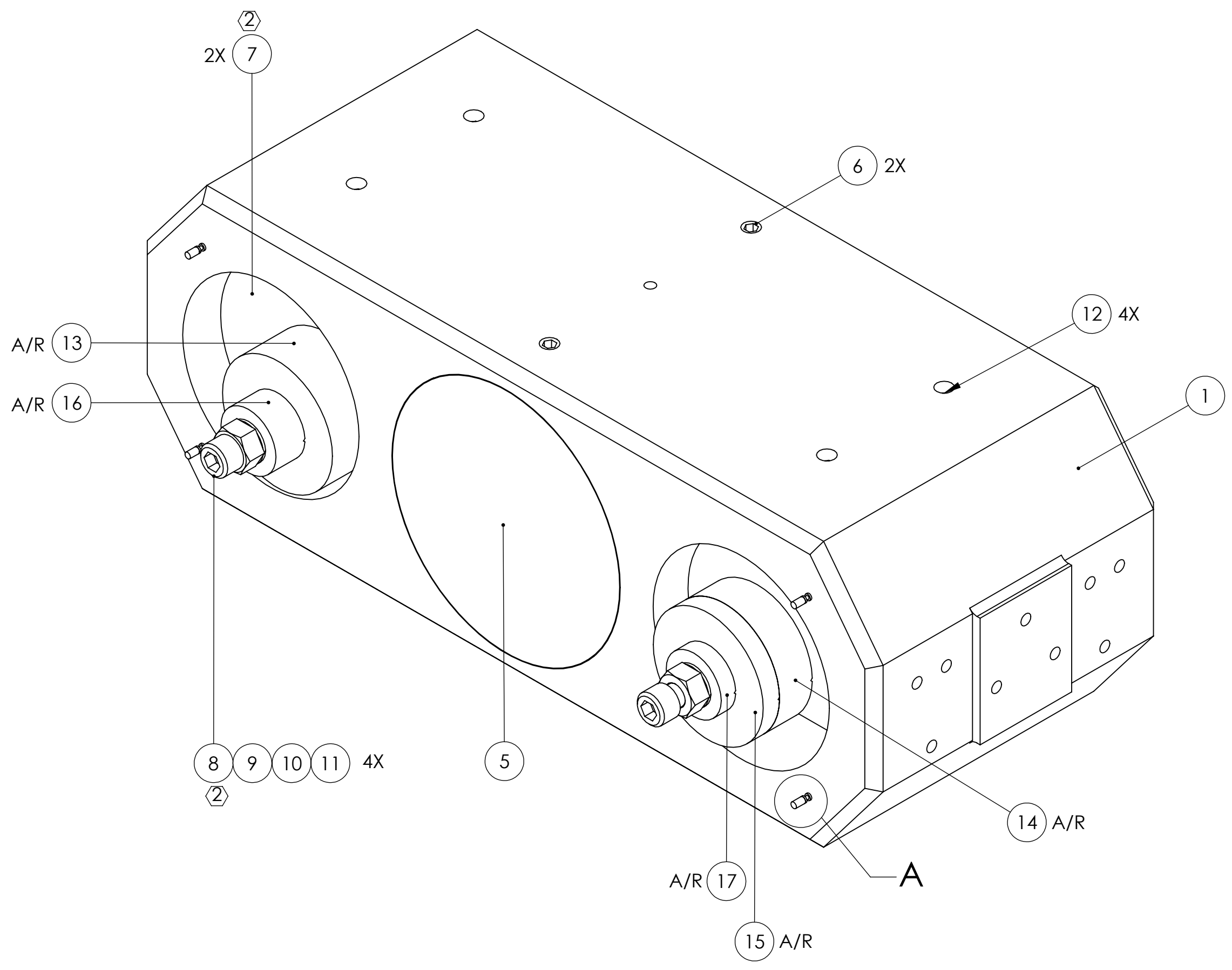

ITEM NO.	PART NUMBER	DESCRIPTION	MATERIAL	REQ	SPARE	TOTAL
17	D1001230	ADDITIONAL MASS DISK, 10g	304, 316 OR 302 SSSL	A/R	0	0
16	D1001229	ADDITIONAL MASS DISK, 20g	304, 316 OR 302 SSSL	A/R	0	0
15	D0901405	ADDITIONAL MASS DISK, 50g	304, 316 OR 302 SSSL	A/R	0	0
14	D070333	ADDITIONAL MASS DISK, 100g	304, 316 OR 302 SSSL	A/R	0	0
13	D080263	ADDITIONAL MASS DISK, 150g	304, 316 OR 302 SSSL	A/R	0	0
12	-	SCREW, SOCKET SET, 1/4-20 UNC-2A X 0.5 LONG	Ag-PLATED 300 SSSL	4	1	5
11	-	HEX NUT, 1/4-20	Ag-PLATED 300 SSSL	4	1	5
10	-	WASHER, FLAT, VENTED, 1/4 (U-C COMPONENTS P/N WFV-25 OR EQUIVALENT)	300 SSSL	4	1	5
9	-	SCREW, SOCKET HEAD CAP, 1/4-20 UNC-2A X 1.5 LONG, FULLY THREADED	300 SSSL	4	1	5
8	3585-4EN250	SCREW-LOCK HELICOIL, 1/4-20 X 0.25 LONG(2)	NITRONIC 60	4	2	6
7	D030156	SIDE OFFSET(2)	6061-T6 Al	2	0	2
6	-	SCREW, SOCKET SET, 1/4-20 UNC-2A X 0.25 LONG	Ag-PLATED 300 SSSL	2	1	3
5	D080181	INT. MASS CHANGER ASSY	N/A	1	0	1
4	-	UHV-COMPATIBLE ADHESIVE (MASTERBOND EP30-2 OR EQUIVALENT)	-	A/R	0	0
3	D0901927	SINTERED SmCo MAGNET, $\phi$ 0.075 X 0.125 LONG	SmCo 2:17	4	1	5
2	D970075	DUMBBELL STANDOFF	6061-T6 Al	4	1	5
1	D070336	MAIN SECTION	304, 316 OR 302 SSSL	1	0	1

**NOTES AND TOLERANCES: (UNLESS OTHERWISE SPECIFIED)**

1. PARTS TO BE ASSEMBLED ACCORDING TO E080208 HLTS ASSEMBLY SPECIFICATION, USING D0901461 HLTS INTERMEDIATE MASS MAGNET PLACEMENT FIXTURE.

(2) HELICOILS TO BE INSTALLED INTO ITEM NO. 7 BY LIGO PERSONNEL PRIOR TO ASSEMBLY AND AFTER ALL PARTS ARE CLEANED AND BAKED.

**MATERIAL** N/A

**FINISH** N/A  $\mu$ inch

**LIGO** CALIFORNIA INSTITUTE OF TECHNOLOGY  
 MASSACHUSETTS INSTITUTE OF TECHNOLOGY

SYSTEM: **ADVANCED LIGO**      SUB-SYSTEM: **SUS**

NEXT ASSY: **HLTS SUSPENSION ASSY**

PART NAME: **INTERMEDIATE MASS ASSY**

DESIGNER	D. BRIDGES	18 FEB 2012	SIZE	DWG. NO.	REV.
DRAFTER	D. BRIDGES	18 FEB 2012	c	<b>D070334</b>	v4
CHECKER	B. MOORE	21 FEB 2012			
APPROVAL			SCALE: 1:1	PROJECTION:	SHEET 1 OF 1