

D070308\_Advanced\_LIGO\_SUS\_HLTS\_Top\_Blade\_Guard\_Assembly, PART PDM REV: V2-001, DRAWING PDM REV: V2-000

REV.	DATE	DCN #	DRAWING TREE #
v1	26 MAY 2009	E0900159	E080191
v2	10 AUG 2010	E1000301	E080191
v3	12 FEB 2012	E1200212	E080191

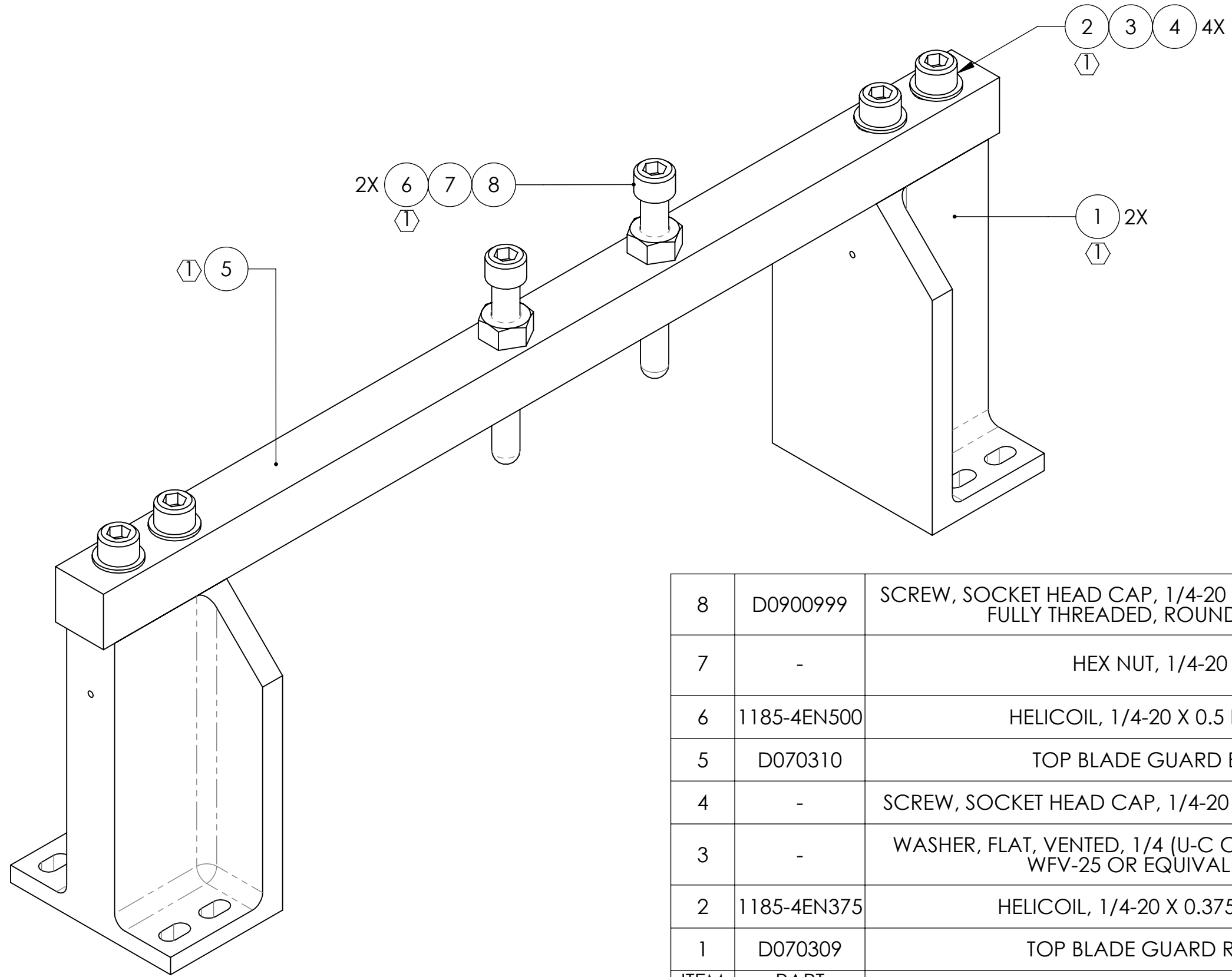

ITEM NO.	PART NUMBER	DESCRIPTION	MATERIAL	REQ	SPARE	TOTAL
8	D0900999	SCREW, SOCKET HEAD CAP, 1/4-20 UNC-3A X 2 LONG, FULLY THREADED, ROUNDED END	300 SSTL	2	1	3
7	-	HEX NUT, 1/4-20	Ag-PLATED 300 SSTL	2	1	3
6	1185-4EN500	HELICOIL, 1/4-20 X 0.5 LONG (T)	NITRONIC 60	2	1	3
5	D070310	TOP BLADE GUARD BAR (T)	6061-T6 Al	1	0	1
4	-	SCREW, SOCKET HEAD CAP, 1/4-20 UNC-2A X 1 LONG	300 SSTL	4	1	5
3	-	WASHER, FLAT, VENTED, 1/4 (U-C COMPONENTS P/N WFV-25 OR EQUIVALENT)	300 SSTL	4	1	5
2	1185-4EN375	HELICOIL, 1/4-20 X 0.375 LONG (T)	NITRONIC 60	4	2	6
1	D070309	TOP BLADE GUARD RISER (T)	6061-T6 Al	2	0	2
<b>PARTS LIST</b>						

**NOTES AND TOLERANCES: (UNLESS OTHERWISE SPECIFIED)**

(T) HELICOILS TO BE INSTALLED INTO ITEM NO. 1 AND ITEM NO. 5 BY LIGO PRIOR TO ASSEMBLY AND AFTER ALL PARTS ARE CLEANED AND BAKED.  
 2. PARTS TO ASSEMBLED ACCORDING TO E080208 HLTS ASSEMBLY SPECIFICATION.

**MATERIAL** N/A **FINISH** N/A μinch

CALIFORNIA INSTITUTE OF TECHNOLOGY MASSACHUSETTS INSTITUTE OF TECHNOLOGY		<b>PART NAME</b> TOP BLADE GUARD ASSY	
<b>SYSTEM</b> ADVANCED LIGO	<b>SUB-SYSTEM</b> SUS	<b>DESIGNER</b> D. BRIDGES 28 FEB 2012	<b>SIZE DWG. NO.</b> B D070308
<b>DRAFTER</b> D. BRIDGES 28 FEB 2012	<b>CHECKER</b> B. MOORE 28 FEB 2012	<b>APPROVAL</b>	<b>REV.</b> v3
<b>NEXT ASSY</b> HLTS OVERALL ASSY		SCALE: 1:1	PROJECTION:  SHEET 1 OF 1