

D070308_Advanced_LIGO_SUS_HLTS_Top_Blade_Guard_Assembly, PART PDM REV: V1-001, DRAWING PDM REV: V1-002

REV.	DATE	DCN #	DRAWING TREE #
v1	26 MAY 2009	E0900159	E080191
v2	10 AUG 2010	E1000301	E080191
-	-	-	-

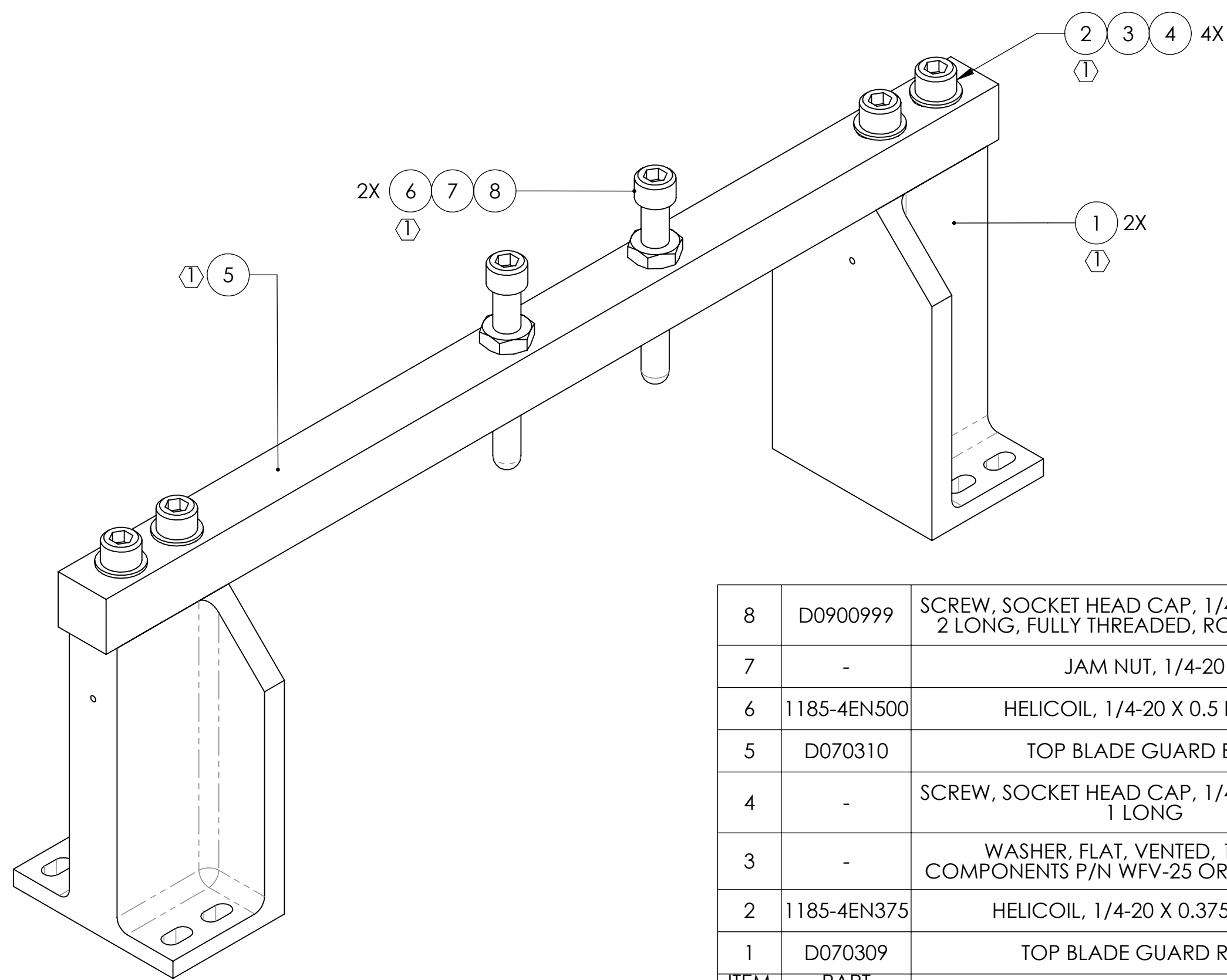

ITEM NO.	PART NUMBER	DESCRIPTION	MATERIAL	REQ	SPARE	TOTAL
8	D0900999	SCREW, SOCKET HEAD CAP, 1/4-20 UNC-3A X 2 LONG, FULLY THREADED, ROUNDED END	300 SSSL	2	1	3
7	-	JAM NUT, 1/4-20	300 SSSL	2	1	3
6	1185-4EN500	HELICOIL, 1/4-20 X 0.5 LONG (T)	NITRONIC 60	2	1	3
5	D070310	TOP BLADE GUARD BAR (T)	6061-T6 Al	1	0	1
4	-	SCREW, SOCKET HEAD CAP, 1/4-20 UNC-2A X 1 LONG	300 SSSL	4	1	5
3	-	WASHER, FLAT, VENTED, 1/4 (U-C COMPONENTS P/N WFV-25 OR EQUIVALENT)	300 SSSL	4	1	5
2	1185-4EN375	HELICOIL, 1/4-20 X 0.375 LONG (T)	NITRONIC 60	4	2	6
1	D070309	TOP BLADE GUARD RISER (T)	6061-T6 Al	2	0	2

PARTS LIST

NOTES AND TOLERANCES: (UNLESS OTHERWISE SPECIFIED)

(T) HELICOILS TO BE INSTALLED INTO ITEM NO. 1 AND ITEM NO. 5 BY LIGO PRIOR TO ASSEMBLY AND AFTER ALL PARTS ARE CLEANED AND BAKED.
 2. PARTS TO ASSEMBLED ACCORDING TO E080208 HLTS ASSEMBLY SPECIFICATION.

LIGO CALIFORNIA INSTITUTE OF TECHNOLOGY
 MASSACHUSETTS INSTITUTE OF TECHNOLOGY

MATERIAL N/A **FINISH** N/A μinch

SYSTEM ADVANCED LIGO **SUB-SYSTEM** SUS
NEXT ASSY HLTS OVERALL ASSY

PART NAME			TOP BLADE GUARD ASSY		
DESIGNER	D. BRIDGES	23 AUG 2010	SIZE	DWG. NO.	REV.
DRAFTER	D. BRIDGES	24 AUG 2010	B	D070308	v2
CHECKER	B. MOORE	25 AUG 2010	SCALE:	1:1	PROJECTION:
APPROVAL					SHEET 1 OF 1