

NOTES CONTINUED:

5. PART IS TO BE MADE FROM STOCK  
 SOCKET HEAD CAP SCREW, 1/4-20  
 UNC-2A, FULLY THREADED.

REV.	DATE	DCN #	DRAWING TREE #
A	JUL 2004	E040303	-
B	30 MAY 2008	E080195	-
v1	8 MAY 2009	E0900129	-

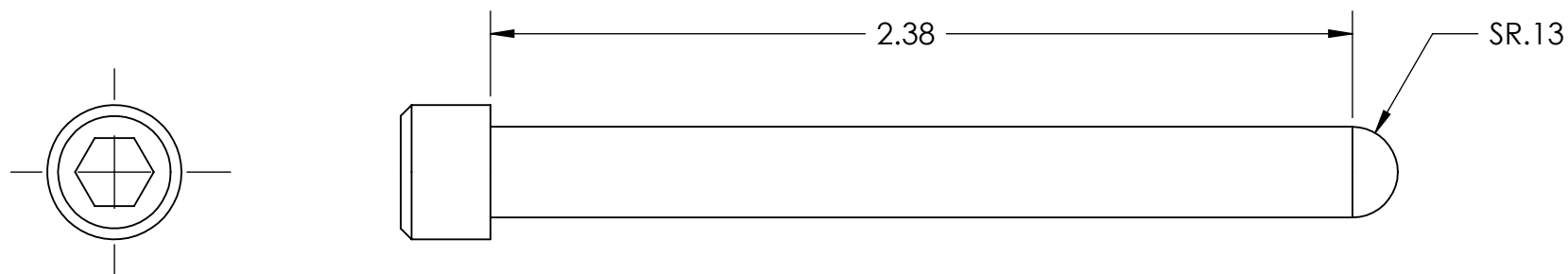

NOTES AND TOLERANCES: (UNLESS OTHERWISE SPECIFIED)

DIMENSIONS ARE IN INCHES

TOLERANCES:  
 .XX ± .01  
 .XXX ± .005

ANGULAR ± 0.1°

1. INTERPRET DRAWING PER ASME Y14.5-1994.
2. REMOVE ALL SHARP EDGES, R.02 MIN.
3. DO NOT SCALE FROM DRAWING.
4. ALL MACHINING FLUIDS SHALL BE WATER SOLUBLE AND FREE OF SULFUR, CHLORINE AND SILICONE, SUCH AS CINCINNATI MILACRON'S CIMTECH 410.

MATERIAL: 300 SSSL  
 FINISH: N/A μinch



SYSTEM: ADVANCED LIGO  
 SUB-SYSTEM:

NEXT ASSY: MULTIPLE ASSYS

PART NAME: SCREW, SOCKET HEAD CAP, 1/4-20 UNC-2A X 2.5 LONG, FULLY THREADED, ROUNDED END

DESIGNER		SIZE	DWG. NO.	REV.
DRAFTER	D. BRIDGES 8 MAY 2009	A	D030021	v1
CHECKER	M. MEYER 8 MAY 2009	SCALE: 2:1		PROJECTION:
APPROVAL		SHEET 1 OF 1		