

NOTES CONTINUED:
 5. SCRIBE, ENGRAVE (A VIBRATORY TOOL MAY BE USED), LASER MARK OR MECHANICALLY STAMP (NO INKS OR DYES) DRAWING PART NUMBER, REVISION (AND VARIANT OR 'TYPE' IF APPLICABLE) ON NOTED SURFACE OF PART FOLLOWED ON THE NEXT LINE WITH A THREE DIGIT SERIAL NUMBER. SERIAL NUMBERS START AT 001 FOR THE FIRST ARTICLE AND PROCEED CONSECUTIVELY. USE MINIMUM 0.12" HIGH CHARACTERS, UNLESS THE SIZE OF THE PART DICTATES SMALLER CHARACTERS. EXAMPLE: DXXXXXX-VY, TYPE-XX, S/N XXX

6. APPROXIMATE WEIGHT = 0.547 LB.
 7. MACHINE ALL SURFACES TO REMOVE OXIDES AND MILL FINISH. USE OF ABRASIVE REMOVAL TECHNIQUES IS NOT ALLOWED.
 8. ALL PARTS SHALL BE MANUFACTURED IN ACCORDANCE WITH LIGO SPECIFICATION E0900364.

REV.	DATE	DCN #	DRAWING TREE #
v1	7 OCT 2010	E1000563	E1000474
v2	16 FEB 2011	E1000563	E1000474
v3	28 FEB 2011	E1000563	E1000474

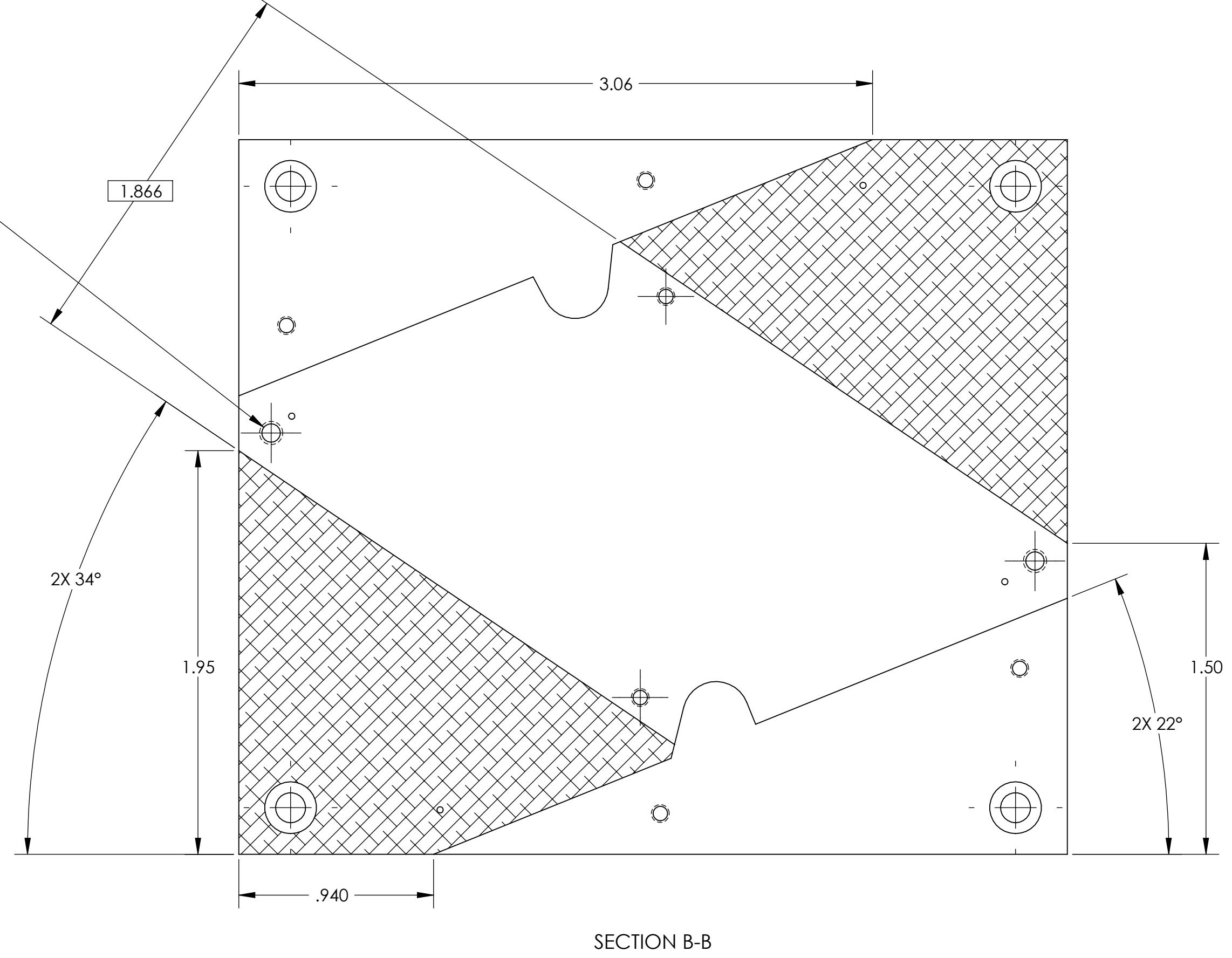
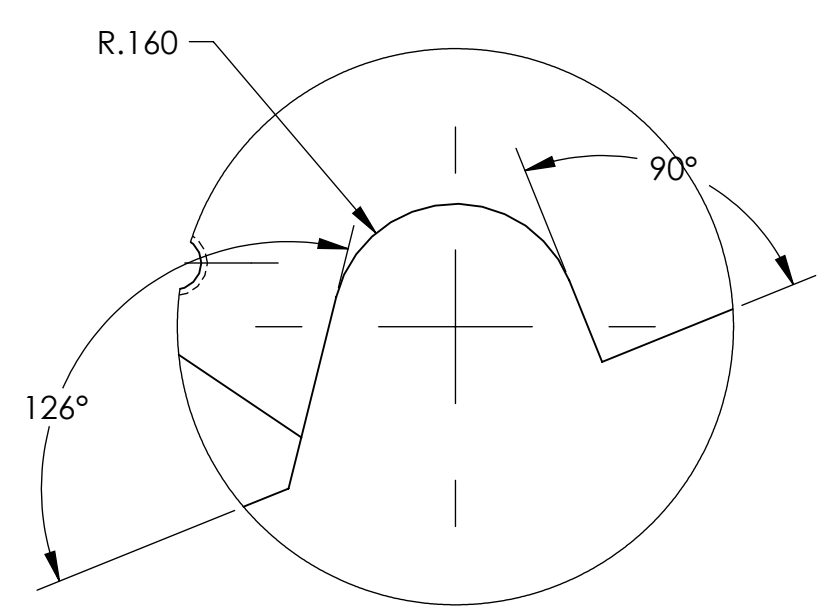
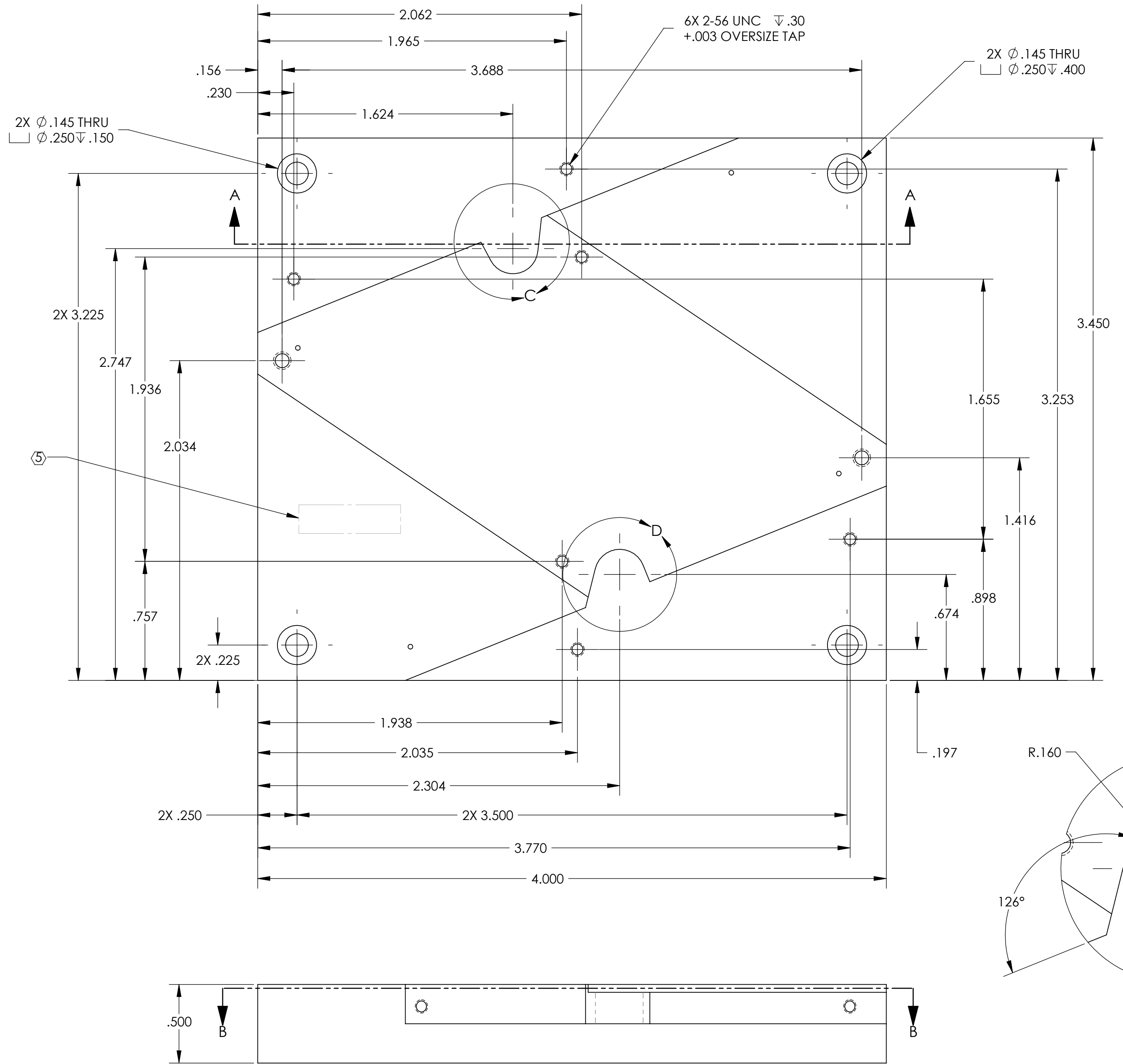
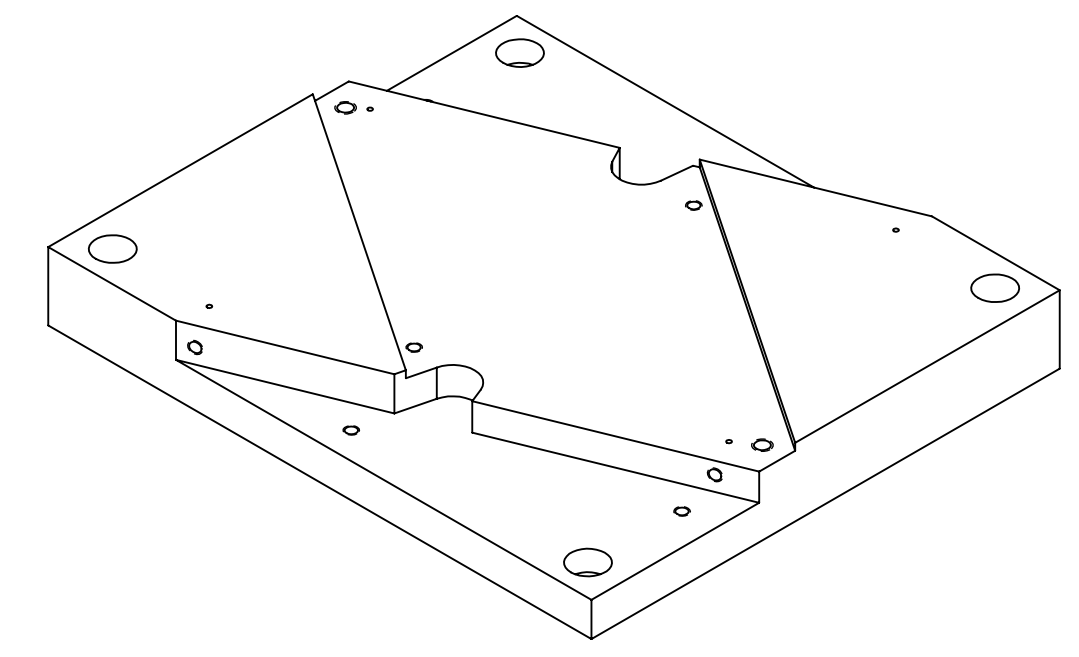
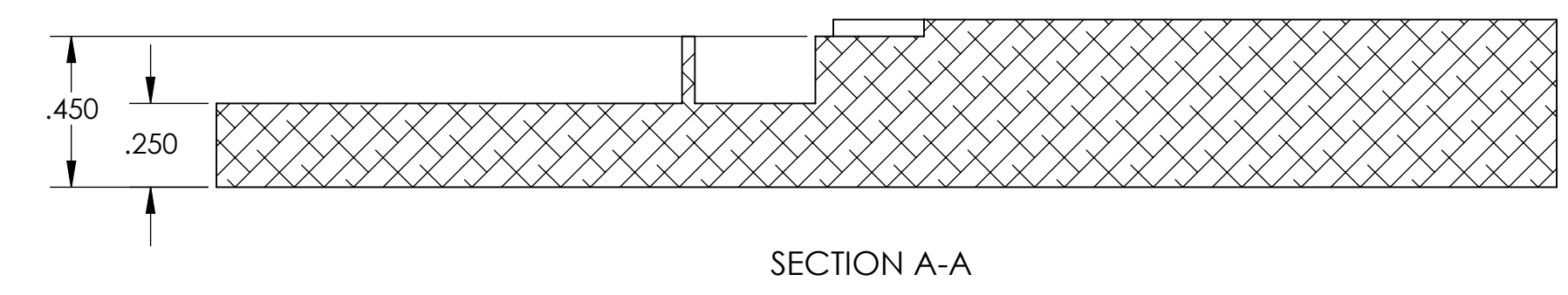
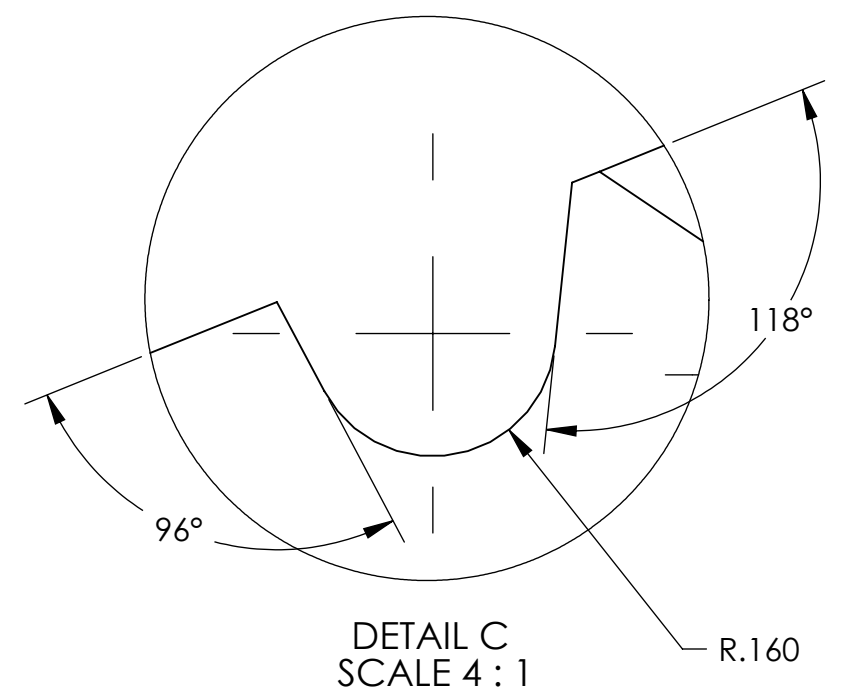

NOTES AND TOLERANCES: (UNLESS OTHERWISE SPECIFIED)	
1. INTERPRET DRAWING PER ASME Y14.5-1994.	
2. REMOVE ALL SHARP EDGES, R.02 MIN.	
3. DO NOT SCALE FROM DRAWING.	
4. ALL MACHINING FLUIDS MUST BE FULLY SYNTHETIC, FULLY WATER SOLUBLE AND FREE OF SULFUR, SILICONE, AND CHLORINE.	
DIMENSIONS ARE IN INCHES	
TOLERANCES: .XX \pm .01 .XXX \pm .005	
ANGULAR \pm 0.5°	
MATERIAL	6061-T6 Al
FINISH	63 μ inch

CALIFORNIA INSTITUTE OF TECHNOLOGY MASSACHUSETTS INSTITUTE OF TECHNOLOGY	
SYSTEM	ADVANCED LIGO
SUB-SYSTEM	AOS
NEXT ASSY	D0900615

PART NAME				PRISM MOUNT BASE_RH			
DESIGNER	TQ. NGUYEN	16 JUL 2010	SIZE	DWG. NO.	REV.		
DRAFTER	TQ. NGUYEN	20 AUG 2010	D	D0900620	v3		
CHECKER	M. SMITH		SCALE: 2:1	PROJECTION:	SHEET 1 OF 2		
APPROVAL	D. COYNE						

D0900620.dwg, AOS, D0900615, Part PDM REV: X-015, DRAWING PDM REV: X-023

8

7

6

5

4

3

2

1

H

H

G

G

F

F

E

E

D

D

C

C

B

B

A

A

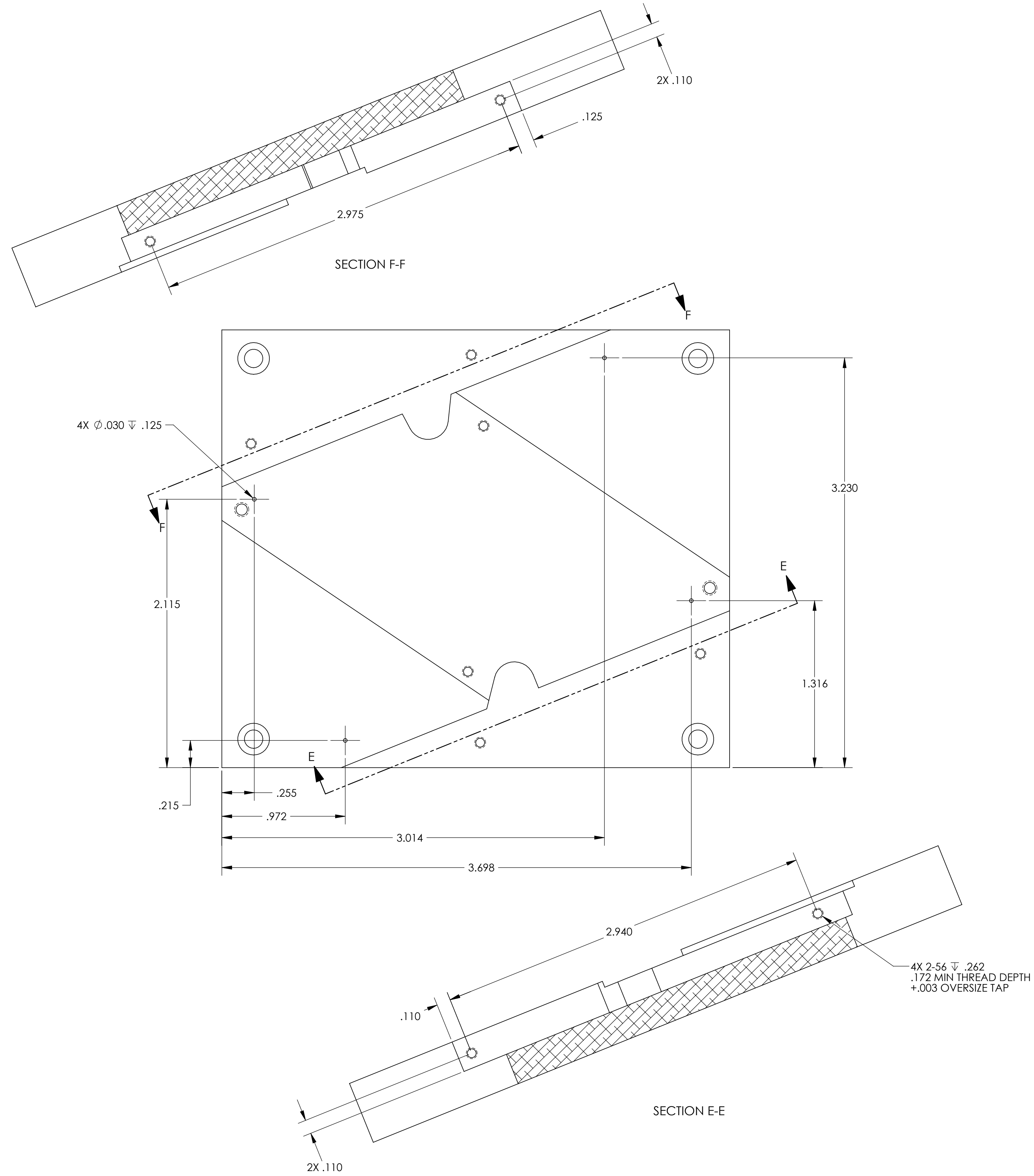

		CALIFORNIA INSTITUTE OF TECHNOLOGY MASSACHUSETTS INSTITUTE OF TECHNOLOGY	
SIZE	DWG. NO.	REV.	
D	D0900620	v3	
SCALE: 2:1	PROJECTION:	SHEET 2 OF 2	

8

7

6

5

4

3

2

1

D:\090620_d\UGO_A05E_D0900615_Faraday Isolator Prism Mount Base RH_PART_PDM_REV.X-015_DRAWING_PDM_REV.X-023