

D0900440\_AdlIGO\_AOS\_D0900623\_TFP Polarizer Plate Assy, PART PDM REV: X-095, DRAWING PDM REV: X-013

REV.	DATE	DCN #	DRAWING TREE #
v1	08 OCT 2010	E1000563	
v4	21 SEP 2012	E1000563	
-	-	-	

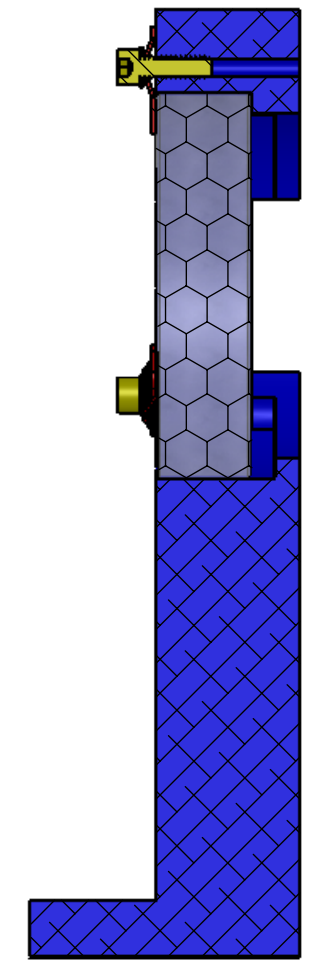
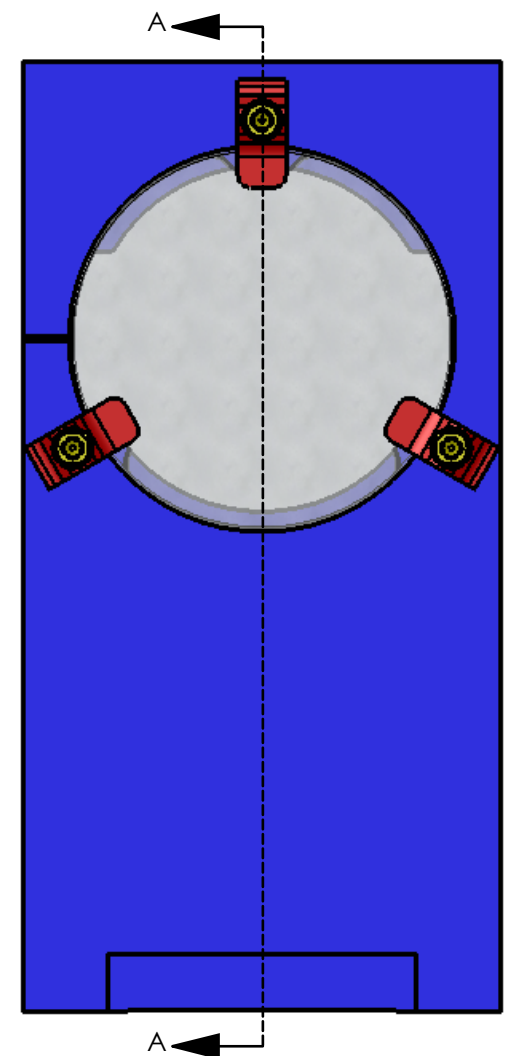
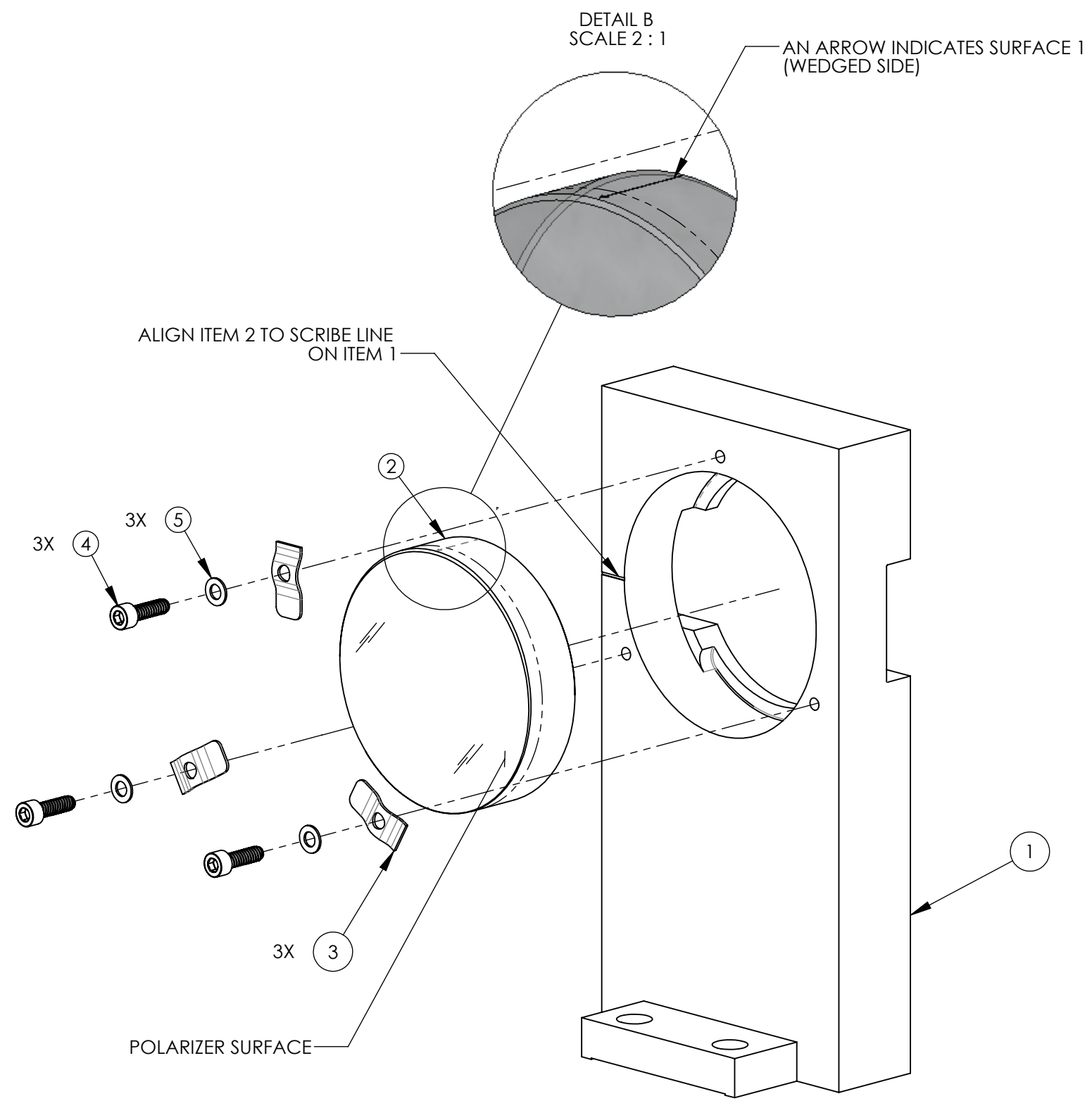

SECTION A-A

EXPLODED VIEW

ITEM NO.	PART NUMBER	DESCRIPTION	MATERIAL	REQ
5	WF-04	WASHER, FLAT, #4 (NAS 620-C4L OR EQUIVALENT)	300 SSSL	3
4	92200A108	Head Cap Screw 300 Series SS, 4-40 Thrd, 3/8" Length, MS 16995-10	18-8 SSSL	3
3	D1001919	BEAM DUMP MOUNTING CLAMP	304 SSSL	3
2	D1201320	ALIGO, OFI, THIN FILM POLARIZER	FUSED SILICA	1
1	D0900439	TFP POLARIZER PLATE	6061-T6 Al	1

PARTS LIST		PART NAME	
TFP POLARIZER PLATE ASSY		TFP POLARIZER PLATE ASSY	
DESIGNER	MRUIZ	DATE	08/31/2010
DRAWER		SIZE	B
CHECKER		DWG. NO.	D0900440
APPROVAL		REV.	v4
SCALE: 1:1		PROJECTION:	
		SHEET 1 OF 1	

**NOTES AND TOLERANCES: (UNLESS OTHERWISE SPECIFIED)**

1. INTERPRET DRAWING PER ASME Y14.5-1994.  
 2. REMOVE ALL SHARP EDGES, R.02 MIN.  
 3. DO NOT SCALE FROM DRAWING.  
 4. ALL MACHINING FLUIDS MUST BE FULLY SYNTHETIC, FULLY WATER SOLUBLE AND FREE OF SULFUR, SILICONE, AND CHLORINE.

DIMENSIONS ARE IN  
 TOLERANCES:  
 .XX ±  
 .XXX ±  
 ANGULAR ± °

MATERIAL: -- FINISH: -- μinch

**LIGO** CALIFORNIA INSTITUTE OF TECHNOLOGY  
 MASSACHUSETTS INSTITUTE OF TECHNOLOGY

SYSTEM: ADVANCED LIGO SUB-SYSTEM: AOS

NEXT ASSY: D0900623