

NOTES: (UNLESS OTHERWISE SPECIFIED)

1. DIMENSIONS IN INCHES

2. ALL MACHINING FLUIDS SHALL BE WATER SOLUBLE AND FREE OF SULFUR, CHLORINE AND SILICONE, SUCH AS CINCINNATI MILACRON'S CIMTECH 410 (STAINLESS STEEL)

REV.	DATE	DCN #	DRAWING TREE #
A	24th JUNE 2004	E040303-00	
v1	22 APRIL 2009	E0900107-v1	

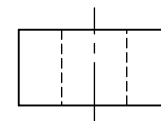
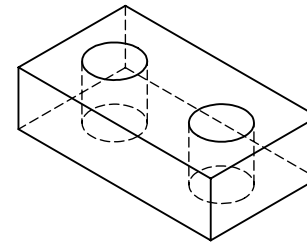
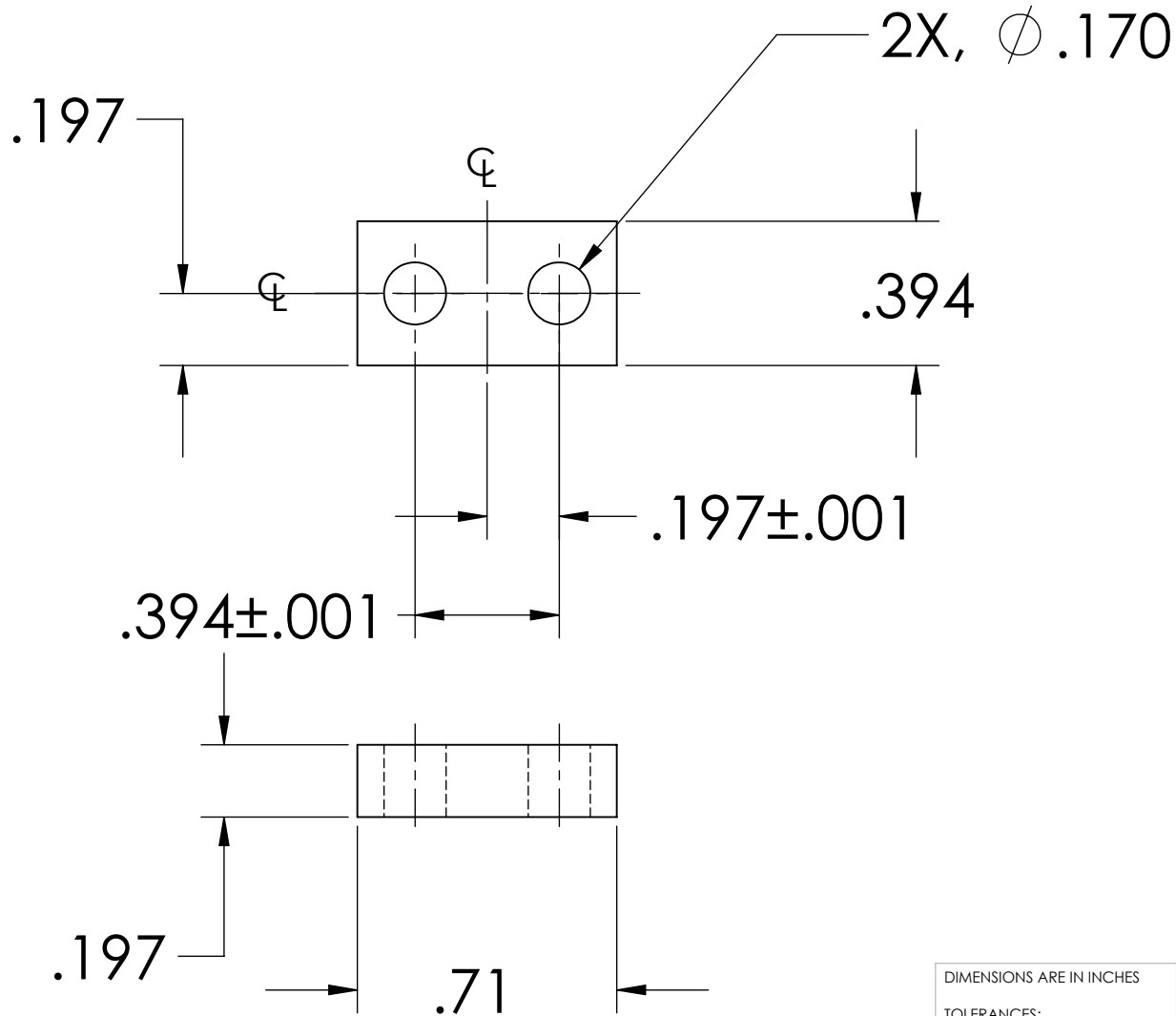

DIMENSIONS ARE IN INCHES

TOLERANCES:
 .XX ±0.01
 .XXX ±0.005
 ANGULAR ±1°

MATERIAL
 302, 304 OR 316 STAINLESS

FINISH

NAME	DATE
CIT	02/02

COMMENTS:

		CALIFORNIA INSTITUTE OF TECHNOLOGY MASSACHUSETTS INSTITUTE OF TECHNOLOGY	
SYSTEM	ADVANCED LIGO		
SUB-SYSTEM	SUS		
NEXT ASSY	LIBRARY OF CLAMPS		
PART NAME LOWER BLADE CLAMP LOWER SIDE			
SIZE	DWG. NO.	REV.	
A	D020308	v1	
SCALE: NTS			SHEET 1 OF 1