

REV	DATE	APPROVAL	DESCRIPTION
00	10/27/2008	A. STEIN	PROTOTYPE RELEASE.

D

D

C

C

B

B

A

A

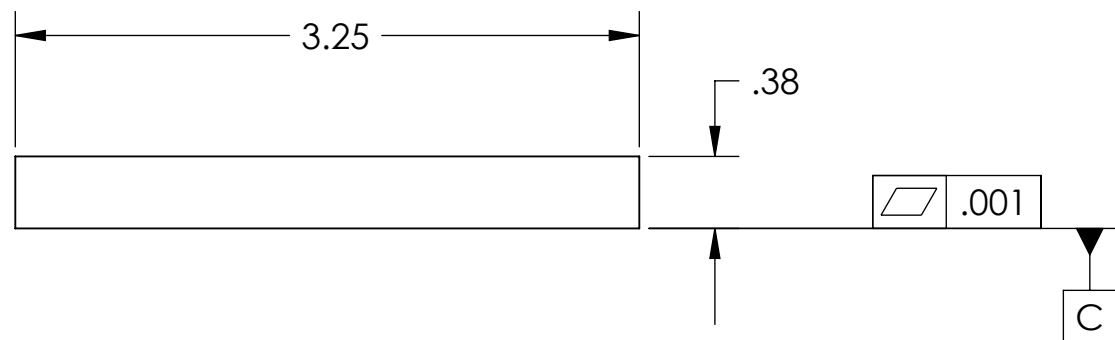
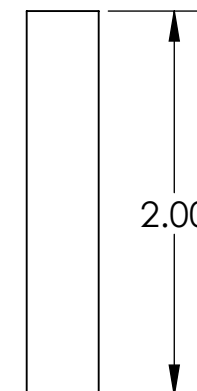
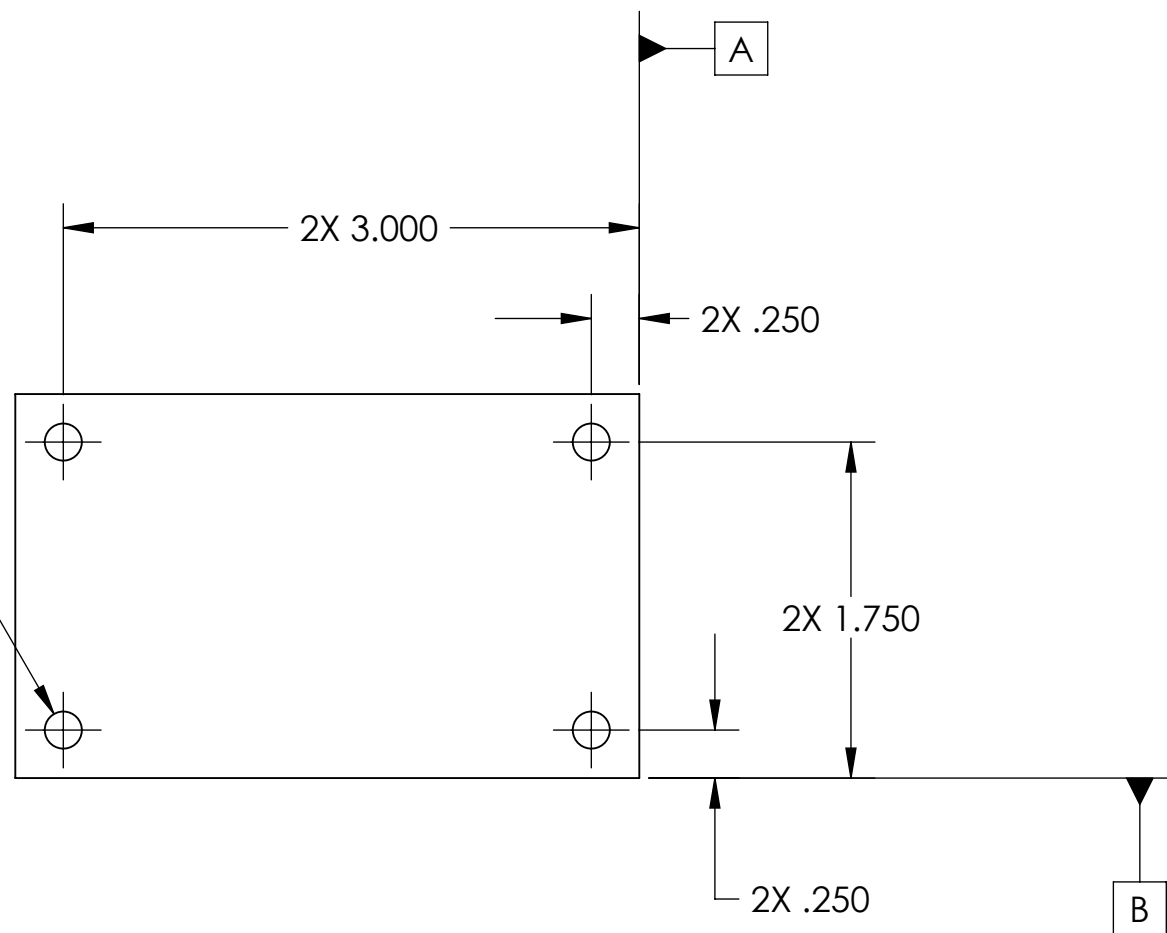
4X ϕ .194 THRU ALL

NOTES: (UNLESS OTHERWISE SPECIFIED)

- DO NOT SCALE FROM DRAWING.
- REMOVE ALL SHARP EDGES. LEAVE .005 X 45° MIN CHAMFER, OR .005 MIN RADIUS.
- ALL MACHINING FLUIDS MUST BE WATER SOLUBLE AND FREE OF SULFUR, CHLORINE AND SILICONE. E.G., MILACRON CIMTECH 410.
- CLEAN THOROUGHLY TO REMOVE ALL OIL, DIRT, AND CHIPS.

DIMENSIONS ARE IN INCHES

TOLERANCES:
.XX ± 0.015
.XXX ± 0.005

ANGULAR ± 0.5 °

MATERIAL
6061-T6FINISH
NONE

	NAME	DATE
DRAWN	A. STEIN	10/27/2008
CHECKED	-	-
APPROVED	-	-

CALIFORNIA INSTITUTE OF TECHNOLOGY
MASSACHUSETTS INSTITUTE OF TECHNOLOGY
IGR, GLASGOW UNIVERSITY GEO 600 GROUP

SYSTEM
ADVANCED LIGOSUB-SYSTEM
SEINEXT ASSY
D080676PART NAME
ADE SENSOR TARGET

SIZE	DWG. NO.	REV
B	D080675	00

SCALE: 1:1 PROJECTION: SHEET 1 OF 1

8

7

6

5

4

3

2

1

8

7

6

5

4

3

2

1