

REV.	DATE	DCN #	DRAWING TREE #
v1	11th Nov 2008	E080530-v1	
v2	2-20-09	LIGO-E0900046-v1	

ETCH OR GRIND REGISTRATION MARKS
 0.25mm ±0.05mm WIDE x
 80mm ±3mm LONG MINIMUM LEGIBLE
 DEPTH LINE ALONG ϕ , CENTERED
 BETWEEN SURFACES 'S1' AND 'S2', PARALLEL
 TO THE CYLINDRICAL AXIS
 (DEFINED BY DATUM FEATURE -A-)
 WITHIN ±0.1mm AND
 180° FROM SCRIBE LINE AT LOCATION OF
 MINIMUM PART THICKNESS.

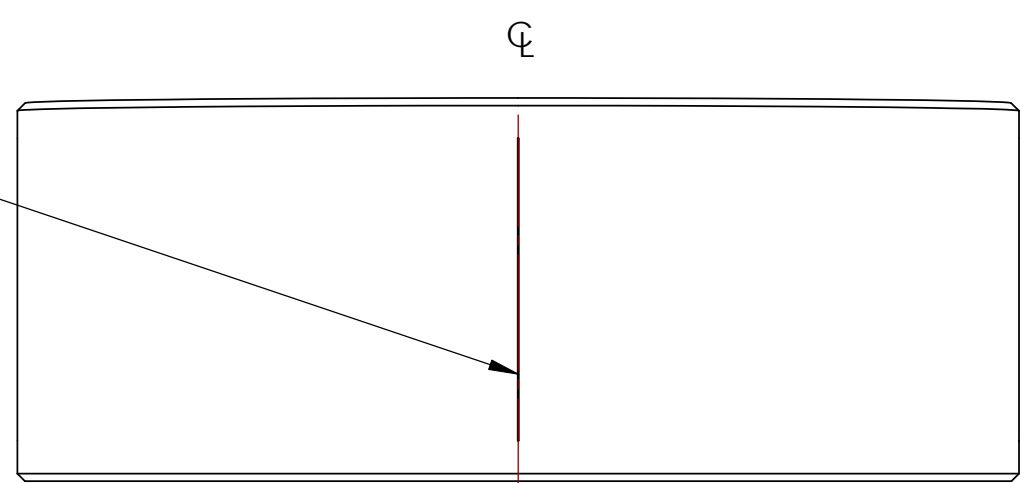

TOP VIEW

ETCH OR GRIND REGISTRATION MARKS
 0.25mm ±0.05mm WIDE x
 80mm ±3mm LONG MINIMUM LEGIBLE
 DEPTH LINE ALONG ϕ , CENTERED
 BETWEEN SURFACES 'S1' AND 'S2', PARALLEL
 TO THE CYLINDRICAL AXIS
 (DEFINED BY DATUM FEATURE -A-)
 WITHIN ±0.1mm AND
 90° FROM SCRIBE LINE AT LOCATION OF
 MINIMUM PART THICKNESS.

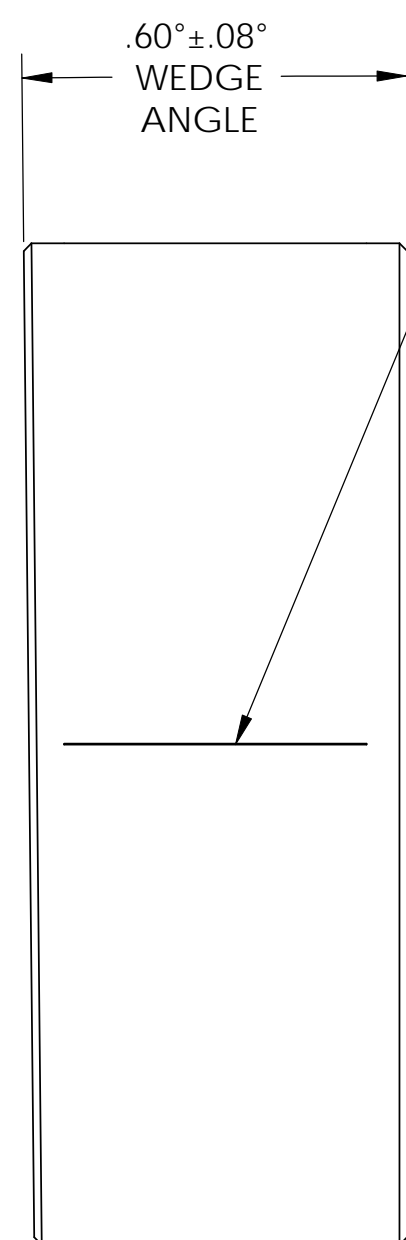

60° ±0.08°
 WEDGE
 ANGLE

ETCH OR GRIND REGISTRATION MARKS
 0.25mm ±0.05mm WIDE x
 80mm ±3mm LONG MINIMUM LEGIBLE
 DEPTH LINE ALONG ϕ , CENTERED
 BETWEEN SURFACES 'S1' AND 'S2' AT
 LOCATION OF MINIMUM PART THICKNESS
 WITHIN ±1° CLOCKING ANGLE
 (WITH RESPECT TO DATUM FEATURE -A-),
 AND PARALLEL TO THE CYLINDRICAL AXIS
 (DEFINED BY DATUM FEATURE -A-)
 WITHIN ±0.1mm, WITH ARROW POINTING
 TO SURFACE 'S1'.

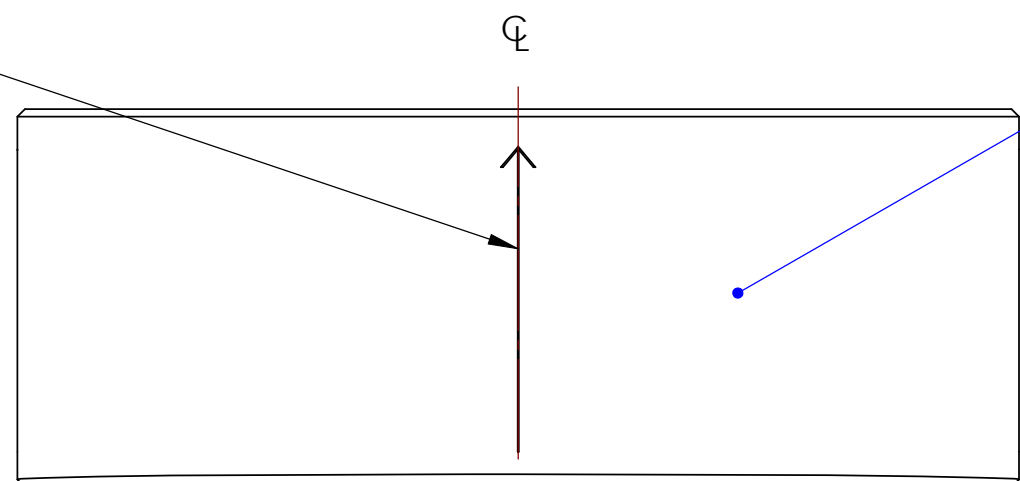

BOTTOM VIEW

POLISH SURFACE 'S1'
 (SEE NOTE 4)

ϕ 265.00 ±0.25
0.1
0.18 B

BARREL SIDE AND BEVEL POLISH
 (SEE NOTE 3).

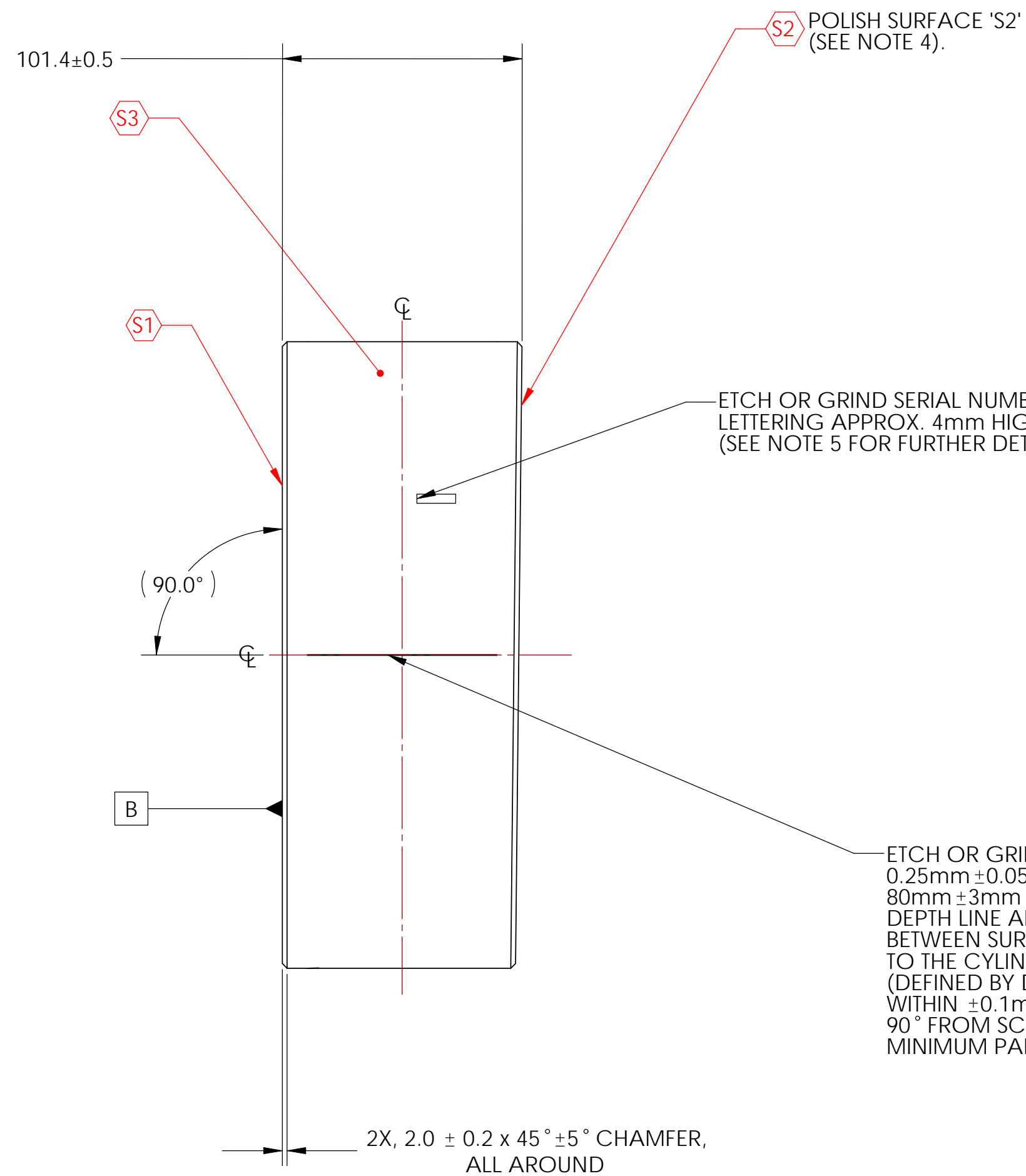

ETCH OR GRIND SERIAL NUMBER, APPROX. WHERE SHOWN,
 LETTERING APPROX. 4mm HIGH
 (SEE NOTE 5 FOR FURTHER DETAILS)

ETCH OR GRIND REGISTRATION MARKS
 0.25mm ±0.05mm WIDE x
 80mm ±3mm LONG MINIMUM LEGIBLE
 DEPTH LINE ALONG ϕ , CENTERED
 BETWEEN SURFACES 'S1' AND 'S2', PARALLEL
 TO THE CYLINDRICAL AXIS
 (DEFINED BY DATUM FEATURE -A-)
 WITHIN ±0.1mm AND
 90° FROM SCRIBE LINE AT LOCATION OF
 MINIMUM PART THICKNESS.

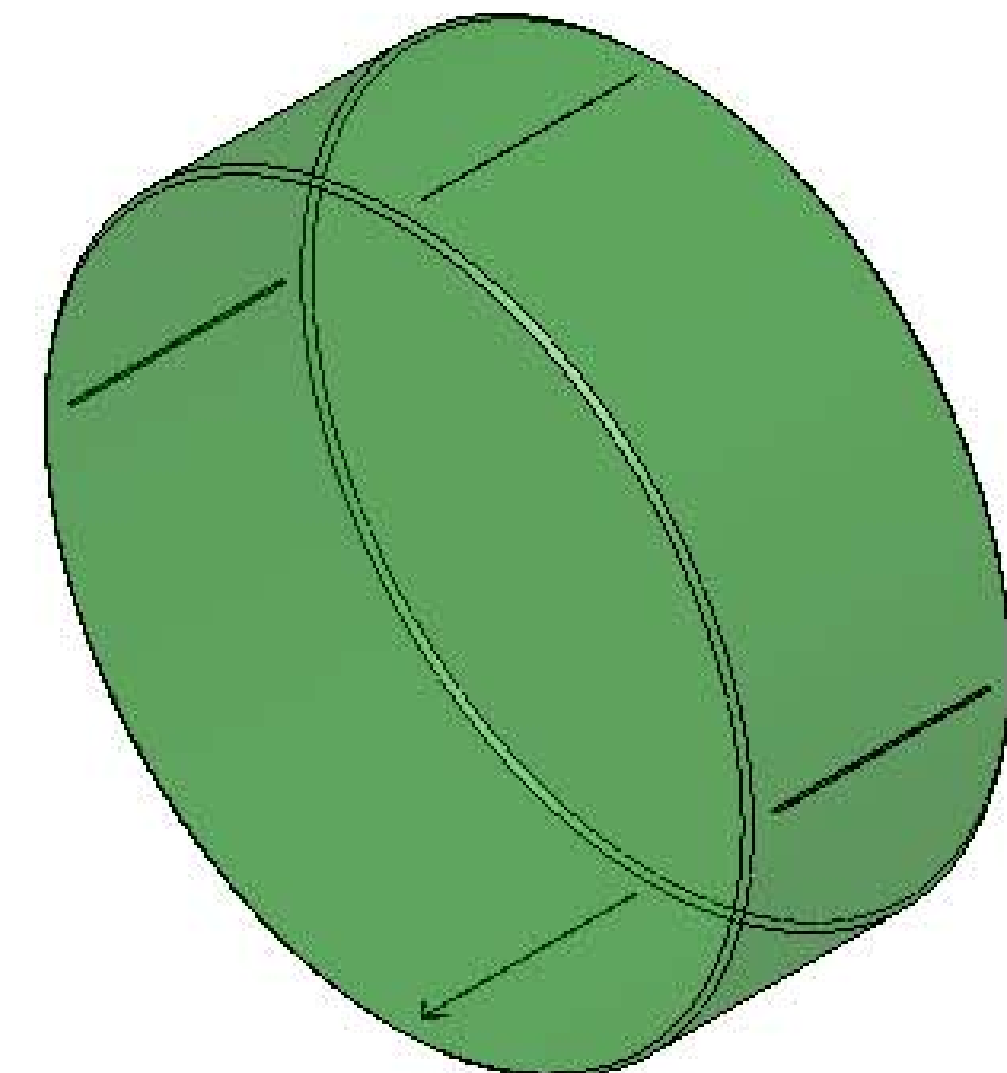

MANUFACTURING NOTES:			
1.	DO NOT SCALE FROM DRAWING.		
2.	INTERPRET DRAWING AS PER ANSI Y14.5M 1994.		
3.	BARREL SIDE AND BEVEL POLISH PER E080518-v2.		
4.	FINISH SURFACES 'S1' AND 'S2' AS PER E080518-v2.		
5.	REFER TO E080518-v2 FOR MORE INFORMATION ON SERIAL NUMBER.		
PARTS LIST			
NOTES: (UNLESS OTHERWISE SPECIFIED)			
DIMENSIONS ARE IN MILLIMETERS (mm)			
TOLERANCES:			
X ± 0.1			
XX ± 0.05			
ANGULAR ± 0.1°			
MATERIAL:			
REF E080041-v1			
FINISH:	SEE NOTES	PART NAME:	SR3 SUBSTRATE
DRAWN:	C. TORRE	DATE:	11-Nov-08
CHECKED:	D. COYNE	DATE:	20-Nov-08
CHECKED:	G. GUARACINO	DATE:	19-Nov-08
APPROVED:	D. COYNE	DATE:	17-Dec-08
		SCALE:	1:2
		PROJECTION:	1
		DWG. NO.:	D080664
		REV.:	v2
		SHEET:	1 OF 1