

REV.	DATE	DCN #	DRAWING TREE #
v1	11th Nov 2008	E080530-v1	
v2	20th Feb 2009	E0900046-v1	
v3	2nd Mar 2009	E0900062-v1	

ETCH OR GRIND REGISTRATION MARKS  
 0.25mm ± 0.05mm WIDE x  
 45mm ± 3mm LONG MINIMUM LEGIBLE  
 DEPTH LINE ALONG  $\phi$ , CENTERED  
 BETWEEN SURFACES 'S1' AND 'S2', PARALLEL  
 TO THE CYLINDRICAL AXIS  
 (DEFINED BY DATUM FEATURE -A-)  
 WITHIN ±0.1mm AND  
 90° FROM SCRIBE LINE AT LOCATION OF  
 MINIMUM PART THICKNESS.

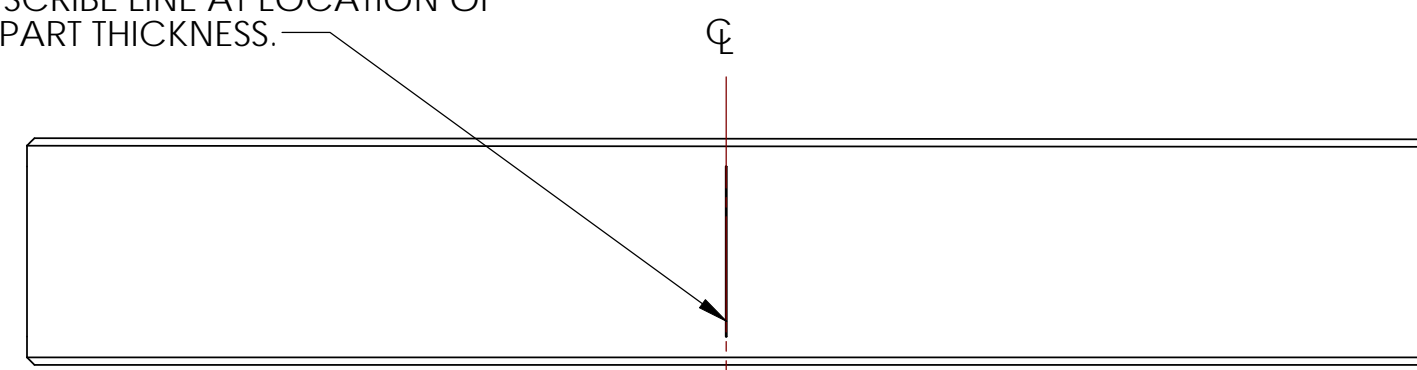

TOP VIEW

ETCH OR GRIND REGISTRATION MARKS  
 0.25mm ± 0.05mm WIDE x  
 45mm ± 3mm LONG MINIMUM LEGIBLE  
 DEPTH LINE ALONG  $\phi$ , CENTERED  
 BETWEEN SURFACES 'S1' AND 'S2', PARALLEL  
 TO THE CYLINDRICAL AXIS  
 (DEFINED BY DATUM FEATURE -A-)  
 WITHIN ±0.1mm AND  
 180° FROM SCRIBE LINE AT LOCATION OF  
 MINIMUM PART THICKNESS.

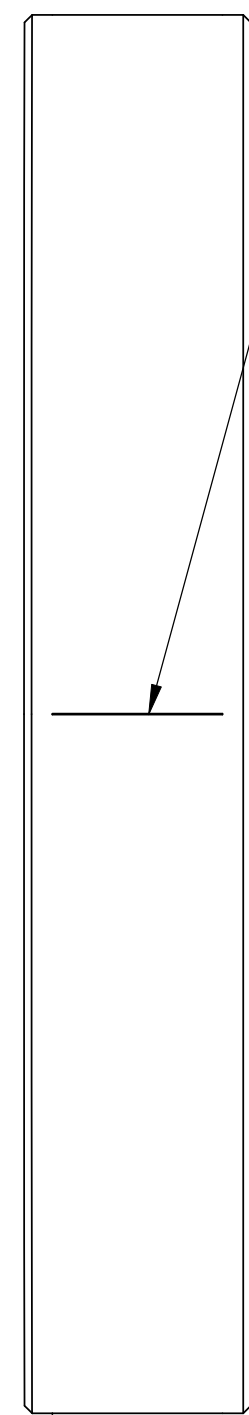

S1

A

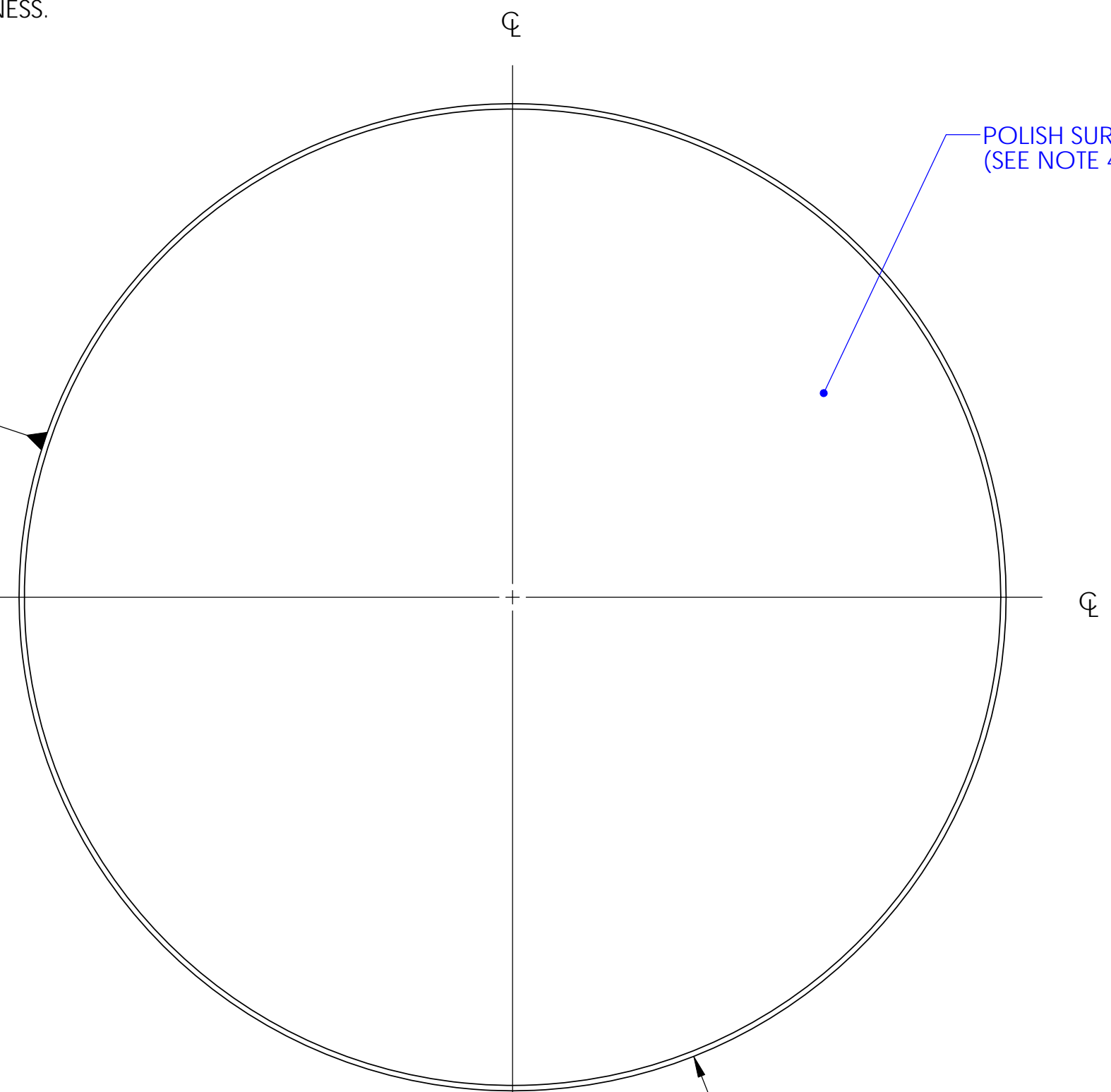

POLISH SURFACE 'S1'  
 (SEE NOTE 4)

S3

S1

S2  
 POLISH SURFACE 'S2'  
 (SEE NOTE 4).

ETCH OR GRIND SERIAL NUMBER, APPROX. WHERE SHOWN,  
 LETTERING APPROX. 4mm HIGH  
 (SEE NOTE 5 FOR MORE DETAILS.)

(90.0°)

B

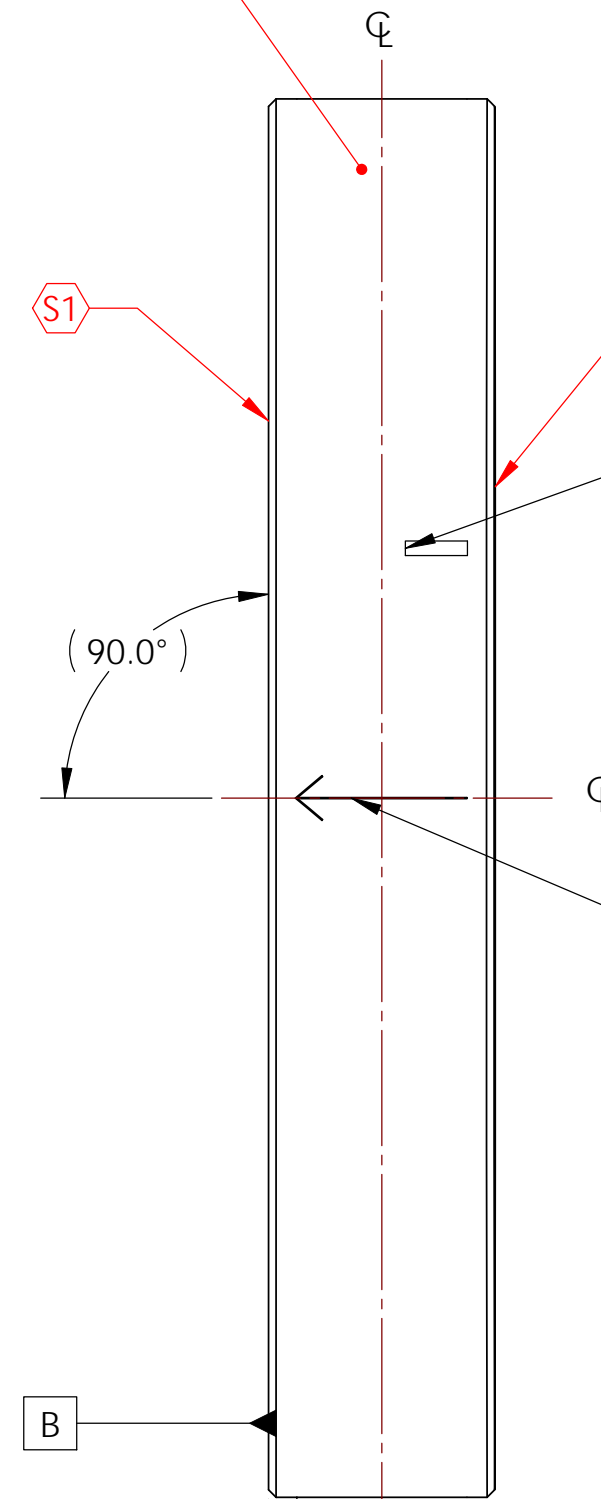

2X, 2.0 ± 0.2 x 45° ± 5° CHAMFER,  
 ALL AROUND

ETCH OR GRIND REGISTRATION MARKS  
 0.25mm ± 0.05mm WIDE x 45mm ± 3mm LONG  
 MINIMUM LEGIBLE DEPTH LINE ALONG  $\phi$ , CENTERED  
 BETWEEN SURFACES 'S1' AND 'S2' AT  
 LOCATION OF MINIMUM PART THICKNESS WITHIN  
 ± 5° CLOCKING ANGLE  
 (WITH RESPECT TO DATUM FEATURE -A-),  
 AND PARALLEL TO THE CYLINDRICAL AXIS  
 (DEFINED BY DATUM FEATURE -A-)  
 WITHIN ±0.1mm, WITH ARROW POINTING  
 TO SURFACE 'S1'.

ETCH OR GRIND REGISTRATION MARKS  
 0.25mm ± 0.05mm WIDE x  
 45mm ± 3mm LONG MINIMUM LEGIBLE  
 DEPTH LINE ALONG  $\phi$ , CENTERED  
 BETWEEN SURFACES 'S1' AND 'S2', PARALLEL  
 TO THE CYLINDRICAL AXIS  
 (DEFINED BY DATUM FEATURE -A-)  
 WITHIN ±0.1mm AND  
 90° FROM SCRIBE LINE AT LOCATION OF  
 MINIMUM PART THICKNESS.

60.0 ± 0.5

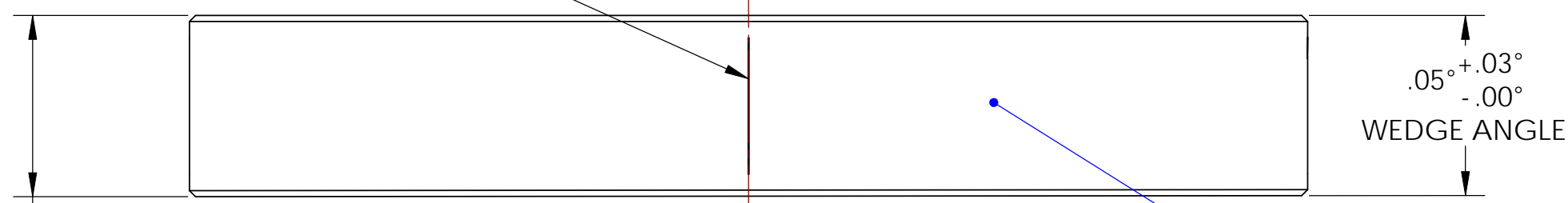

BOTTOM VIEW

BARREL SIDE AND BEVEL POLISH  
 (SEE NOTE 3)

$\phi$  370.00 ± 0.25  
 0.1  
 0.1 B

.05° +.03°  
 -.00°  
 WEDGE ANGLE

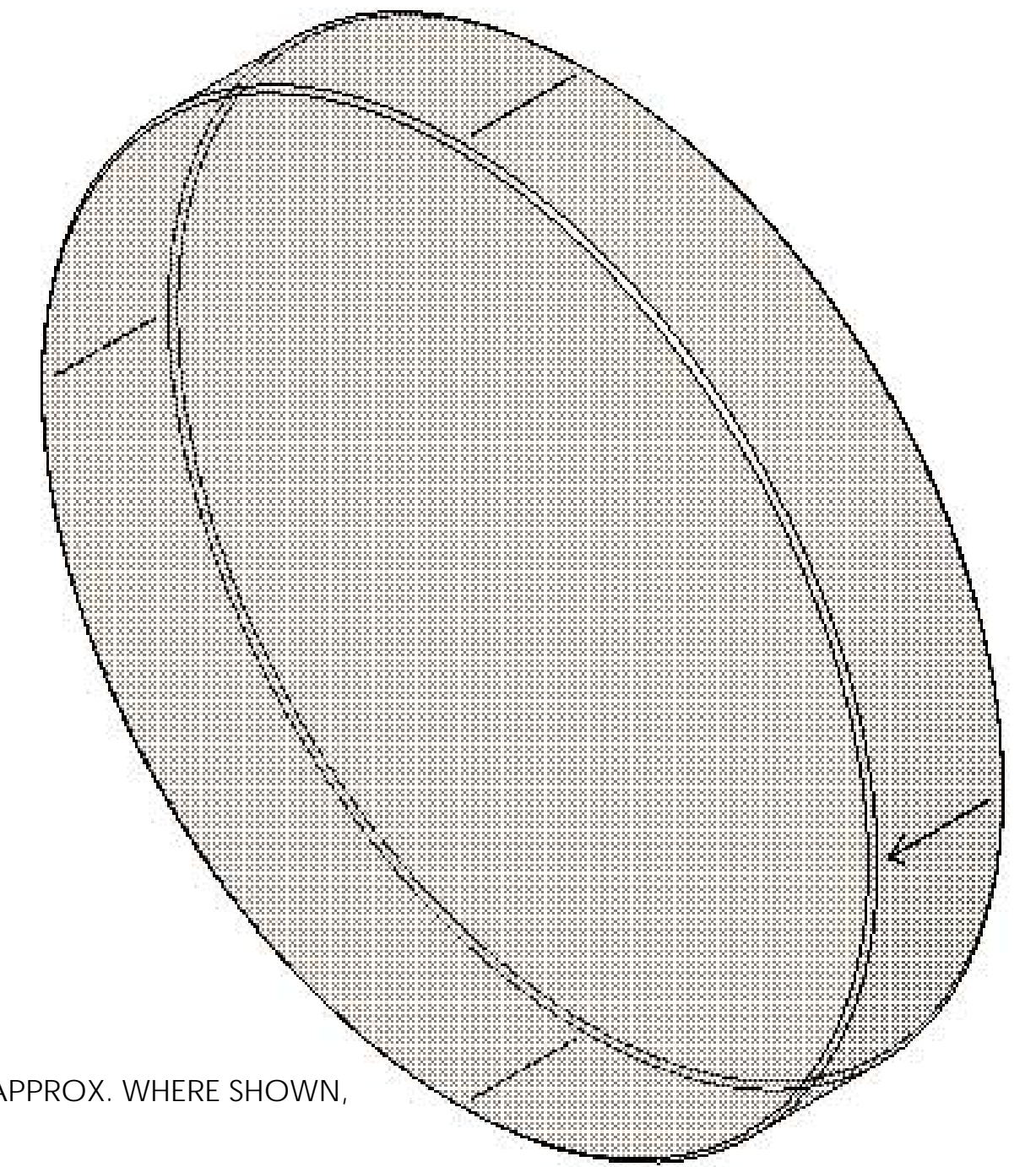

MANUFACTURING NOTES:

- DO NOT SCALE FROM DRAWING.
- INTERPRET DRAWING AS PER ANSI Y14.5M 1994.
- BARREL SIDE AND BEVEL POLISH PER E080515-v2.
- FINISH SURFACES 'S1' AND 'S2' AS PER E080515-v2.
- REFER TO E080515-v2 FOR MORE INFORMATION ON SERIAL NUMBER.

PARTS LIST	
NOTES: (UNLESS OTHERWISE SPECIFIED)	
DIMENSIONS ARE IN MILLIMETERS (mm)	
TOLERANCES	
X ± 0.1	ANGULAR ± 0.1°
XX ± 0.05	
MATERIAL	
REF E080045-v1	NEXT ASSY FOLDING MIRROR (FM)
FINISH SEE NOTES	
PART NAME (FM) SUBSTRATE	
DRAWN C. TORRE 11/11/08	SIZE DWG. NO. D080661
CHECKED J. BROWN 11/19/08	PROJECTION 1:2
CHECKED S. COYNE 11/19/08	SCALE: 1:2
APPROVED D. COYNE 11/19/08	SHEET 1 OF 1